

Conveyor components

STANDARD MACHINE ELEMENTS WORLDWIDE

elesa[®]

Conveyor components

ELESA conveyor components allow the creation of support structures for production lines in diverse industrial sectors, such as bottling, packaging and material handling. The vast ELESA range, already available on our website elesa.com. The side and central roller guides in polyethylene based (PE) technopolymer, are now available in many variants suitable for guiding products of different vertical dimensions. The range includes guides with spherical, cylindrical and round contact rollers for guiding products in cans, cardboard and glass respectively. Pins, screws and nuts in stainless steel guarantee a high resistance to corrosion.

The linear guide rails in polyethylene-based technopolymer (HMWPE or in AISI 304 stainless steel with technopolymer coating PEEK) guarantee a high resistance to wear and, due to the low friction coefficient, they are particularly suitable for handling high speeds.

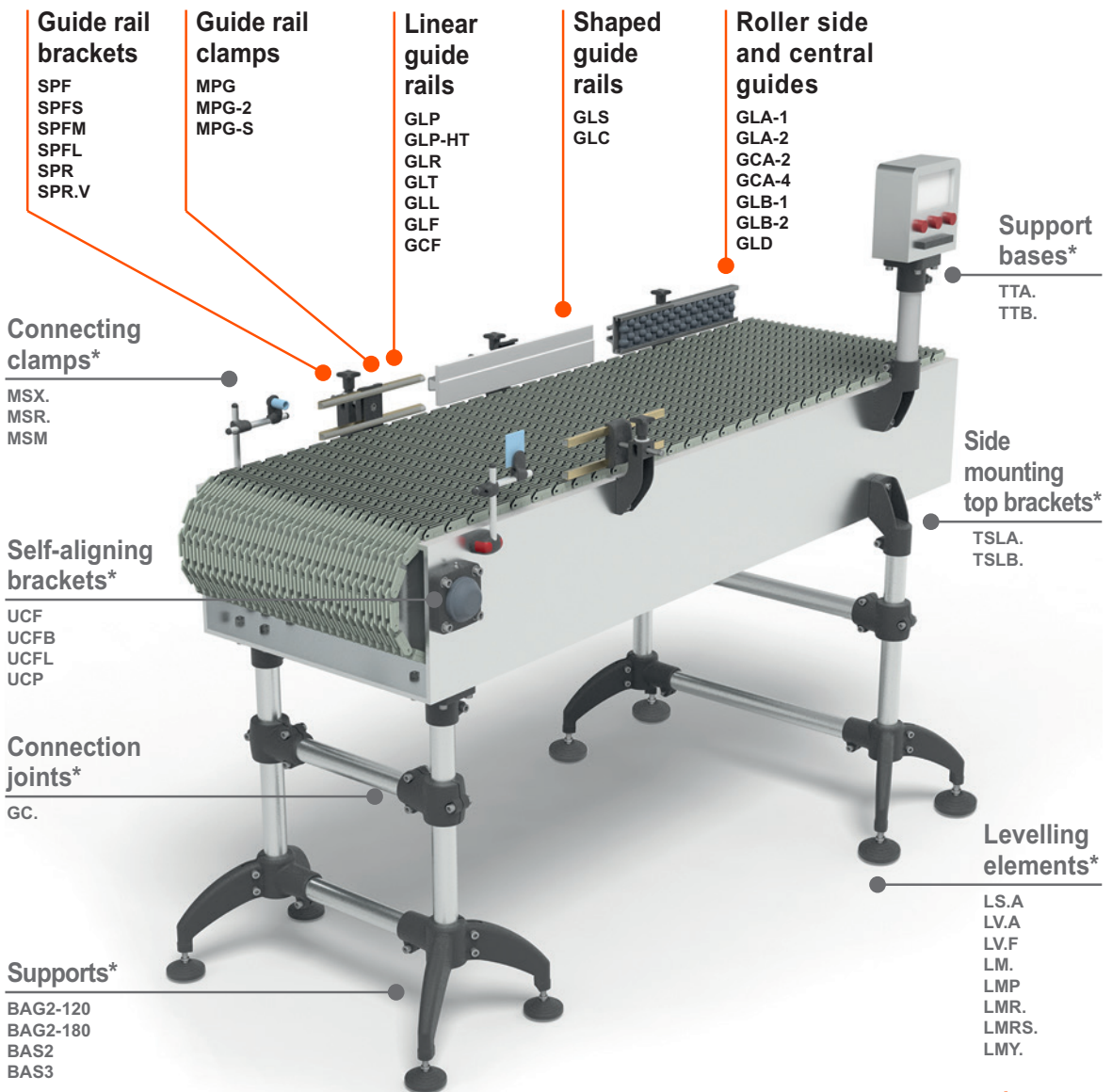

*Browse the full range on elesa.com

Conveyor components

GLA-1

Roller side guides
Technopolymer,
aluminium,
stainless steel



GLA-2

Roller side guides
Technopolymer,
aluminium,
stainless steel



GCA-2

Roller central guides
Technopolymer,
aluminium,
stainless steel



GCA-4

Roller central guides
Technopolymer,
aluminium,
stainless steel



TGL

End brackets for side guides
Technopolymer,
stainless steel



PGL-1

Separation block for side guides
for GLA-1,
Technopolymer,
stainless steel



PGL-2

Separation block for side guides
for GLA-2,
Technopolymer,
stainless steel



PGC-2

Separation block for central guides
for GCA-2,
Technopolymer,
stainless steel



PGC-4

Separation block for central guides
for GCA-4,
Technopolymer,
stainless steel



BDG

Connecting plate for guides
for GLA and GCA,
steel or stainless steel



GLD-AZ

Roller side guides
Technopolymer, steel



GLD-SST

Roller side guides
Technopolymer,
stainless steel



MPG-R-AZ

Guide rail clamps
for GLD-AZ side guides,
steel



MPG-R-SST

Guide rail clamps
for GLD-SST side guides,
stainless steel



GLB-1

Articulated side guides
Technopolymer,
stainless steel



Conveyor components

GLB-2

Articulated side guides

Technopolymer,
stainless steel



PRA-GLB

Profile for side guides

for GLB, stainless steel



PRB-GLB

Profile for side guides

for GLB, stainless steel



GLF

Linear guide rails

Flat profile,
stainless steel,
PEEK



GCF

Linear central guides

Flat profile,
stainless steel,
PEEK



GGLF

Side guide joint

for GLF and GCF,
Technopolymer



TGLF

End brackets for side guides

for GLF and GCF,
Technopolymer



GLP

Linear guide rails

Flat profile,
technopolymer,
stainless steel



GLP-HT

Linear guide rail, high temperature

Flat profile,
technopolymer,
stainless steel



GLR

Linear guide rail

Round profile R20,
technopolymer,
stainless steel



GLS

Linear guide rail

Shaped profile,
technopolymer,
stainless steel



GLT

Linear guide rail

Round profile R7,
technopolymer,
stainless steel



GLL

Linear guide rail

Label saver,
shaped profile,
technopolymer,
stainless steel



TGLT

End brackets for linear guide rails

Technopolymer



GLC

Wide guide rails

Shaped profile,
technopolymer

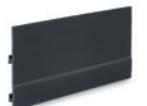

Conveyor components

MPG

Guide rail clamps
Technopolymer



MPG-P

Guide fixing pins
Stainless steel



MPG-2

Guide rail clamps
Technopolymer and stainless steel



MPG-S

Guide rail clamps
Technopolymer and stainless steel



MPG-V

Hammer head screw
For GLA, GCA, PRA and PRB guides, steel or stainless steel



SPF.

Guide rail brackets
for linear positioning, technopolymer



SPFS

Short guide rail brackets
for linear positioning, technopolymer



SPFM

Medium guide rail brackets
for linear positioning, technopolymer



SPFL

Long guide rail brackets
for linear positioning, technopolymer



DSG

Guide rail brackets spacer
Technopolymer



SPR.

Guide rail brackets
for linear and angular positioning, technopolymer



SPR.V

Guide rail brackets
for linear and angular positioning, technopolymer



PROFILE

Anodised aluminium, natural colour, matte finish.

PINS SUPPORT

Acetal resin based (POM) technopolymer, white colour.

PINS

AISI 304 stainless steel.

ROLLERS

Polyethylene based (PE) technopolymer, grey colour.

STANDARD EXECUTIONS

- **GLA-1-RS:** with shaped rollers, spherical contact.
- **GLA-1-RC:** with cylindrical rollers.
- **GLA-1-RT:** with shaped rollers, cylindrical contact.

FEATURES AND APPLICATIONS

GLA-1 side guides are self-supporting structures for the side guide of products with limited vertical dimensions on conveyor belts (Fig.1).

Depending on the product to transport, it is recommended to use:

- GLA-1-RS: for the guide of products in cans or in plastic containers;
- GLA-1-RC: for the guide of cardboard products, for a greater fluency;
- GLA-1-RT: for the guide of glass products, in case of accidental breakage they facilitate the expulsion of debris.

Supplied assembled in bars of 1440 or 3000 mm length.

SPECIAL EXECUTIONS ON REQUEST

- Side guides with rollers in different colours.
- Side guides with pins in acetal resin based (POM) technopolymer.

ACCESSORIES ON REQUEST

- BDG: zinc-plated steel connecting bar for guides.
- TGL: closing cap for guides.
- PGL-1: separation block for side guide.
- MPG-P: assembly pin.
- MPG-V: zinc-plated steel hammer head screw.

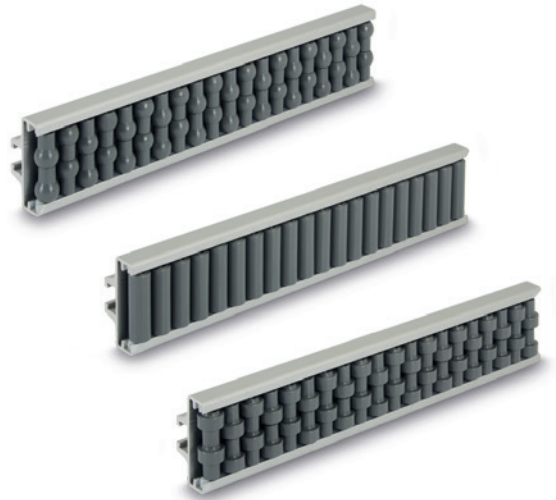
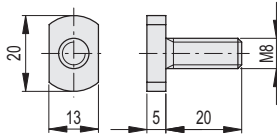
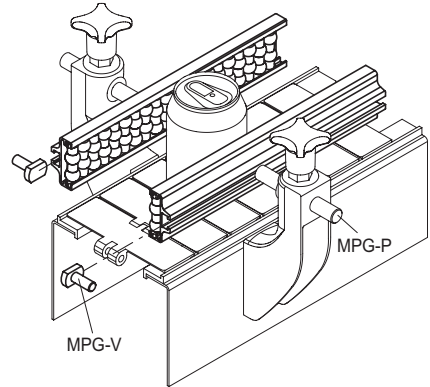
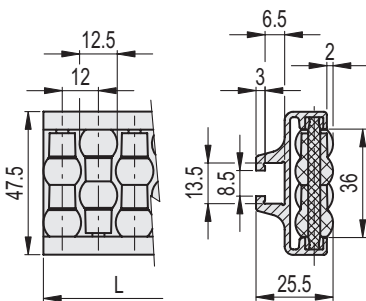

Fig.1



GLA-1-RS



GLA-1-RC

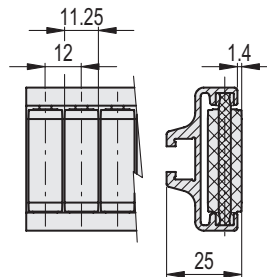

GLA-1-RT

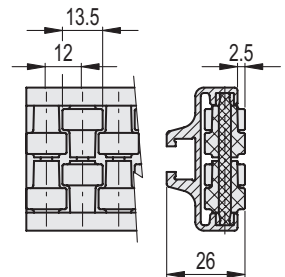

GLA-1-RS

Code	Description	L	⚖
419104	GLA-1-RS-48-1440	1440	1630
419101	GLA-1-RS-48-3000	3000	3400

GLA-1-RC

Code	Description	L	⚖
419105	GLA-1-RC-48-1440	1440	1630
419102	GLA-1-RC-48-3000	3000	3400

GLA-1-RT

Code	Description	L	⚖
419106	GLA-1-RT-48-1440	1440	1630
419103	GLA-1-RT-48-3000	3000	3400



PROFILE

Anodised aluminium, natural colour, matte finish.

PINS SUPPORT

Acetal resin based (POM) technopolymer, white colour.

PINS

AISI 304 stainless steel.

ROLLERS

Polyethylene based (PE) technopolymer, grey colour.

STANDARD EXECUTIONS

- **GLA-2-RS:** with shaped rollers, spherical contact.
- **GLA-2-RC:** with cylindrical rollers.
- **GLA-2-RT:** with shaped rollers, cylindrical contact.

FEATURES AND APPLICATIONS

GLA-2 side guides are self-supporting structures for the side guide of products with important vertical dimensions on conveyor belts (Fig.1). Depending on the product to transport, it is recommended to use:

- GLA-2-RS: for the guide of products in cans or in plastic containers;
- GLA-2-RC: for the guide of cardboard products, for a greater fluency;
- GLA-2-RT: for the guide of glass products, in case of accidental breakage they facilitate the expulsion of debris.

Supplied assembled in bars of 1440 or 3000 mm length.

SPECIAL EXECUTIONS ON REQUEST

- Side guides with rollers in different colours.
- Side guides with pins in acetal resin based (POM) technopolymer.

ACCESSORIES ON REQUEST

- BDG: zinc-plated steel connecting bar for guides.
- TGL: closing cap for guides.
- PGL-2: separation block for side guide.
- MPG-P: assembly pin.
- MPG-V: zinc-plated steel hammer head screw. (see GLA-1).

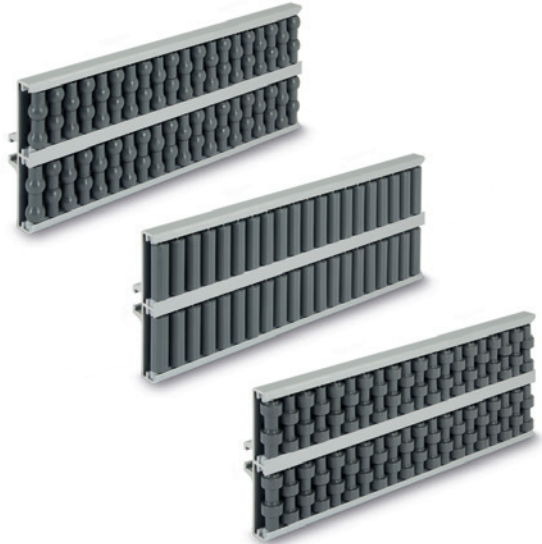
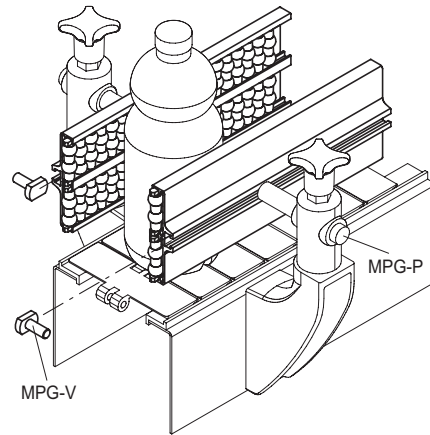
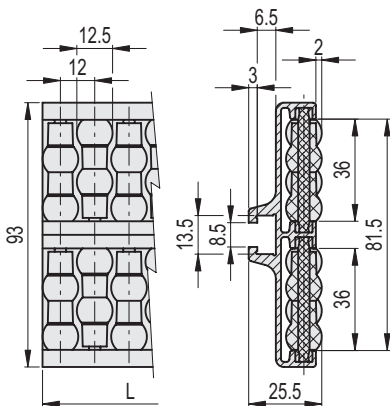

Fig.1



GLA-2-RS



GLA-2-RC

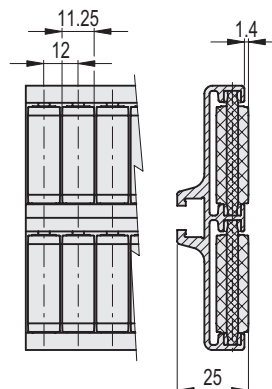

GLA-2-RT

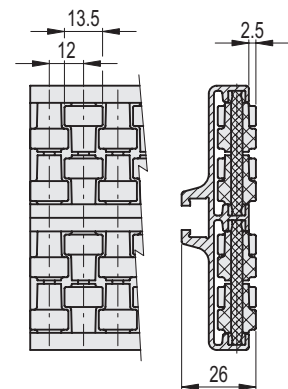

GLA-2-RS

Code	Description	L	△△
419115	GLA-2-RS-93-1440	1440	3170
419111	GLA-2-RS-93-3000	3000	6600

GLA-2-RC

Code	Description	L	△△
419114	GLA-2-RC-93-1440	1440	3170
419112	GLA-2-RC-93-3000	3000	6600

GLA-2-RT

Code	Description	L	△△
419116	GLA-2-RT-93-1440	1440	3170
419113	GLA-2-RT-93-3000	3000	6600



PROFILE

Anodised aluminium, natural colour, matte finish.

PINS SUPPORT

Acetal resin based (POM) technopolymer, white colour.

PINS

AISI 304 stainless steel.

ROLLERS

Polyethylene based (PE) technopolymer, grey colour.

STANDARD EXECUTIONS

- **GCA-2-RS**: with shaped rollers, spherical contact.
- **GCA-2-RC**: with cylindrical rollers.
- **GCA-2-RT**: with shaped rollers, cylindrical contact.

FEATURES AND APPLICATIONS

GCA-2 central guides are self-supporting structures for the side guide of products with limited vertical dimensions on conveyor belts (Fig.1).

Depending on the product to transport, it is recommended to use:

- GCA-2-RS: for the guide of products in cans or in plastic containers;
- GCA-2-RC: for the guide of cardboard products, for a greater fluency;
- GCA-2-RT: for the guide of glass products, in case of accidental breakage they facilitate the expulsion of debris.

Supplied assembled in bars of 1440 or 3000 mm length.

SPECIAL EXECUTIONS ON REQUEST

- Central guides with rollers in different colours.
- Central guides with pins in acetal resin based (POM) technopolymer.

ACCESSORIES ON REQUEST

- BDG: zinc-plated steel connecting bar for guides.
- TGL: closing cap for guides.
- PGC-2: separation block for central guide.
- MPG-P: assembly pin.
- MPG-V: zinc-plated steel hammer head screw. (see GLA-1).

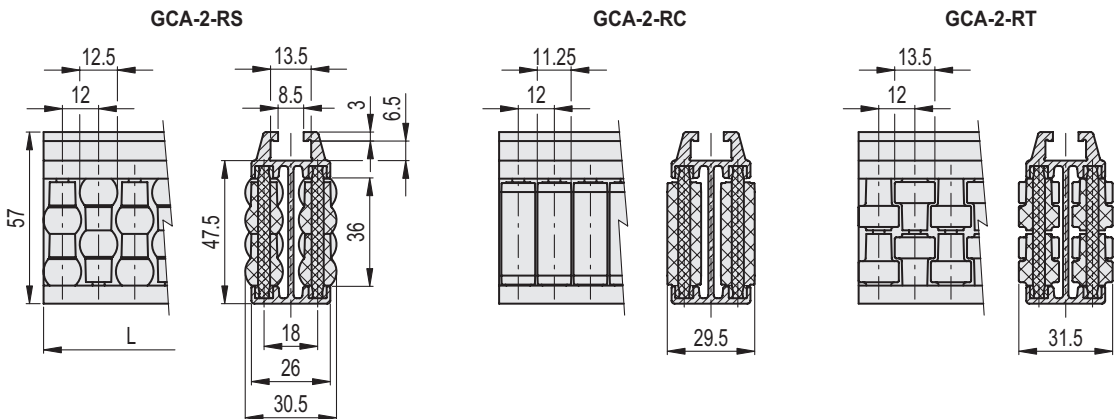
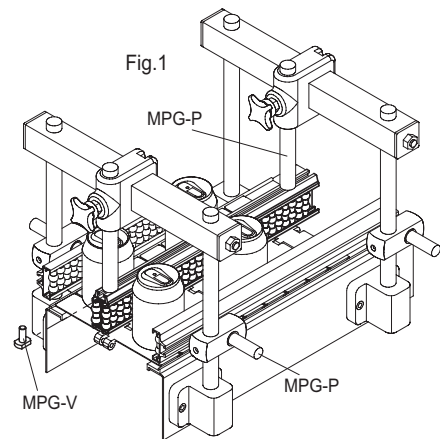

GCA-2-RS

Code	Description	L	⚖
419125	GCA-2-RS-57-1440	1440	3170
419121	GCA-2-RS-57-3000	3000	6600

GCA-2-RC

Code	Description	L	⚖
419126	GCA-2-RC-57-1440	1440	3170
419122	GCA-2-RC-57-3000	3000	6600

GCA-2-RT

Code	Description	L	⚖
419124	GCA-2-RT-57-1440	1440	3170
419123	GCA-2-RT-57-3000	3000	6600



PROFILE

Anodised aluminium, natural colour, matte finish.

PINS SUPPORT

Acetal resin based (POM) technopolymer, white colour.

PINS

AISI 304 stainless steel.

ROLLERS

Polyethylene based (PE) technopolymer, grey colour.

STANDARD EXECUTIONS

- **GCA-4-RS**: with shaped rollers, spherical contact.
- **GCA-4-RC**: with cylindrical rollers.
- **GCA-4-RT**: with shaped rollers, cylindrical contact.

FEATURES AND APPLICATIONS

GCA-4 central guides are self-supporting structures for the side guide of products with important vertical dimensions on conveyor belts (Fig.1).

Depending on the product to transport, it is recommended to use:

- GCA-4-RS: for the guide of products in cans or in plastic containers;
- GCA-4-RC: for the guide of cardboard products, for a greater fluency;
- GCA-4-RT: for the guide of glass products, in case of accidental breakage they facilitate the expulsion of debris.

Supplied assembled in bars of 1440 or 3000 mm length.

SPECIAL EXECUTIONS ON REQUEST

- Central guides with rollers in different colours.
- Central guides with pins in acetal resin based (POM) technopolymer.

ACCESSORIES ON REQUEST

- BDG: zinc-plated steel connecting bar for guides.
- TGL: closing cap for guides.
- PGC-4: separation block for central guide.
- MPG-P: assembly pin.
- MPG-V: zinc-plated steel hammer head screw. (see GLA-1).

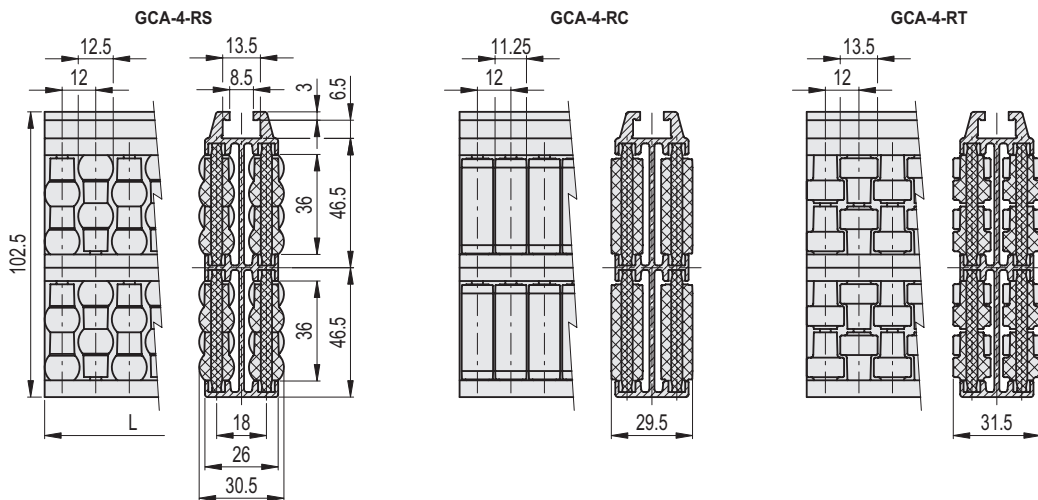
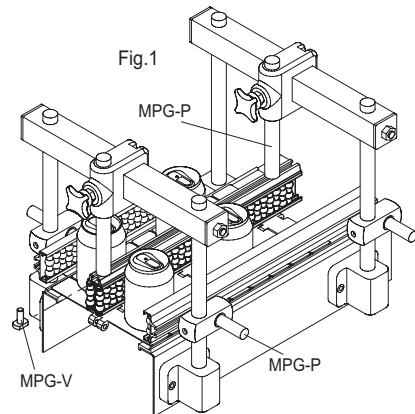
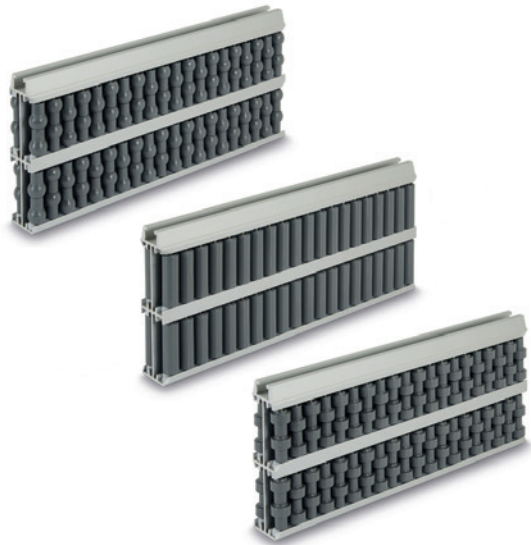

GCA-4-RS

Code	Description	L	△△
419134	GCA-4-RS-103-1440	1440	6260
419131	GCA-4-RS-103-3000	3000	13040

GCA-4-RC

Code	Description	L	△△
419135	GCA-4-RC-103-1440	1440	6260
419132	GCA-4-RC-103-3000	3000	13040

GCA-4-RT

Code	Description	L	△△
419136	GCA-4-RT-103-1440	1440	6260
419133	GCA-4-RT-103-3000	3000	13040



MATERIAL

Polyamide-based (PA) technopolymer, grey colour.

SCREW AND NUT

AISI 304 stainless steel

FEATURES AND APPLICATIONS

TGL closing cap is used at the ends of GLA side guides (Fig.1) and GCA central guides (Fig.2).

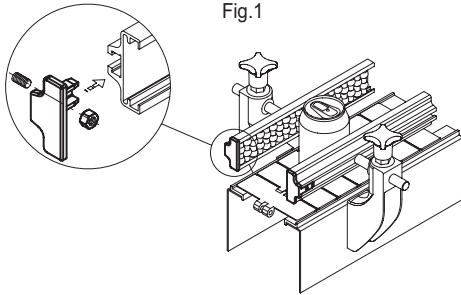

Fig.1

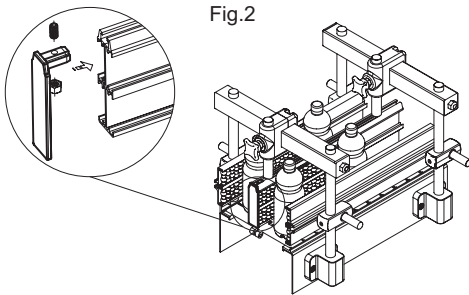
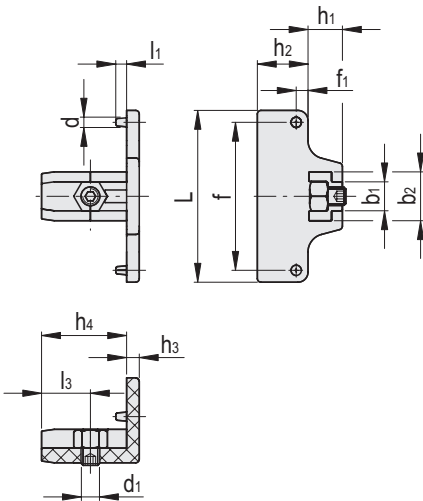

Fig.2



TGL-24-48
TGL-24-93



TGL-57-26
TGL-99-26

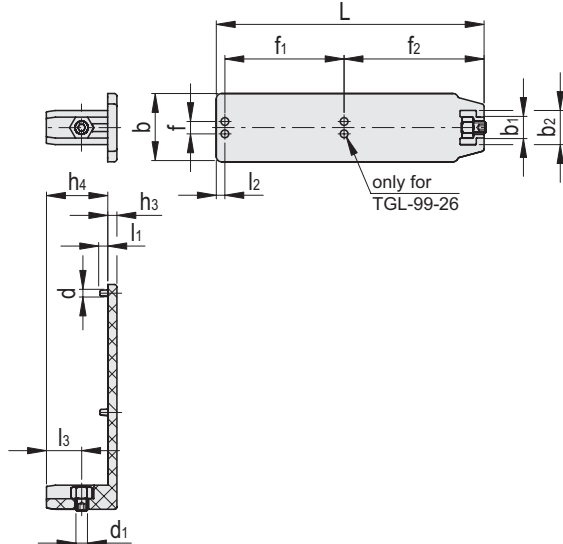

Code	Description	d	d1	f1	L	f	f2	b	b1	b2	h1	h2	h3	h4	l1	l2	l3	Δ
419143	TGL-24-48	2.5	M5	3.2	47.5	40.9	-	-	8	13.5	9.5	14	3.5	23.5	3	-	13.5	10
419144	TGL-24-93	2.5	M5	3.2	93	86	-	-	8	13	9.5	14	3.5	23.5	3	-	13.5	16
419142	TGL-57-26	2.5	M5	-	57.4	4.7	-	26.2	8	13	-	-	3.5	23.5	3	3.3	13.5	11
419140	TGL-99-26	2.5	M5	45.7	102.7	4.7	53.7	26.2	8	13	-	-	3.5	23.5	3	3.3	13.5	17

MATERIAL

Polyethylene based (PE) technopolymer, grey colour.

SCREWS AND NUTS WITH THREAD LOCK

AISI 304 stainless steel

FEATURES AND APPLICATIONS

PGL-1 separation block is used at the ends of GLA-1 side guides (Fig.1).

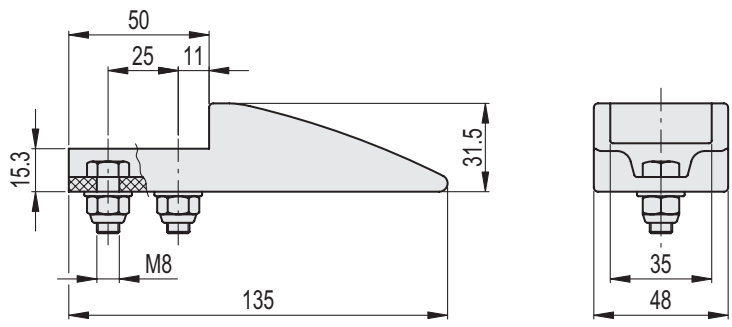
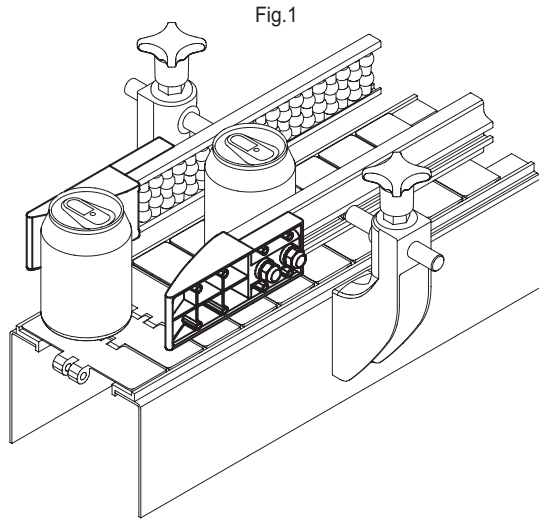

Code	Description	⚖
419145	PGL-1-48-135	80

MATERIAL

Polyethylene based (PE) technopolymer, grey colour.

SCREWS AND NUTS WITH THREAD LOCK

AISI 304 stainless steel

FEATURES AND APPLICATIONS

PGL-2 separation block is used at the ends of GLA-2 side guides (Fig.1).

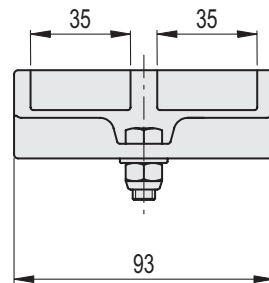
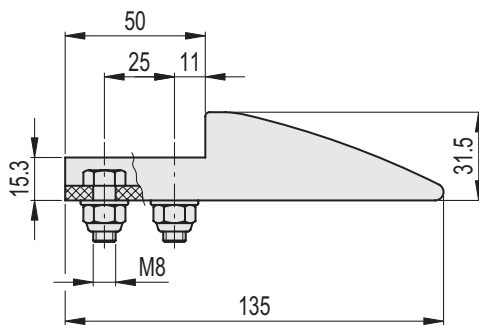
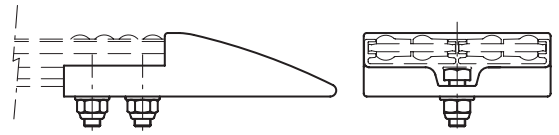
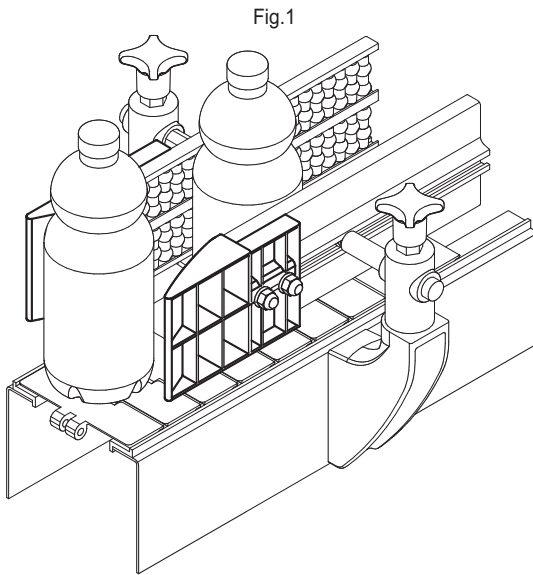

Code	Description	⚖️
419149	PGL-2-93-135	120

MATERIAL

Polyethylene based (PE) technopolymer, grey colour.

SCREWS AND NUTS WITH THREAD LOCK

AISI 304 stainless steel

FEATURES AND APPLICATIONS

PGC-2 separation block is used at the ends of GCA-2 central guides (Fig.1).

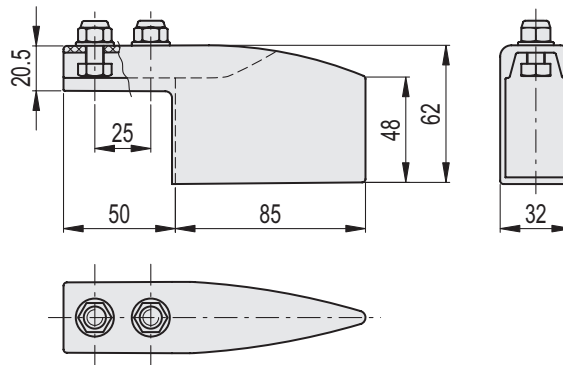
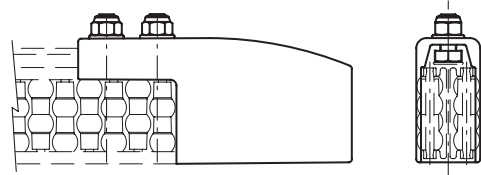
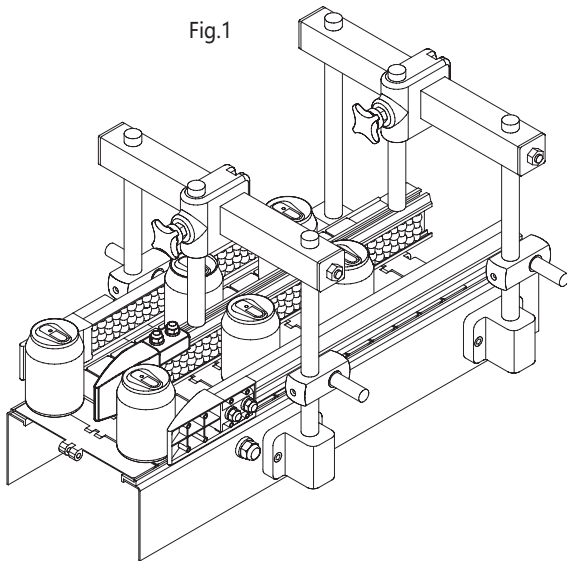

Code	Description	△
419147	PGC-2-62-135	90

MATERIAL

Polyethylene based (PE) technopolymer, grey colour.

SCREWS AND NUTS WITH THREAD LOCK

AISI 304 stainless steel

FEATURES AND APPLICATIONS

PGC-4 separation block is used at the ends of GCA-4 central guides (Fig.1).

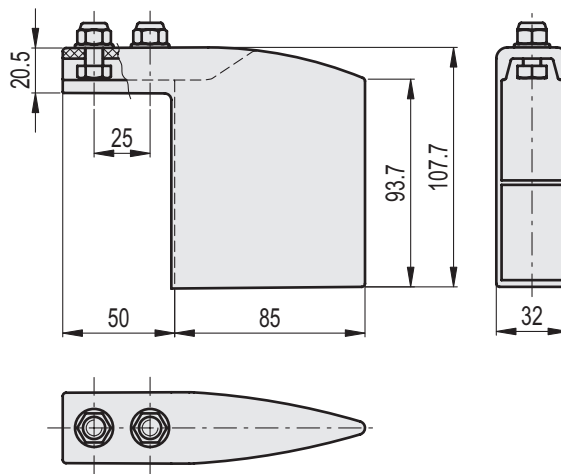
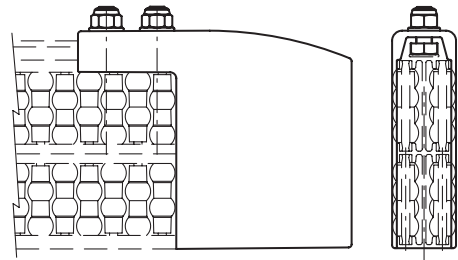
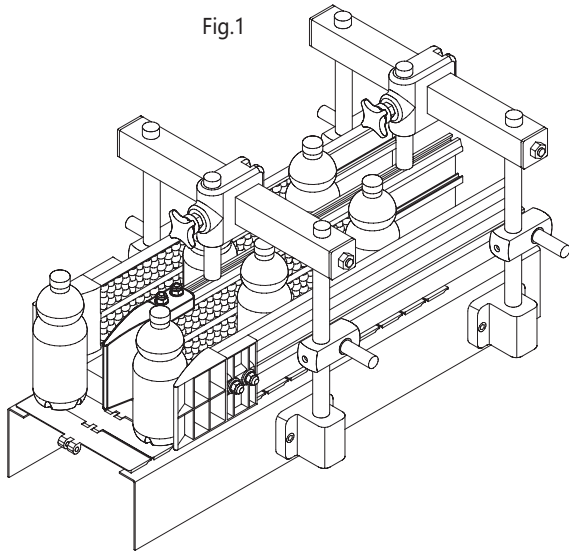

Code	Description	
419151	PGC-4-108-135	130

STANDARD EXECUTIONS

- **BDG**: zinc-plated steel.
- **BDG-SST**: AISI 304 stainless steel.

SCREWS

Zinc-plated steel or stainless steel.

FEATURES AND APPLICATIONS

BDG connecting bar is used for connecting the profiles (Fig.1) of the different side guides (GLA) or central guides (GCA). It is supplied with 4 assembly grub screws M8x10 with hexagon socket.

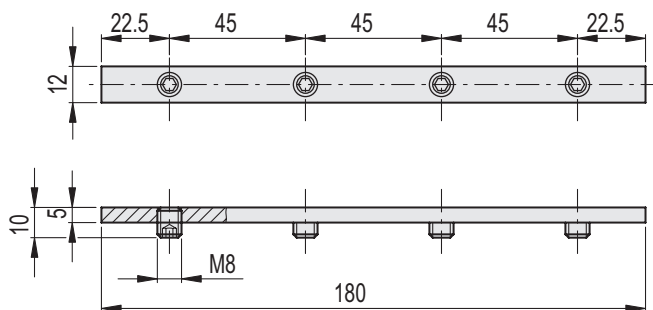
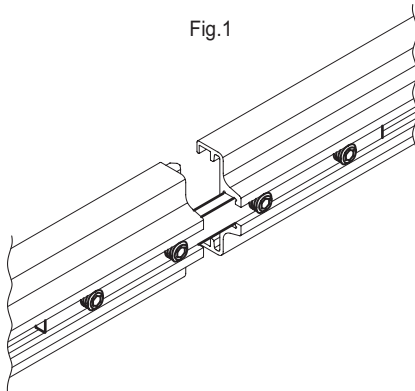

BDG		
Code	Description	△
419141	BDG-12-180	88

BDG-SST		
Code	Description	△
419139	BDG-SST-12-180	89



PROFILE

Zinc-plated steel.

PINS SUPPORT

Glass-fibre reinforced acetal resin based (PA) technopolymer, black colour.

PINS

AISI 304 stainless steel.

ROLLERS

Shaped with cylindrical contact area, in acetal resin technopolymer, white colour.

STANDARD EXECUTIONS

- **GLD-1-AZ:** one row of rollers.
- **GLD-2-AZ:** two rows of rollers.
- **GLD-3-AZ:** three rows of rollers.
- **GLD-4-AZ:** four rows of rollers.

FEATURES AND APPLICATIONS

The GLD-AZ side guides are particularly solid self-supporting structures, suitable for handling products of significant weight and size (e.g. pallets).

The shaped rollers are particularly suitable for glass product guides, as in the event of accidental breakages they facilitate the expulsion of debris.

SPECIAL EXECUTIONS ON REQUEST

Roller side guides with zinc-plated steel profile, length 3129 mm.

ACCESSORIES ON REQUEST

- MPG-R-AZ: guide rail clamps
- MPG-P: fixing pin (419513 MPG-P16-M10x17).
- SPF: guide rail brackets for linear positioning.
- SPR: guide rail brackets for linear and corner positioning.
- SPR.V: guide rail brackets for linear and corner positioning.

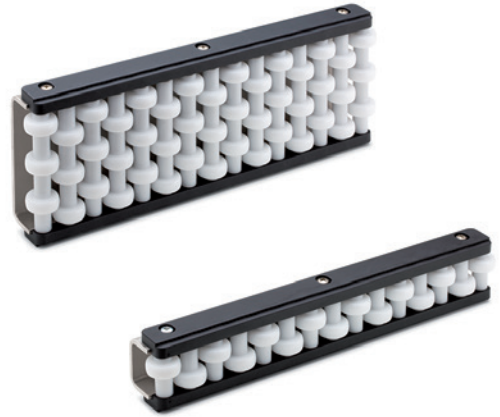
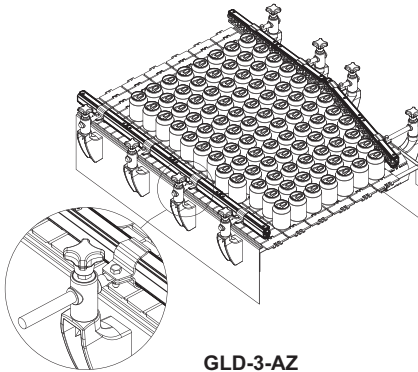
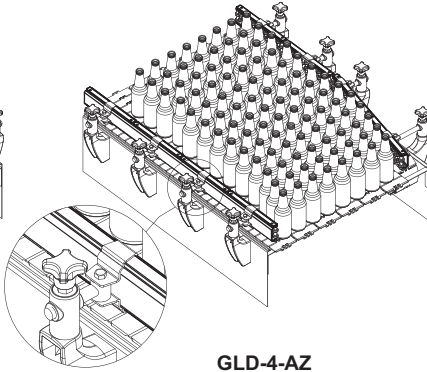
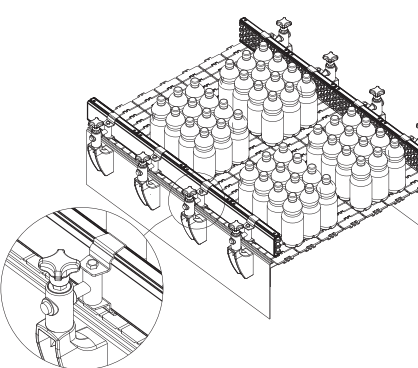
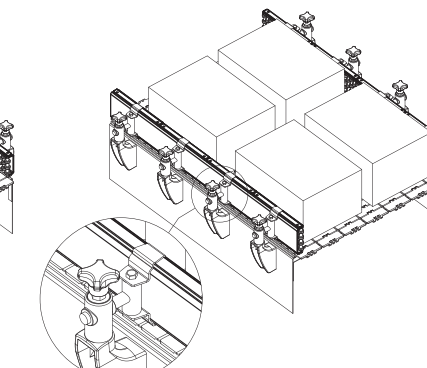
**GLD-1-AZ****GLD-2-AZ****GLD-3-AZ****GLD-4-AZ**

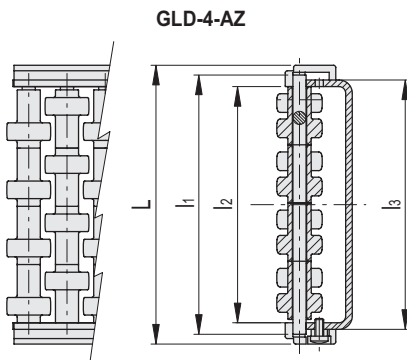
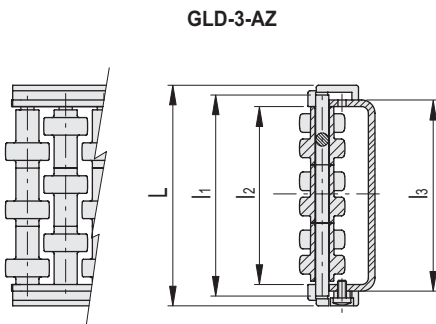
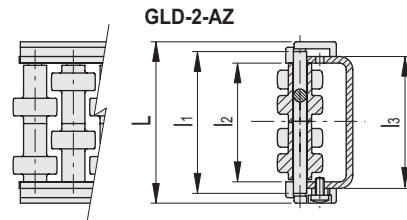
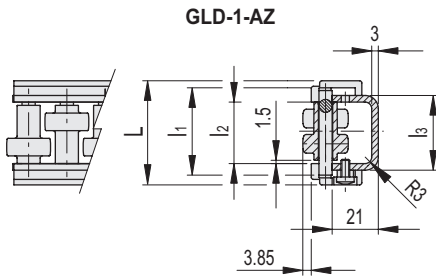
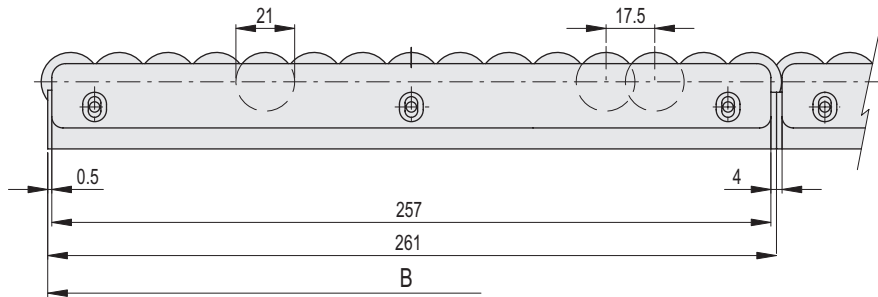

GLD-1-AZ

Code	Description	L	B	l1	l2	l3	Mounting brackets	△△
419301	GLD-1-AZ-RT-47-1041	47.4	1041	38.5	28	34	MPG-R-AZ-1	2660
419303	GLD-1-AZ-RT-47-2085	47.4	2085	38.5	28	34	MPG-R-AZ-1	5320

GLD-2-AZ

Code	Description	L	B	l1	l2	l3	Mounting brackets	△△
419311	GLD-2-AZ-RT-73-1041	73.4	1041	64.5	54	60	MPG-R-AZ-2	3940
419313	GLD-2-AZ-RT-73-2085	73.4	2085	64.5	54	60	MPG-R-AZ-2	7880

GLD-3-AZ

Code	Description	L	B	l1	l2	l3	Mounting brackets	△△
419321	GLD-3-AZ-RT-100-1041	100.4	1041	91.5	81	87	MPG-R-AZ-3	5188
419323	GLD-3-AZ-RT-100-2085	100.4	2085	91.5	81	87	MPG-R-AZ-3	10376

GLD-4-AZ

Code	Description	L	B	l1	l2	l3	Mounting brackets	△△
419331	GLD-4-AZ-RT-127-1041	126.9	1041	118	107.5	113.5	MPG-R-AZ-4	6420
419333	GLD-4-AZ-RT-127-2085	126.9	2085	118	107.5	113.5	MPG-R-AZ-4	12840

PROFILE

AISI 304 stainless steel.

PINS SUPPORT

Glass-fibre reinforced acetal resin based (PA) technopolymer, black colour.

PINS

AISI 304 stainless steel.

ROLLERS

Shaped with cylindrical contact area, in acetal resin technopolymer, white colour.

STANDARD EXECUTIONS

- **GLD-1-SST**: one row of rollers.
- **GLD-2-SST**: two rows of rollers.
- **GLD-3-SST**: three rows of rollers.
- **GLD-4-SST**: four rows of rollers.

FEATURES AND APPLICATIONS

The GLD-SST side guides are particularly solid self-supporting structures, suitable for handling products of significant weight and size (e.g. pallets).

The shaped rollers are particularly suitable for glass product guides, as in the event of accidental breakages they facilitate the expulsion of debris.

SPECIAL EXECUTIONS ON REQUEST

Roller side guides with zinc-plated steel profile, length 3129 mm.

ACCESSORIES ON REQUEST

- MPG-R-SST: guide rail clamps
- MPG-P: fixing pin (419513 MPG-P16-M10x17).
- SPF: guide rail brackets for linear positioning.
- SPR: guide rail brackets for linear and corner positioning.
- SPR.V: guide rail brackets for linear and corner positioning.

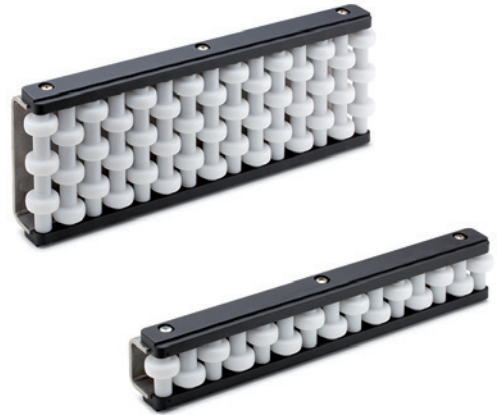
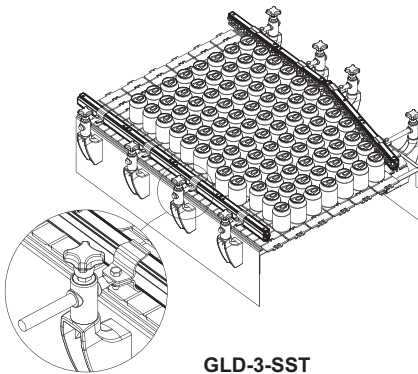
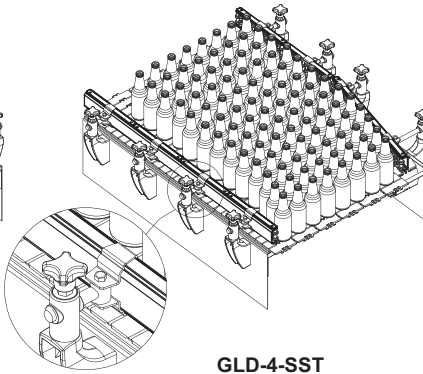
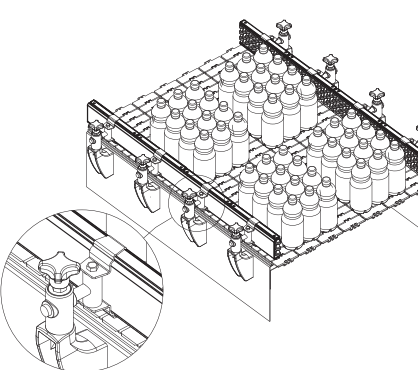
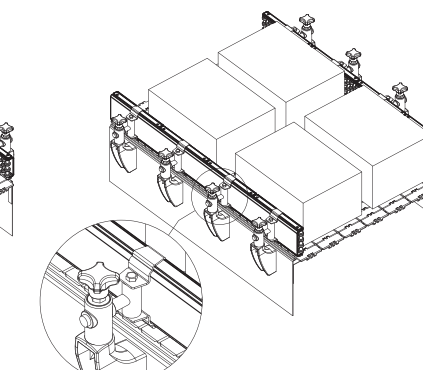
**GLD-1-SST****GLD-2-SST****GLD-3-SST****GLD-4-SST**

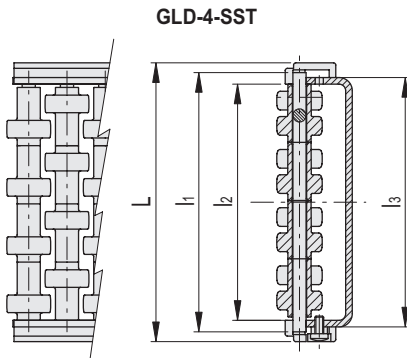
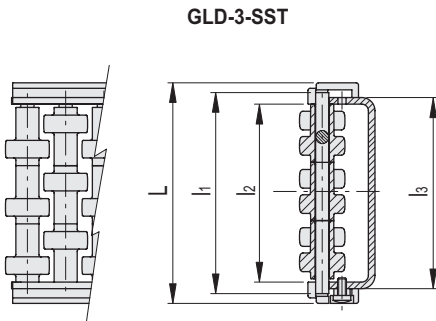
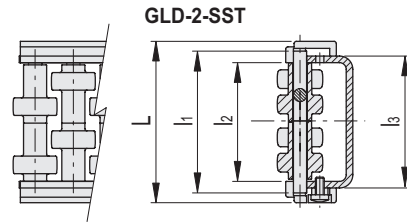
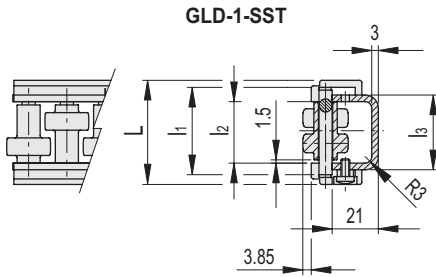
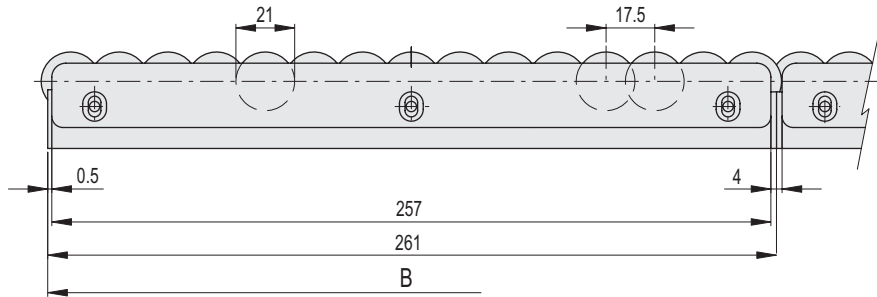

GLD-1-SST



Code	Description	L	B	l1	l2	l3	Mounting brackets	⚖
419302	GLD-1-SST-RT-47-1041	47.4	1041	38.5	28	34	MPG-R-SST-1	2686
419304	GLD-1-SST-RT-47-2085	47.4	2085	38.5	28	34	MPG-R-SST-1	5373

GLD-2-SST

Code	Description	L	B	l1	l2	l3	Mounting brackets	⚖
419312	GLD-2-SST-RT-73-1041	73.4	1041	64.5	54	60	MPG-R-SST-2	3979
419314	GLD-2-SST-RT-73-2085	73.4	2085	64.5	54	60	MPG-R-SST-2	7958

GLD-3-SST

Code	Description	L	B	l1	l2	l3	Mounting brackets	⚖
419322	GLD-3-SST-RT-100-1041	100.4	1041	91.5	81	87	MPG-R-SST-3	5238
419324	GLD-3-SST-RT-100-2085	100.4	2085	91.5	81	87	MPG-R-SST-3	10479

GLD-4-SST

Code	Description	L	B	l1	l2	l3	Mounting brackets	⚖
419332	GLD-4-SST-RT-127-1041	126.9	1041	118	107.5	113.5	MPG-R-SST-4	4484
419334	GLD-4-SST-RT-127-2085	126.9	2085	118	107.5	113.5	MPG-R-SST-4	12968

MATERIAL

Zinc-plated steel.

STANDARD EXECUTIONS

- **MPG-R-AZ-1**: for one-track roller side guides.
- **MPG-R-AZ-2**: for two-track roller side guides.
- **MPG-R-AZ-3**: for three-track roller side guides.
- **MPG-R-AZ-4**: for four-track roller side guides.

FEATURES AND APPLICATIONS

The MPG-R-AZ guide rail clamps are used for fixing the GLD-AZ side guides.

They are supplied in kits including clamps, pin, screw and nut (MPG-R-AZ-1), or clamps, screws and spacer (MPG-R-AZ-2 / MPG-R-AZ-3 / MPG-R-AZ-4).

Supplied unassembled

ACCESSORIES ON REQUEST

MPG-P: fixing pin (419513 MPG-P16-M10x17) for use in combination with MPG-R-AZ-2 / MPG-R-AZ-3 / MPG-R-AZ-4 clamps.

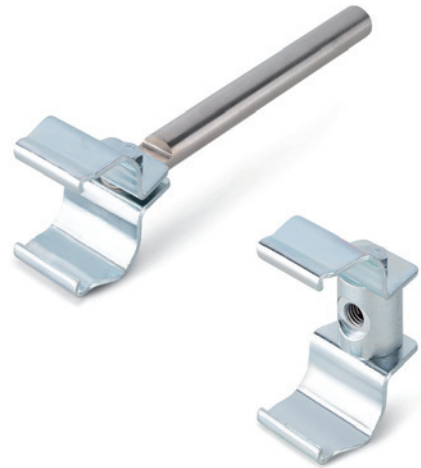
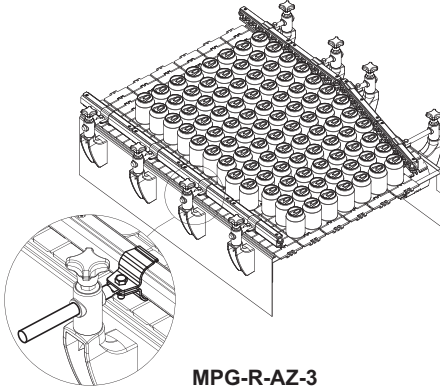
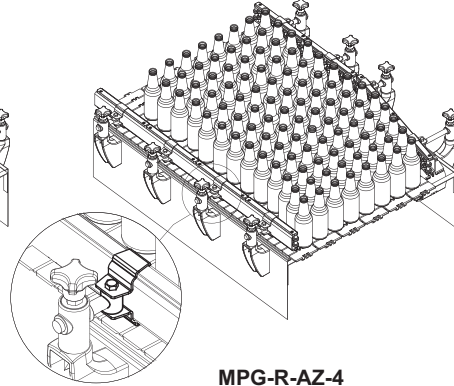
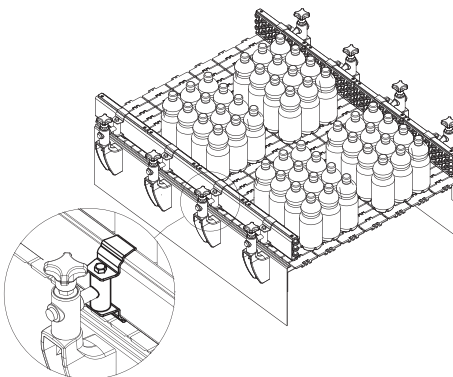
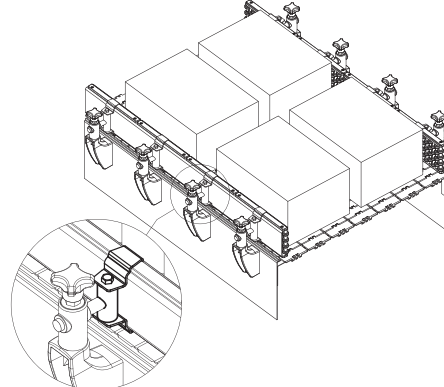
**MPG-R-AZ-1****MPG-R-AZ-2****MPG-R-AZ-3****MPG-R-AZ-4**

MPG-R-AZ-1

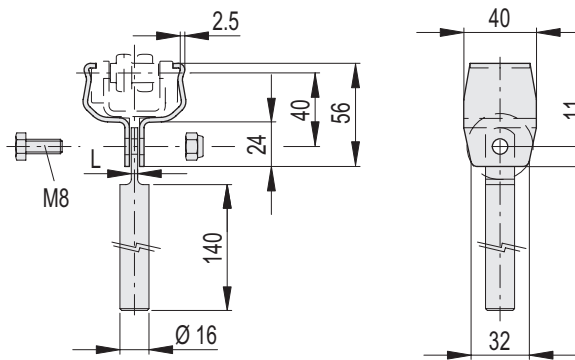

MPG-R-AZ-2

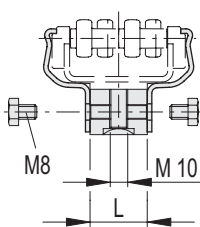

MPG-R-AZ-3

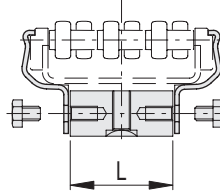

MPG-R-AZ-4

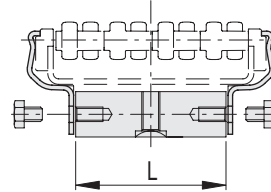

MPG-R-AZ-1

Code	Description	L	Linear guide rails	△△
419351	MPG-R-AZ-1	3.5	GLD-1-AZ	350

MPG-R-AZ-2

Code	Description	L	Linear guide rails	△△
419353	MPG-R-AZ-2	31	GLD-2-AZ	310

MPG-R-AZ-3

Code	Description	L	Linear guide rails	△△
419361	MPG-R-AZ-3	56	GLD-3-AZ	350

MPG-R-AZ-4

Code	Description	L	Linear guide rails	△△
419363	MPG-R-AZ-4	82	GLD-4-AZ	310

MATERIAL

AISI 304 stainless steel.

STANDARD EXECUTIONS

- **MPG-R-SST-1:** for one-track roller side guides.
- **MPG-R-SST-2:** for two-track roller side guides.
- **MPG-R-SST-3:** for three-track roller side guides.
- **MPG-R-SST-4:** for four-track roller side guides.

FEATURES AND APPLICATIONS

The MPG-R-SST guide rail clamps are used for fixing the GLD-SST side guides.

They are supplied in kits including clamps, pin, screw and nut (MPG-R-SST-1), or clamps, screws and spacer (MPG-R-SST-2 / MPG-R-SST-3 / MPG-R-SST-4).

Supplied not assembled.

ACCESSORIES ON REQUEST

MPG-P: fixing pin (419513 MPG-P16-M10x17) for use in combination with MPG-R-SST-2 / MPG-R-SST-3 / MPG-R-SST-4 clamps.

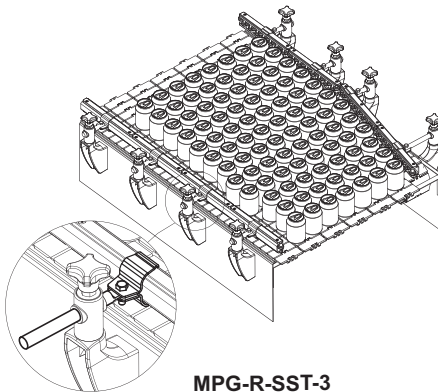
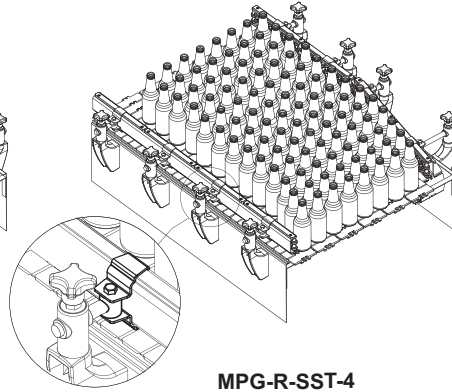
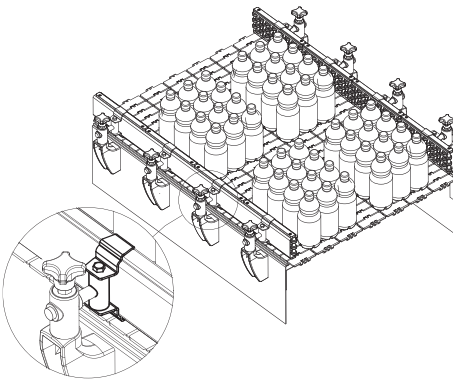
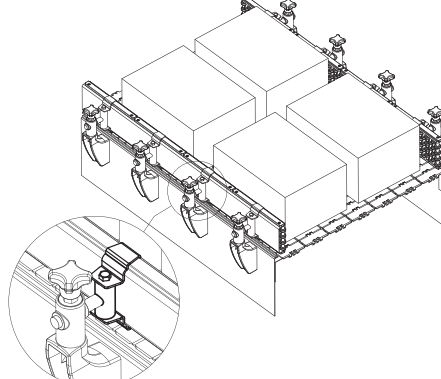
**MPG-R-SST-1****MPG-R-SST-2****MPG-R-SST-3****MPG-R-SST-4**

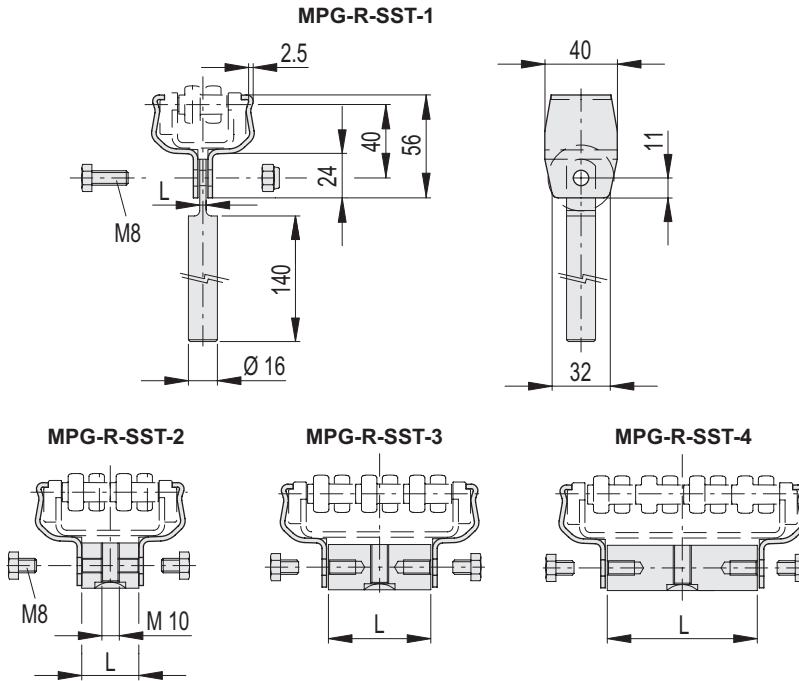

MPG-R-SST-1



Code	Description	L	Linear guide rails	⚖️
419352	MPG-R-SST-1	3.5	GLD-1-SST	220

MPG-R-SST-2



Code	Description	L	Linear guide rails	⚖️
419354	MPG-R-SST-2	31	GLD-2-SST	410

MPG-R-SST-3



Code	Description	L	Linear guide rails	⚖️
419362	MPG-R-SST-3	56	GLD-3-SST	220

MPG-R-SST-4



Code	Description	L	Linear guide rails	⚖️
419364	MPG-R-SST-4	82	GLD-4-SST	410

SELF-SUPPORTING STRUCTURE

Acetal resin based (POM) technopolymer, black colour.

PINS

AISI 304 stainless steel.

ROLLERS

Polyethylene based (PE) technopolymer, grey colour.

STANDARD EXECUTIONS

- **GLB-1-RS**: with spherical contact rollers.
- **GLB-1-RC**: with cylindrical contact rollers.
- **GLB-1-RT**: with round contact rollers.

FEATURES AND APPLICATIONS

GLB-1 side guides are modular self-supporting structures for the side guide of products with limited vertical dimensions on conveyor belts (Fig.1).

Particularly suitable for use in wet environments.

Depending on the product to transport, it is recommended to use:

- GLB-1-RS: for the guide of products in cans or in plastic containers;
- GLB-1-RC: for the guide of cardboard products, for a greater fluency;
- GLB-1-RT: for the guide of glass products, in case of accidental breakage they facilitate the expulsion of debris.

The joint in the roller side guides allows an external curvature radius 500 mm, internal curvature radius 350 mm.

Supplied already assembled in modules of 375 mm length, for profiles 40x8 mm.

SPECIAL EXECUTIONS ON REQUEST

- Side guides with self-supporting structure and rollers in different colours.
- Side guides with pins in acetal resin based (POM) technopolymer.

ACCESSORIES ON REQUEST

- PRA-GLB: AISI 304 stainless steel profile for side guides.
- PRB-GLB: AISI 304 stainless steel profile for side guides.

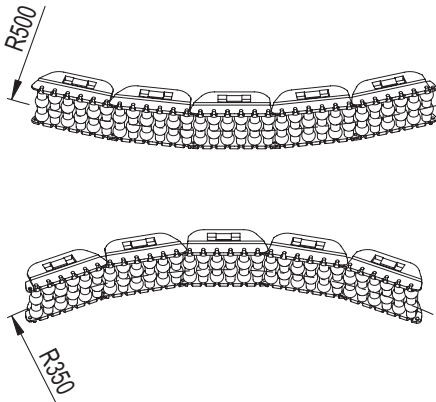
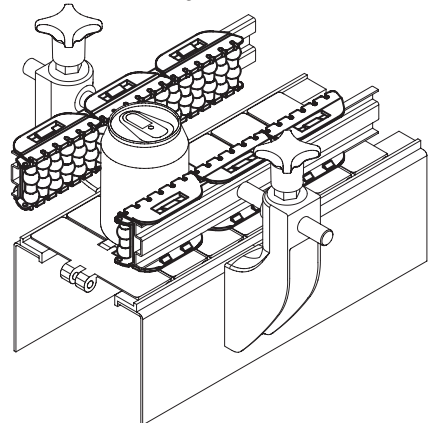
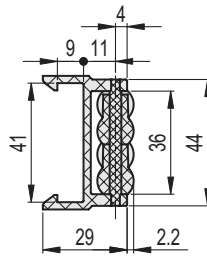
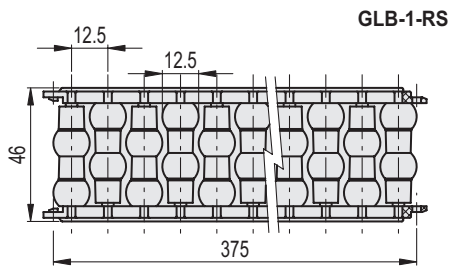

Fig.1





GLB-1-RS

INOX STAINLESS STEEL

Code	Description	⚖️
419161	GLB-1-RS-46-375	340

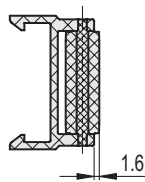
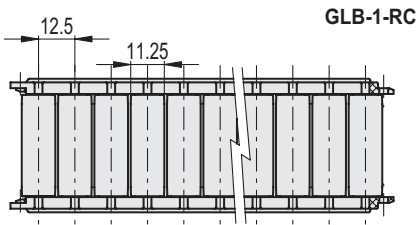

GLB-1-RC

INOX STAINLESS STEEL

Code	Description	⚖️
419162	GLB-1-RC-46-375	340

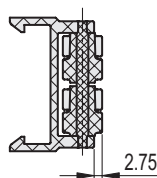
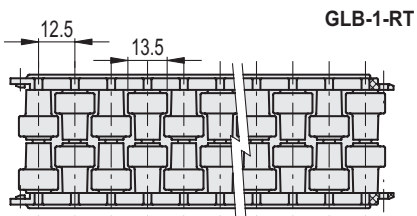

GLB-1-RT

INOX STAINLESS STEEL

Code	Description	⚖️
419163	GLB-1-RT-46-375	340

SELF-SUPPORTING STRUCTURE

Acetal resin based (POM) technopolymer, black colour.

PINS

AISI 304 stainless steel.

ROLLERS

Polyethylene based (PE) technopolymer, grey colour.

STANDARD EXECUTIONS

- **GLB-2-RS**: with spherical contact rollers.
- **GLB-2-RC**: with cylindrical contact rollers.
- **GLB-2-RT**: with round contact rollers.

FEATURES AND APPLICATIONS

GLB-2 side guides are modular self-supporting structures for the side guide of products with important vertical dimensions on conveyor belts (Fig.1).

Particularly suitable for use in wet environments.

Depending on the product to transport, it is recommended to use:

- GLB-2-RS: for the guide of products in cans or in plastic containers;
- GLB-2-RC: for the guide of cardboard products, for a greater fluency;
- GLB-2-RT: for the guide of glass products, in case of accidental breakage they facilitate the expulsion of debris.

The joint in the roller side guides allows an external curvature radius 500 mm, internal curvature radius 350 mm.

Supplied already assembled in modules of 375 mm length, for profiles 40x8 mm.

SPECIAL EXECUTIONS ON REQUEST

- Side guides with self-supporting structure and rollers in different colours.
- Side guides with pins in acetal resin based (POM) technopolymer.

ACCESSORIES ON REQUEST

- PRA-GLB: AISI 304 stainless steel profile for side guides.
- PRB-GLB: AISI 304 stainless steel profile for side guides.

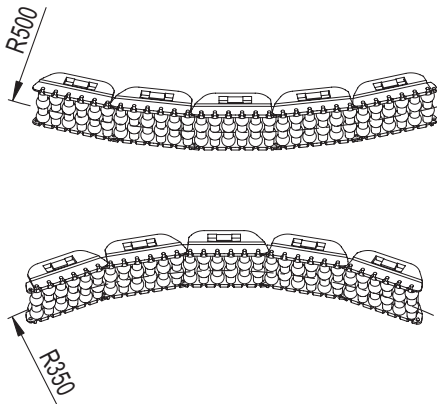
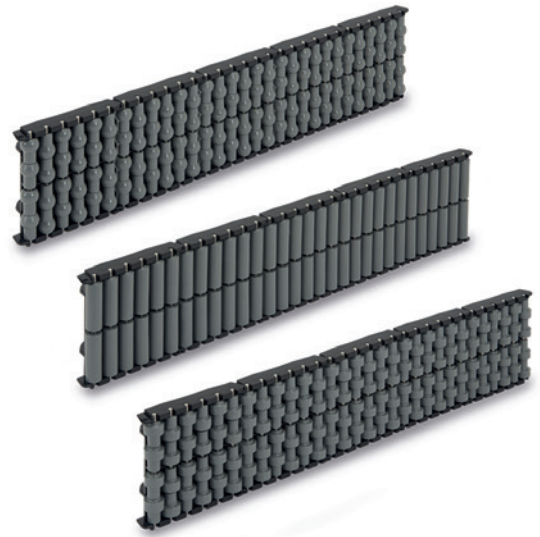
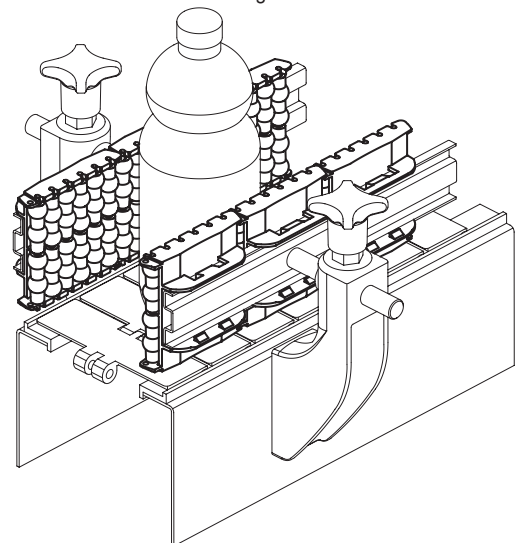
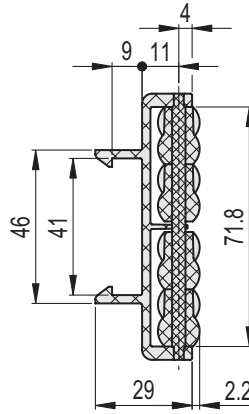
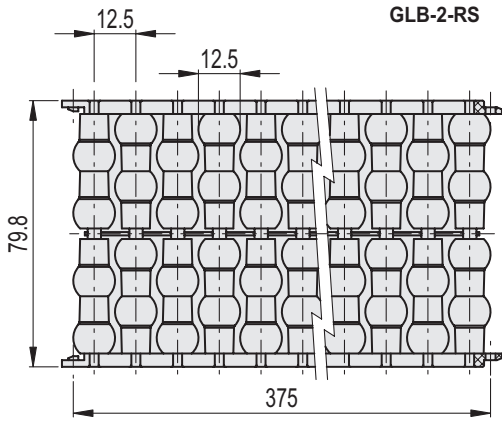

Fig.1





GLB-2-RS

INOX STAINLESS STEEL

Code	Description	⚖️
419171	GLB-2-RS-80-375	690

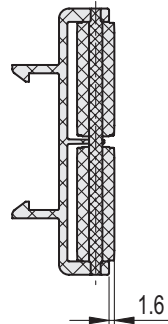
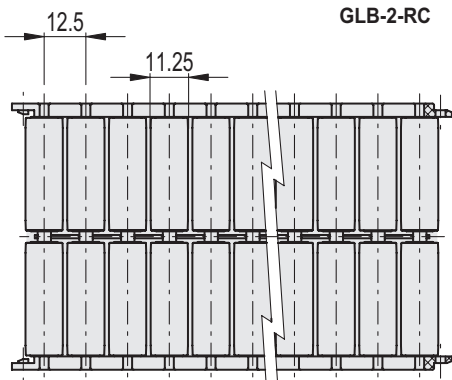

GLB-2-RC

INOX STAINLESS STEEL

Code	Description	⚖️
419172	GLB-2-RC-80-375	690

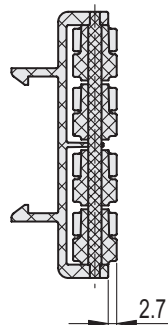
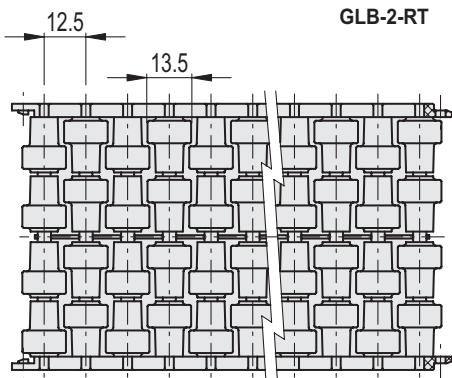

GLB-2-RT

INOX STAINLESS STEEL

Code	Description	⚖️
419173	GLB-2-RT-80-375	690

MATERIAL

AISI 304 stainless steel

FEATURES AND APPLICATIONS

PRA-GLB profile is used for GLB-1 and GLB-2 side guides assembly (Fig.1).

Supplied in bars not drilled of 1500 or 3000 mm length, to allow the drilling during the assembly.

ACCESSORIES ON REQUEST

- MPG-P: assembly pin.
- MPG-V: zinc-plated steel hammer head screw.

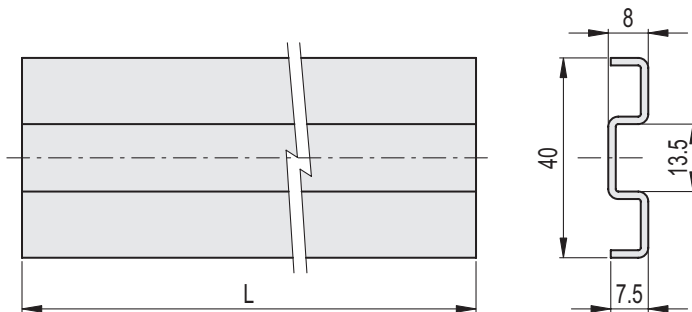
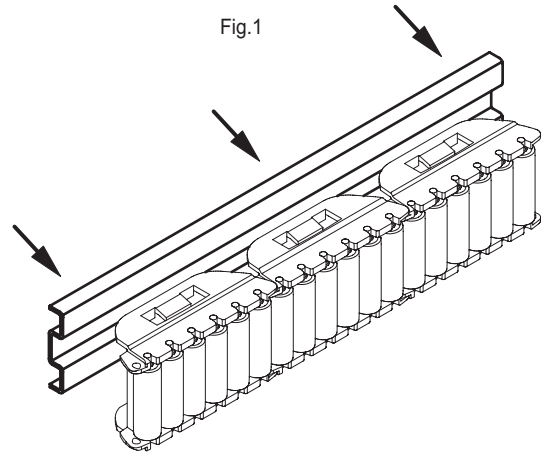
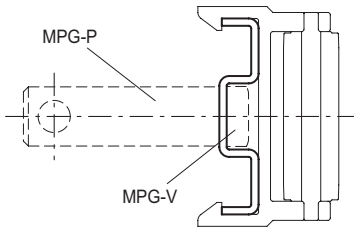

Code	Description	L	⚖️
419184	PRA-GLB-40-1500	1500	1008
419181	PRA-GLB-40-3000	3000	2020

MATERIAL

AISI 304 stainless steel

FEATURES AND APPLICATIONS

PRB-GLB profile is used for the assembly of GLB-1 and GLB-2 side guides (Fig.1).

Supplied in bars of 1500 or 3000 mm length.

ACCESSORIES ON REQUEST

- MPG-P: assembly pin.
- MPG-V: zinc-plated steel hammer head screw.

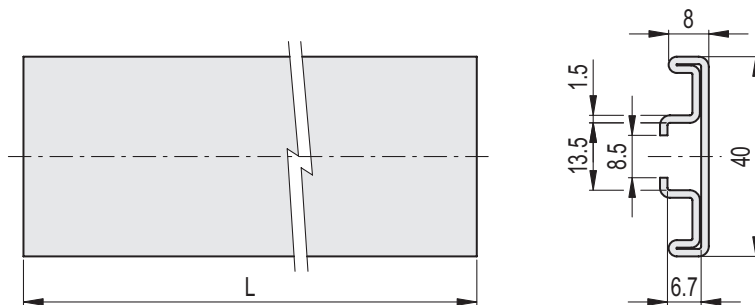
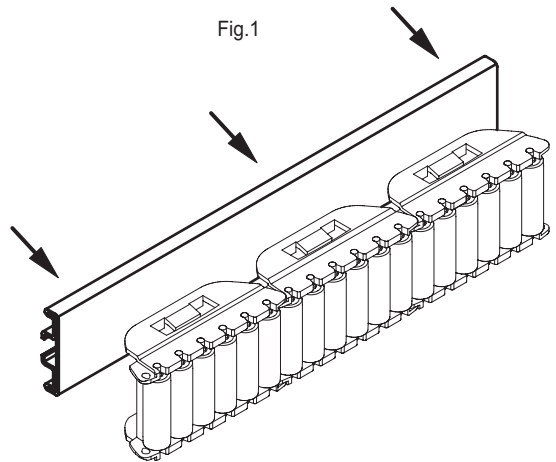
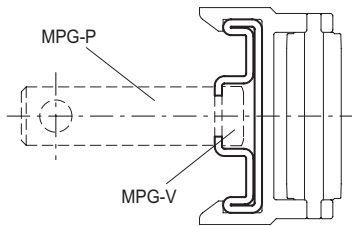

Code	Description	L	INOX STAINLESS STEEL
419186	PRB-GLB-40-1500	1500	1820
419183	PRB-GLB-40-3000	3000	3640

GUIDE PROFILE

AlSi 304 stainless steel with technopolymer coating (PEEK), grey colour.

BRACKET

Anodised aluminium.

FEATURES AND APPLICATIONS

GLF side guides are generally used to laterally guide bundles of heat-shrinkable polyethylene film on conveyor belts. The PEEK coating ensures minimal rolling resistance of the product and is also suitable for high-temperature applications.

Minimum coating thickness 40 µ, maximum 50 µ.

Supplied in bars of 1500 or 3000 mm length.

ACCESSORIES ON REQUEST

- GGLF: linear guide joint.
- TGLF: end cap.
- BDG: connecting plate for guides.
- MPG-P: guide fixing pins.
- MPG-V: hammer head screw.
- PGL-1: separation block for side guides.

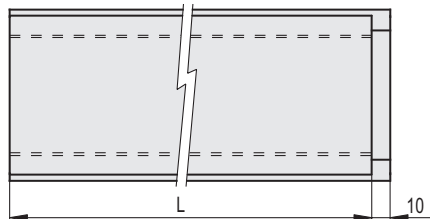
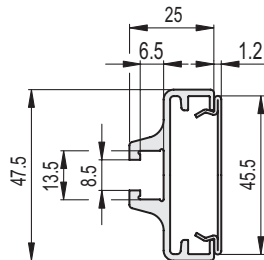
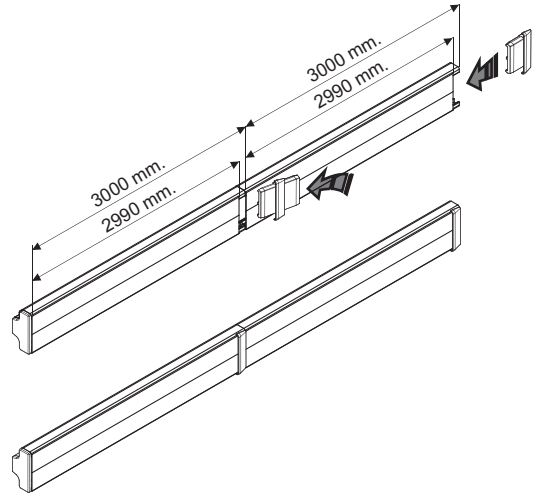
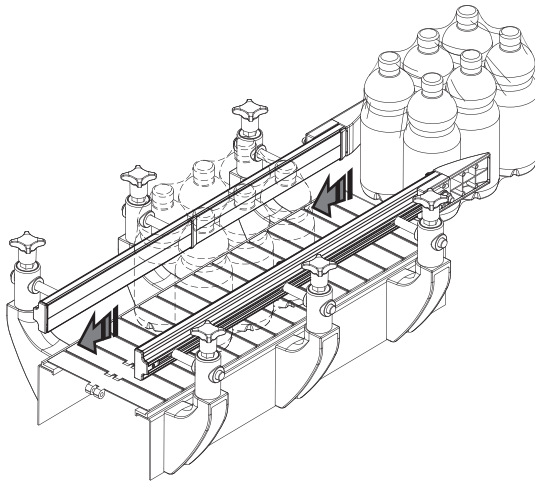

Code	Description	L	⚖️
419095	GLF-46-1500	1500	1675
419096	GLF-46-2990	2990	3350

GUIDE PROFILE

AISI 304 stainless steel with technopolymer coating (PEEK), grey colour.

BRACKET

Anodised aluminium.

FEATURES AND APPLICATIONS

GCF central guides are generally used to laterally guide bundles of heat-shrinkable polyethylene film on conveyor belts. The PEEK coating ensures minimal rolling resistance of the product and is also suitable for high-temperature applications.

Minimum coating thickness 40 µ, maximum 50 µ.

Supplied in bars of 1500 or 3000 mm length.

ACCESSORIES ON REQUEST

- BDG: connecting plate for guides.
- TGLF: closing cap for guides.
- GGLF: linear guide joint.
- PGC-2: separation block for central guide.
- MPG-P: guide assembly pin.
- MPG-V: zinc-plated steel hammer head screw.

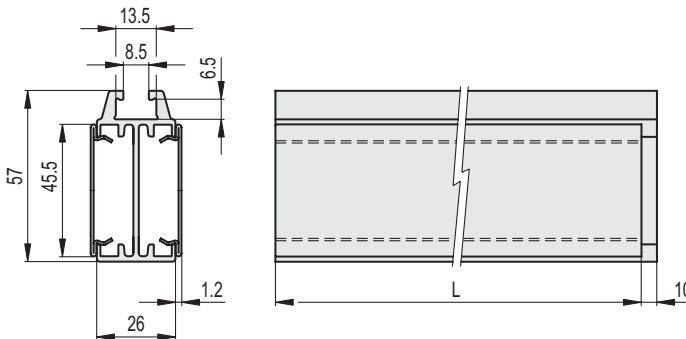
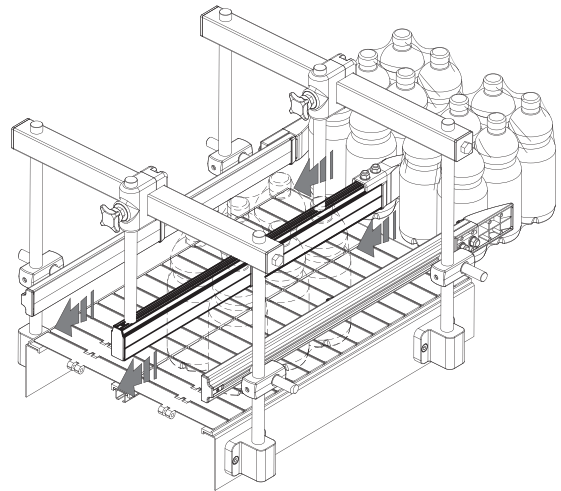

Code	Description	L	⚖
419091	GCF-46-1500	1500	2250
419092	GCF-46-2990	2990	4500

MATERIAL

Polyamide-based (PA) technopolymer, with self-lubricating additive, grey colour.

FEATURES AND APPLICATIONS

The GGLF joint is used as a connecting element at the ends of the GLF and GCF side guides (Fig.1). The self-lubricating additive guarantees maximum rolling resistance of the product.

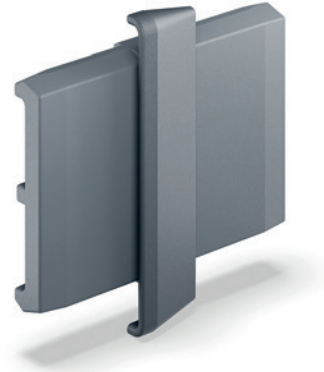
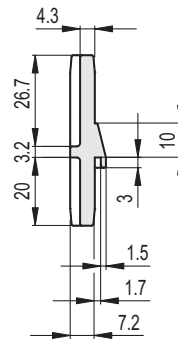
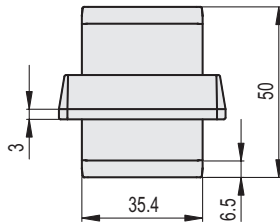
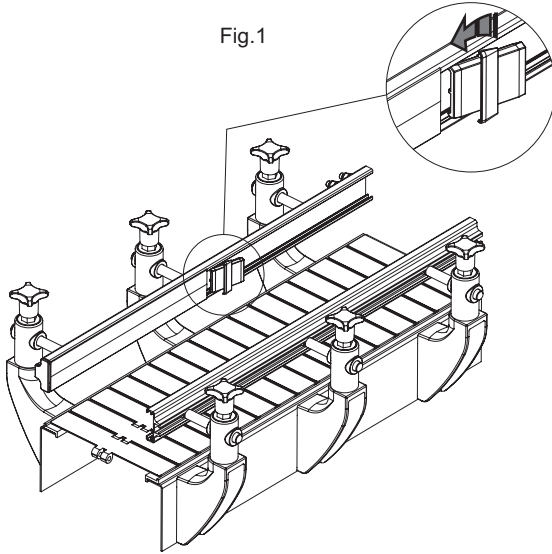

Fig.1



Code	Description	⚖
419098	GGLF-36-50	11

MATERIAL

Polyamide-based (PA) technopolymer, with self-lubricating additive, grey colour.

FEATURES AND APPLICATIONS

The TGLF end cap is used to close the ends of the side guides. GLF and GCF (Fig. 1). The self-lubricating additive guarantees maximum rolling resistance of the product.



Fig.1

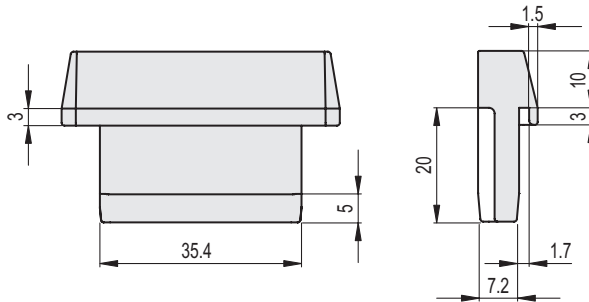
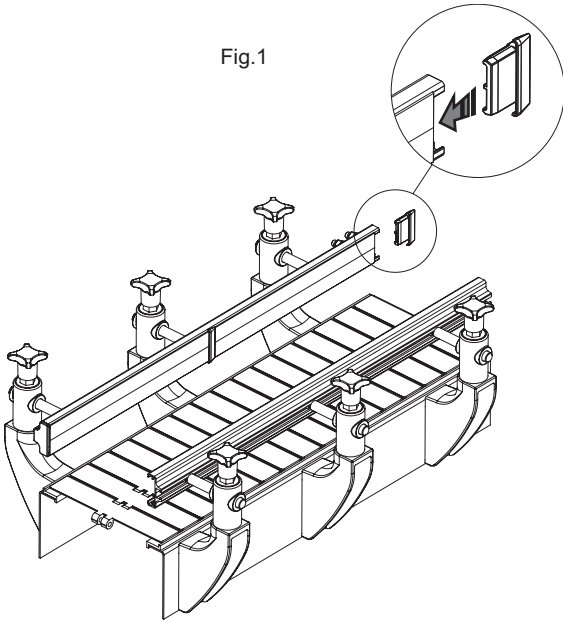

Code	Description	⚖
419779	TGLF-36-30	8

GUIDE PROFILE

Polyethylene based (HMWPE) technopolymer, natural colour.

BRACKET

AISI 304 stainless steel.

STANDARD EXECUTIONS

- **GLP-12:** contact surface width of about 12 mm.
- **GLP-32:** contact surface width of about 32 mm.

FEATURES AND APPLICATIONS

GLP guide rails are used for the side guide of products with different dimensions on conveyor belts (Fig.1), without leaving traces on the containers.

High molecular weight polyethylene (HMWPE) has a high wear resistance; it is particularly suitable for high-speed movements due to its low coefficient of friction.

Depending on the product to transport, it is recommended to use:

- GLP-12: for the guide of products with limited dimensions or for GLP-32 support (Fig.2);
- GLP-32: for the guide of products with important vertical dimensions. Supplied in bars of 1500 or 3000 mm length.

ACCESSORIES ON REQUEST

- Guide rail clamps MPG-T-S, MPG-2T, MPG-T.
- End brackets for linear guide rails TGLT.

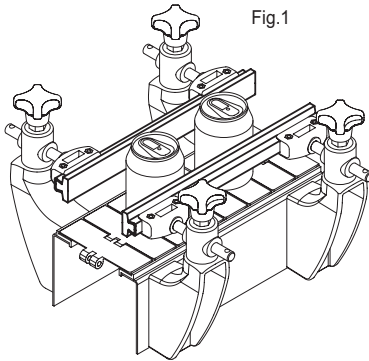

Fig.1

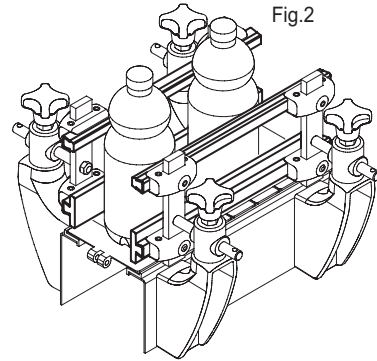
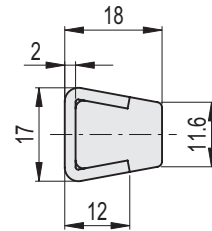
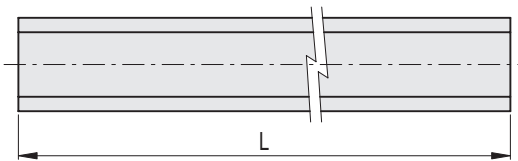
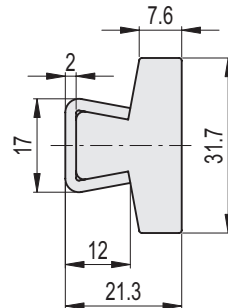
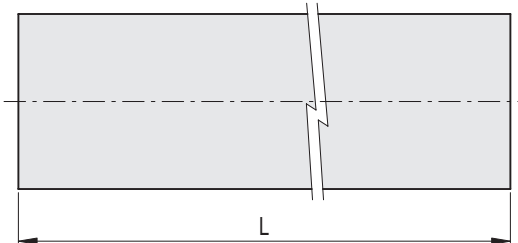

Fig.2

GLP-12



GLP-32



GLP-12



Code	Description	L	⚖
419204	GLP-12-1500	1500	1038
419201	GLP-12-3000	3000	2070

GLP-32



Code	Description	L	⚖
419205	GLP-32-1500	1500	1320
419202	GLP-32-3000	3000	2640

GUIDE PROFILE

Polytetrafluoroethylene based (PTFE) technopolymer, natural colour.

BRACKET

AISI 304 stainless steel.

FEATURES AND APPLICATIONS

GLP-HP guide rail is used for the side guide of products with different dimensions on conveyor belts (Fig.1), in environments with high temperature, such as ovens, fryers, steam chambers. It can also be used as a support for metal meshes inside ovens (Fig. 2) Supplied in bars of 1500 or 3000 mm length.

ACCESSORIES ON REQUEST

- Guide rail clamps MPG-T-S, MPG-2T, MPG-T.
- End brackets for linear guide rails TGLT.



Fig.1

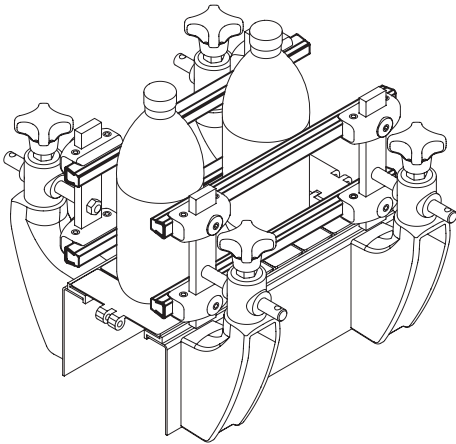
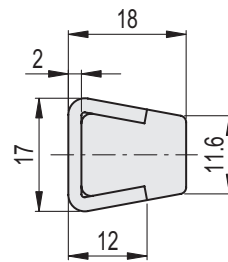
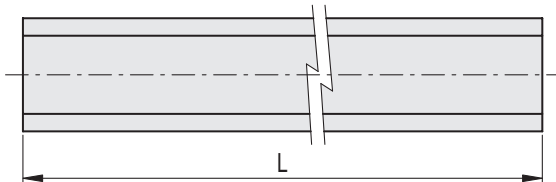
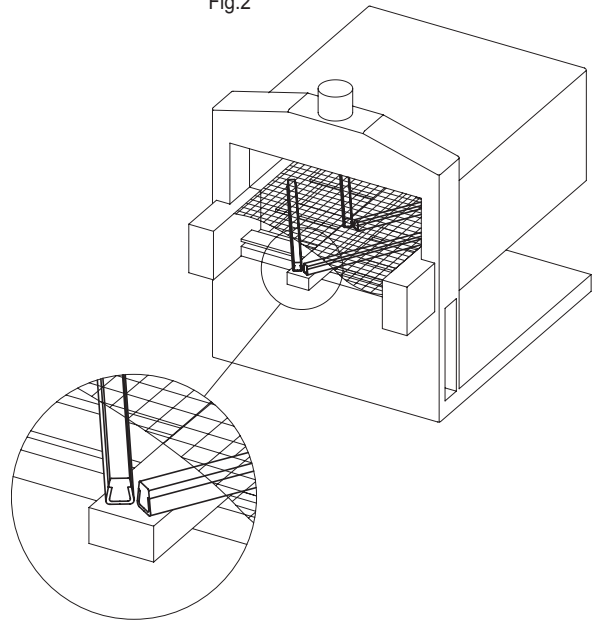

Fig.2



Code	Description	L	⚖
419206	GLP-HT-12-1500	1500	1470
419207	GLP-HT-12-3000	3000	2880

GUIDE PROFILE

Polyethylene based (HMWPE) technopolymer, natural colour.

BRACKET

AlSi 304 stainless steel.

FEATURES AND APPLICATIONS

GLR guide rail is used to guide very unstable products on conveyor belts, such as bottles (Fig.1) or cans (Fig.2), avoiding rotation, without leaving traces on the containers.

High molecular weight polyethylene (HMWPE) has a high wear resistance; it is particularly suitable for high-speed movements due to its low coefficient of friction.

It can be used with GLP-12 guide rail.

Supplied in bars of 1500 or 3000 mm length.

ACCESSORIES ON REQUEST

- Guide rail clamps MPG-T-S, MPG-2T, MPG-T.
- End brackets for linear guide rails TGLT.



Fig.1

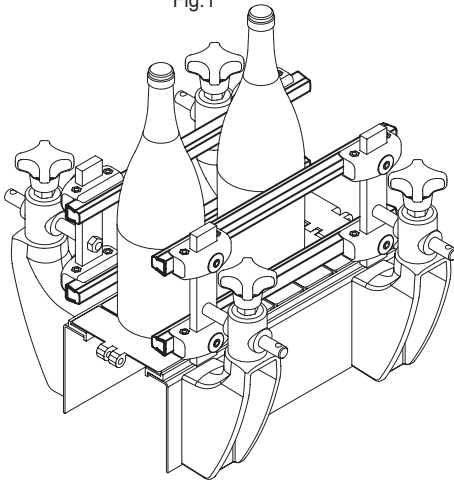
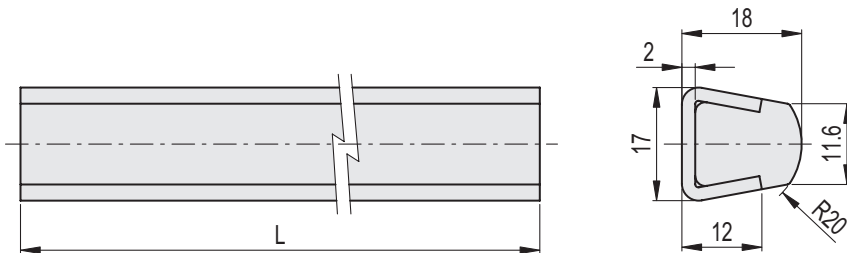
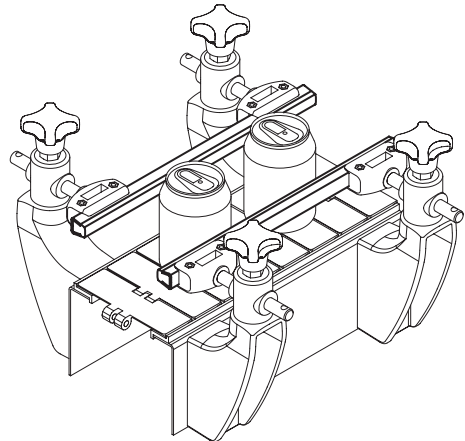

Fig.2



Code	Description	L	⚖
419217	GLR-12-3000	3000	2070
419216	GLR-12-1500	1500	1038

GUIDE PROFILE

Polyethylene based (HMWPE) technopolymer, natural colour.

BRACKET

AISI 304 stainless steel.

FEATURES AND APPLICATIONS

GLS guide rail with shaped profile is used for the side guide of products with different dimensions on conveyor belts (Fig.1), without leaving traces on the containers.

High molecular weight polyethylene (HMWPE) has a high wear resistance; it is particularly suitable for high-speed movements due to its low coefficient of friction.

They are generally used with GLT or GLP-12 guide rails (Fig.2) in case of products with important vertical dimensions.

Supplied in bars of 1500 or 3000 mm length.

ACCESSORIES ON REQUEST

- Guide rail clamps MPG-T-S, MPG-2T, MPG-T.
- End brackets for linear guide rails TGLT.



Fig.1

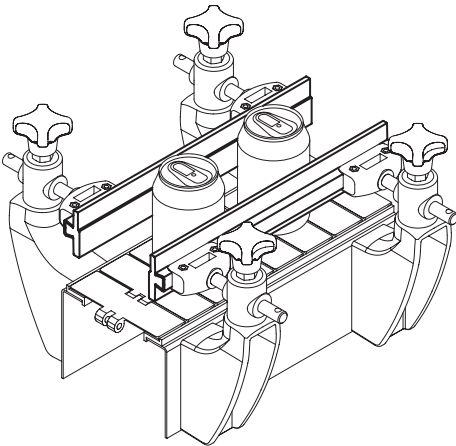
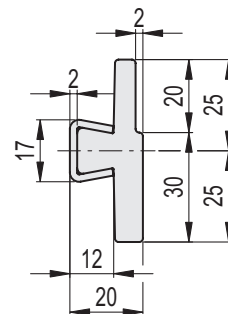
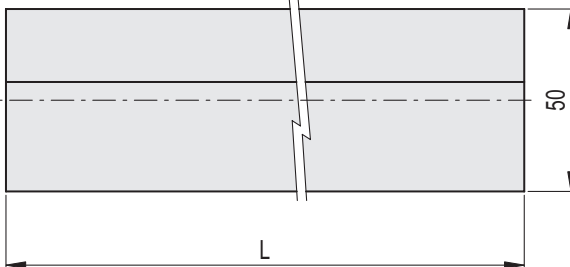
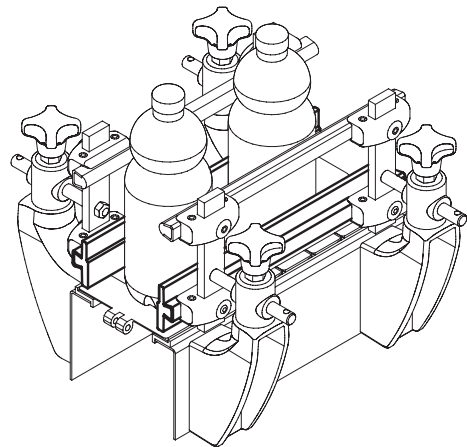

Fig.2



Code	Description	L	⚖
419211	GLS-50-30-1500	1500	1553
419212	GLS-50-30-3000	3000	2070

GUIDE PROFILE

Polyethylene based (HMWPE) technopolymer, natural colour.

BRACKET

AlSi 304 stainless steel

FEATURES AND APPLICATIONS

GLT guide rail for the side guide of products with a good stability on conveyor belts (Fig.1), without leaving traces on the containers. High molecular weight polyethylene (HMWPE) has a high wear resistance; it is particularly suitable for high-speed movements due to its low coefficient of friction. Supplied in bars of 1500 or 3000 mm length.

SPECIAL EXECUTIONS ON REQUEST

Guide rails in blue colour RAL 5005.

ACCESSORIES ON REQUEST

- Guide rail clamps MPG-T, MPG-2T, MPG-T-S.
- End brackets for linear guide rails TGLT.



Fig.1

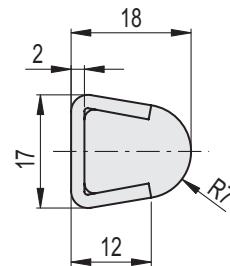
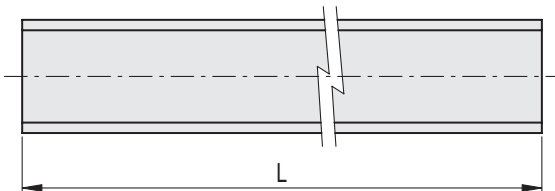
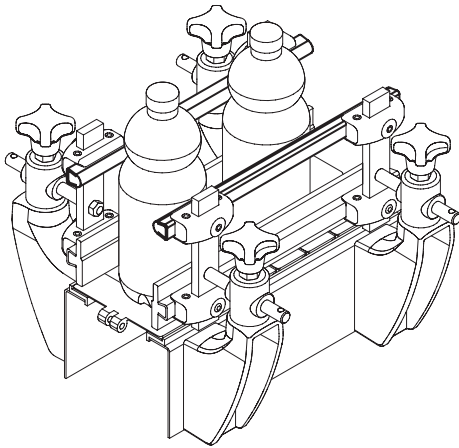

Code	Description	L	ΔΔ
419197	GLT-14R7-3000	3000	2070
419196	GLT-14R7-1500	1500	1038

GUIDE PROFILE

Polyethylene based (HMWPE) technopolymer, natural colour.

BRACKET

AISI 304 stainless steel

FEATURES AND APPLICATIONS

The GLT side guide is used to laterally guide products with good stability (Fig.1) on the conveyor belts, without leaving traces on the containers.

Generally used in situations where you want to avoid tearing product labels.

High molecular weight polyethylene (HMWPE) has a high wear resistance; it is particularly suitable for high-speed movements due to its low coefficient of friction.

Supplied in bars of 1500 or 3000 mm length.

ACCESSORIES ON REQUEST

Guide rail clamps: MPG-T, MPG-2T, MPG-T-S.



Fig.1

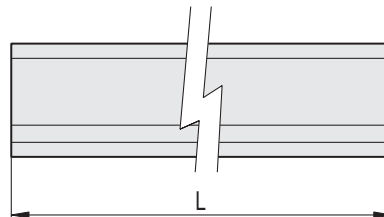
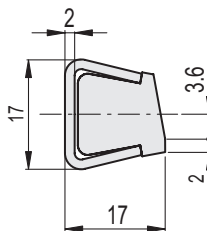
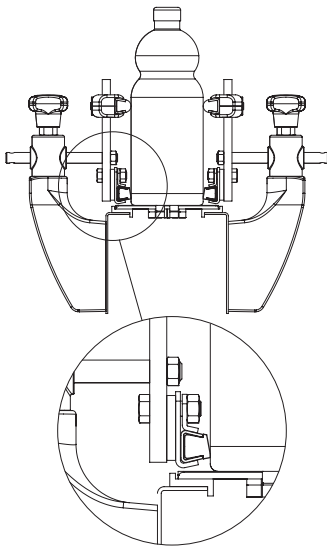

Code	Description	L	⚖
419338	GLL-2-1500	1500	1038
419339	GLL-2-3000	3000	2076

MATERIAL

Polypropylene based (PP) technopolymer, grey colour, matte finish.

FEATURES AND APPLICATIONS

The TGLT end cap is used to close the ends of the linear side guides. GLP, GLP-HT, GLR, GLS, GLT (Fig. 1). Press-fit assembly

Fig.1

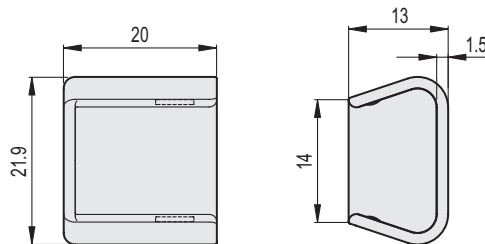
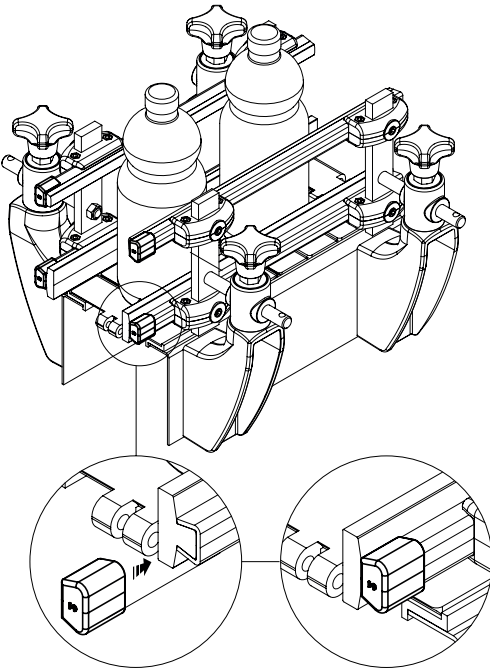

Code	Description	⚖️
419781	TGLT-13-22	2

MATERIAL

Polyethylene based (HMWPE) technopolymer, black colour.

STANDARD EXECUTIONS

- **GLC-20:** with ledge 20 mm.
- **GLC-40:** with ledge 40 mm.

FEATURES AND APPLICATIONS

GLC guide rails are used for the side guide of products with different vertical dimensions on conveyor belts.

High molecular weight polyethylene (HMWPE) has a high wear resistance; it is particularly suitable for high-speed movements due to its low coefficient of friction.

Depending on the product to transport, it is recommended to use:

- GLC-20: for the guide of products with limited vertical dimensions (Fig.1);
- GLC-40: for the guide of products with important vertical dimensions (Fig.2);

Supplied in bars of 1500 or 3000 mm length.

SPECIAL EXECUTIONS ON REQUEST

Guide rails in different colours.

ACCESSORIES ON REQUEST

Guide rail clamps MPG-2S (see page -).

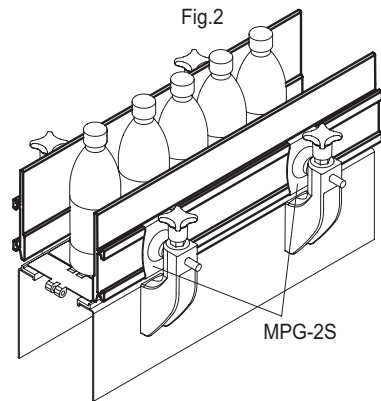
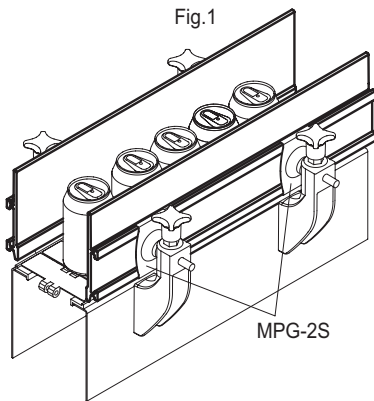
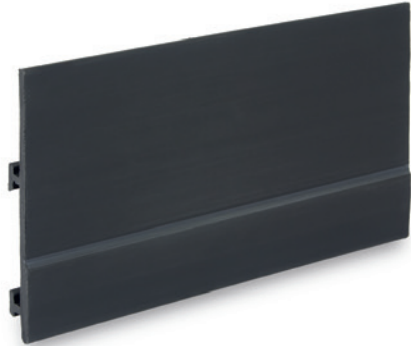

GLC-20

GLC-40

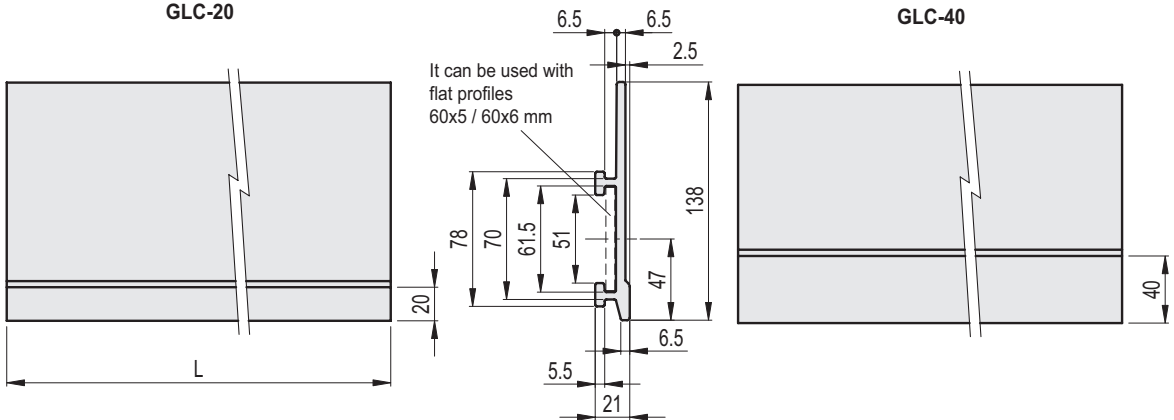

GLC-20

Code	Description	L	Δ
419195	GLC-138-20-1500	1500	1650
419191	GLC-138-20-3000	3000	3300

GLC-40

Code	Description	L	Δ
419194	GLC-138-40-1500	1500	1650
419192	GLC-138-40-3000	3000	3300

MATERIAL

Glass-fibre reinforced polyamide based (PA) technopolymer, black colour, matte finish.

STANDARD EXECUTIONS

AISI 304 stainless steel cylindrical head screws with hexagon socket, nickel-plated brass nuts.

- **MPG-T**: for both the standard trapezoidal guides.
- **MPG-C**: for round guide.
- **MPG-R**: for rectangular guide.

FEATURES AND APPLICATIONS

MPG-T execution can be used with the side guides having an AISI 304 stainless steel bracket of thickness 1.5 or 2 mm.

ASSEMBLY INSTRUCTIONS

- Mount the guide rail clamp on the support bar (dimension 25x8 mm), the assembly consists in inserting the bar into the specific clamp slot (Fig.1).
- Insert the guide into the clamp housing and then clamp the screws (Fig.2).
- Set the height of the clamp and clamp by means of a M8 screw, not supplied (Fig.3).

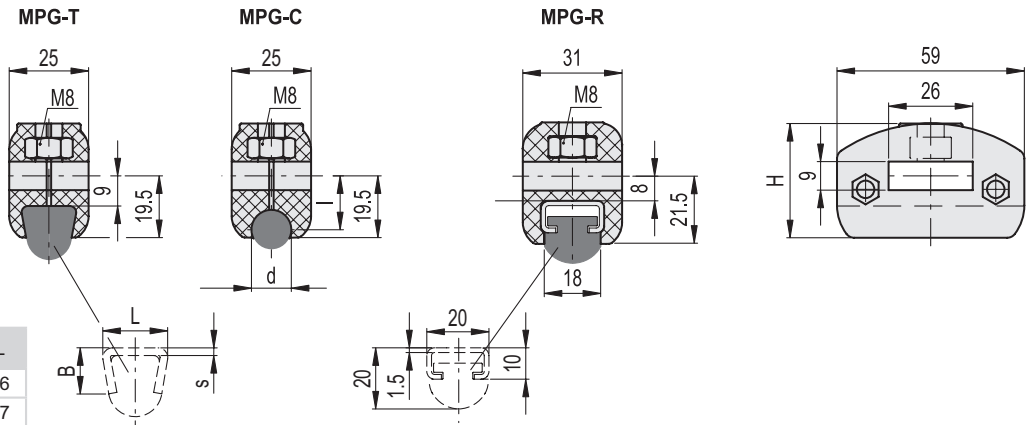
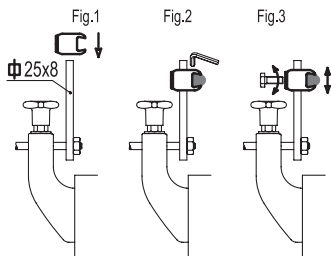

s	B	L
1.5	17.5	16
2	18	17

Code	Description	d	H	l	⚖
419688	MPG-T	-	36	-	46
419749	MPG-C-8	8	36	16	44
419788	MPG-C-10	10	36	15	45
419687	MPG-C-12	12	36	15	46
419787	MPG-C-14	14	36	15	47
419698	MPG-R	-	38	-	50

MATERIAL

AISI 304 stainless steel.

STANDARD EXECUTIONS

- **MPG-P (d)**: with threaded hole.
- **MPG-P (d1)**: with threaded pin.

FEATURES AND APPLICATIONS

MPG-P fixing pins are generally used in combination with guide rail clamps MPG-R-AZ, MPG-R-SST, MPG-S or with profiles used PRA-GLB, PRB-GLB to fix the side guides to the guide rail brackets. SPR. e SPR.V.

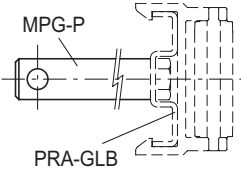

MPG-P (d)

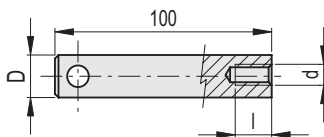

MPG-P (d1)

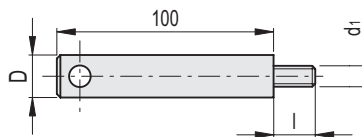

MPG-P (d)

Code	Description	d	D	l	Δ _Δ
419690	MPG-P12-M8	M8	12	20	78
419691	MPG-P14-M8	M8	14	20	110
419692	MPG-P16-M8	M8	16	20	130

MPG-P (d1)

Code	Description	d1	D	l	Δ _Δ
419511	MPG-P12-M10x17	M10	12	17	94
419512	MPG-P14-M10x17	M10	14	17	126
419513	MPG-P16-M10x17	M10	16	17	162

MATERIAL

Glass-fibre reinforced polyamide based (PA) technopolymer, black colour, matte finish.

STANDARD EXECUTIONS

AISI 304 stainless steel washers.

- **MPG-2T**: housings for standard trapezoidal guides with housing for clamping nut (M10).
- **MPG-2T-P**: housings for standard trapezoidal guides, with AISI 304 stainless steel pin and clamping nut (M10).
- **MPG-2C**: housings for round guides with housing for clamping nut (M10).
- **MPG-2C-P**: housings for round guides, with AISI 304 stainless steel pin and clamping nut (M10).
- **MPG-2R**: housings for rectangular guides with housing for clamping nut (M10).
- **MPG-2R-P**: housings for rectangular guides, with AISI 304 stainless steel pin and clamping nut (M10).
- **MPG-2S**: housings for smooth side guides with AISI 304 stainless steel clamping nut.
- **MPG-2S-P**: housings for smooth side guides with AISI 304 stainless steel pin and clamping nut.

FEATURES AND APPLICATIONS

MPG-2T and MPG-2T-P executions can be used with the side guides having an AISI 304 stainless steel bracket of thickness 1.5 or 2 mm, simply rotating the rear plate by 90°.



MPG-2T

MPG-2T-P

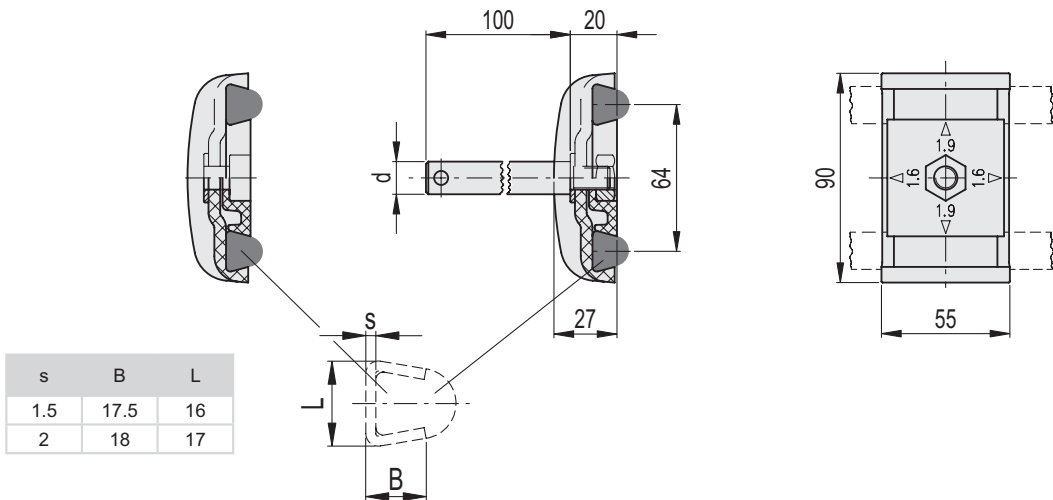

**MPG-2T
MPG-2T-P**



Code	Description	d	△
419611	MPG-2T	-	67
419684	MPG-2T-P12	12	204
419685	MPG-2T-P14	14	203
419686	MPG-2T-P16	16	202

**MPG-2C
MPG-2C-P**

INOX STAINLESS STEEL

Code	Description	d	⚖
419609	MPG-2C	-	68
419681	MPG-2C-P12	12	205
419682	MPG-2C-P14	14	204
419683	MPG-2C-P16	16	203

MPG-2C

MPG-2C-P

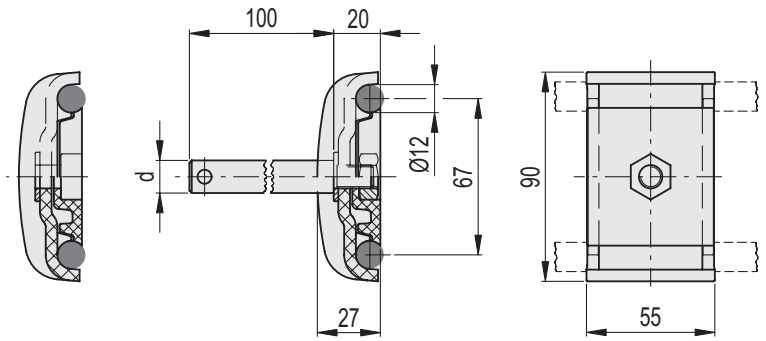

**MPG-2R
MPG-2R-P**

INOX STAINLESS STEEL

Code	Description	d	⚖
419610	MPG-2R	-	72
419694	MPG-2R-P12	12	212
419695	MPG-2R-P14	14	210
419696	MPG-2R-P16	16	208

MPG-2R

MPG-2R-P

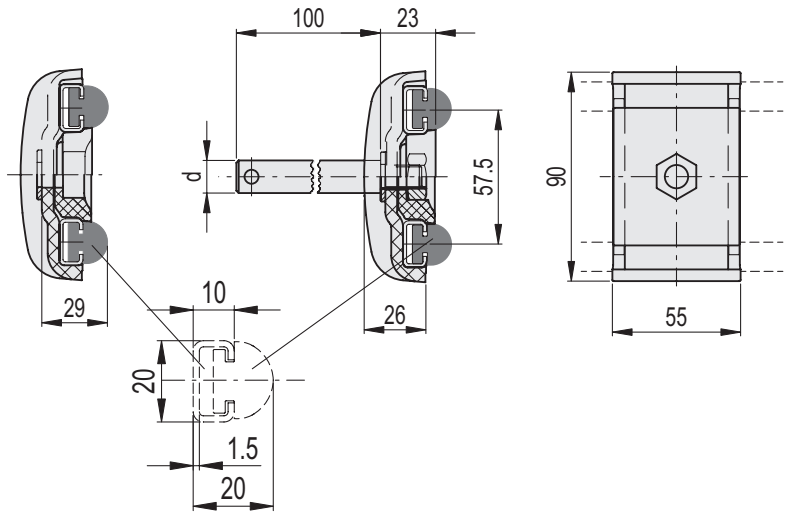

**MPG-2S
MPG-2S-P**

INOX STAINLESS STEEL

Code	Description	d	⚖
419608	MPG-2S	-	90
419678	MPG-2S-P12	12	180
419679	MPG-2S-P14	14	210
419680	MPG-2S-P16	16	240

MPG-2S

MPG-2S-P

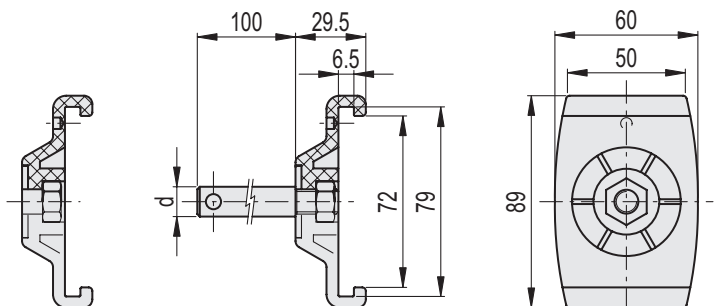

MATERIAL

Glass-fibre reinforced polyamide based (PA) technopolymer, black colour, matte finish.

STANDARD EXECUTIONS

AISI 304 stainless steel screws and nuts.

- **MPG-C-S**: housings for round guides, without pin.
- **MPG-C-S-P**: housings for round guides with AISI 304 stainless steel pin.
- **MPG-T-S**: housings for standard trapezoidal guides, without pin.
- **MPG-T-S-P**: housings for standard trapezoidal guides with AISI 304 stainless steel pin.
- **MPG-R-S**: housings for rectangular guides, without pin.
- **MPG-R-S-P**: housings for rectangular guides with AISI 304 stainless steel pin.

FEATURES AND APPLICATIONS

MPG-T-S and MPG-T-S-P executions can be used with the side guides having an AISI 304 stainless steel bracket of thickness 1.5 or 2 mm.

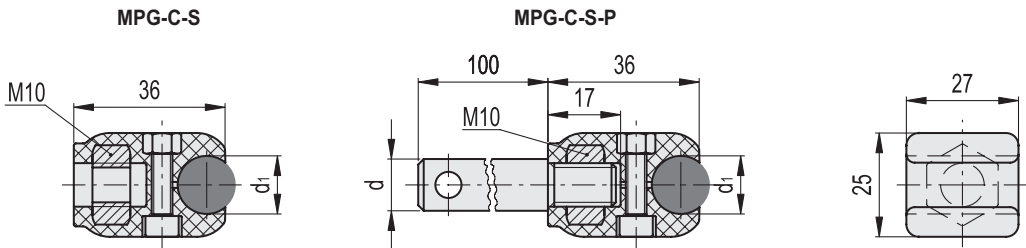

MPG-C-S



Code	Description	d1	⚖
419810	MPG-C-S-8	8	38
419811	MPG-C-S-10	10	37
419812	MPG-C-S-12	12	35
419813	MPG-C-S-14	14	35

MPG-C-S-P



Code	Description	d	d1	⚖
419798	MPG-C-S-P12-8	12	8	128
419799	MPG-C-S-P12-10	12	10	127
419800	MPG-C-S-P12-12	12	12	126
419801	MPG-C-S-P12-14	12	14	125
419802	MPG-C-S-P14-8	14	8	162
419803	MPG-C-S-P14-10	14	10	161
419804	MPG-C-S-P14-12	14	12	160
419805	MPG-C-S-P14-14	14	14	159
419806	MPG-C-S-P16-8	16	8	198
419807	MPG-C-S-P16-10	16	10	197
419808	MPG-C-S-P16-12	16	12	196
419809	MPG-C-S-P16-14	16	14	195

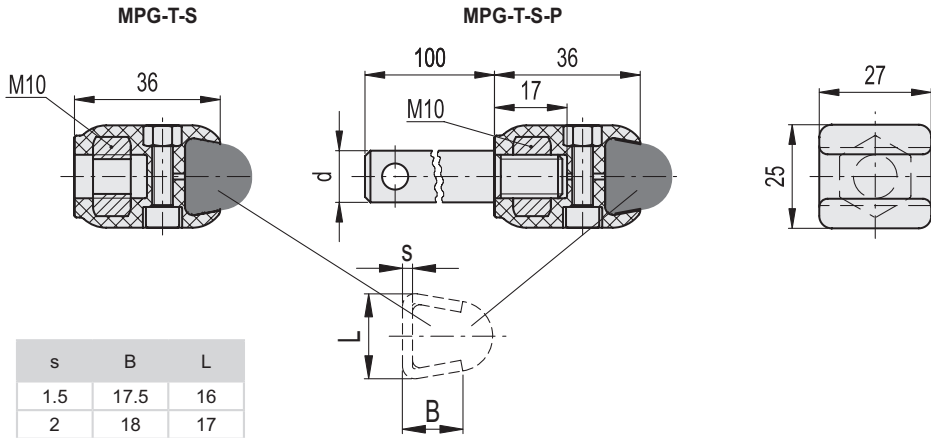

MPG-T-S



Code	Description	⚖️
419817	MPG-T-S	34

MPG-T-S-P



Code	Description	d	⚖️
419814	MPG-T-S-P12	12	125
419815	MPG-T-S-P14	14	158
419816	MPG-T-S-P16	16	195

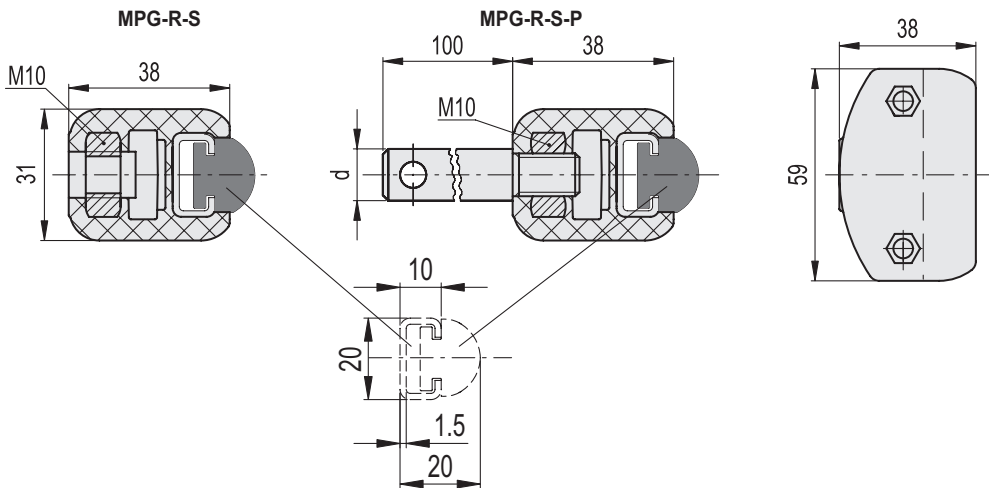

MPG-R-S



Code	Description	⚖️
419827	MPG-R-S	69

MPG-R-S-P



Code	Description	d	⚖️
419824	MPG-R-S-P12	12	125
419825	MPG-R-S-P14	14	158
419826	MPG-R-S-P16	16	195

STANDARD EXECUTIONS

- **MPG-V**: zinc-plated steel.
- **MPG-V-SST**: AISI 304 stainless steel.

FEATURES AND APPLICATIONS

MPG-V hammer head screws are used to join the different types of lateral guides to the MPG-P fixing pins.

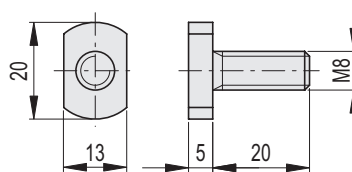
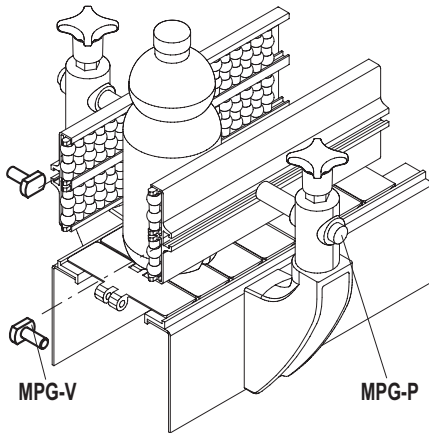

MPG-V

Code	Description	△△
419693	MPG-V-p-M8x20	16

MPG-V-SST



Code	Description	△△
419697	MPG-V-SST-p-M8x20	16

BRACKET

Glass-fibre reinforced polyamide based (PA) technopolymer, black colour, matte finish.

STANDARD EXECUTIONS

Eye screw and AISI 304 stainless steel washer.

- **SPF.V:** with glass-fibre reinforced technopolymer clamping knob, black colour, matte finish, nickel-plated brass hexagonal end for clamping by means of a key, threaded hole.
- **SPF.D:** without knob, with AISI 304 stainless steel clamping nut.

FEATURES AND APPLICATIONS

Particularly suitable when a linear positioning of the guide rail is required.

The vertical or horizontal positioning of the eye screw improves the assembly where necessary.

Maximum tightening torque for screw assembly 39 Nm.

ACCESSORIES ON REQUEST

DSG: spacer for guide rail bracket, in glass-fibre reinforced technopolymer, black colour, matte finish.

ASSEMBLY INSTRUCTIONS

- Fit the guide rail bracket (Fig. 1).
- Insert the washer into the eye screw and screw either the knob or the nut (Fig. 2).
- Insert the eye in its housing either in the horizontal or vertical position (Fig. 3).
- Insert the guide pin in its clamping hole, set the linear positioning and then fasten (Fig. 4).

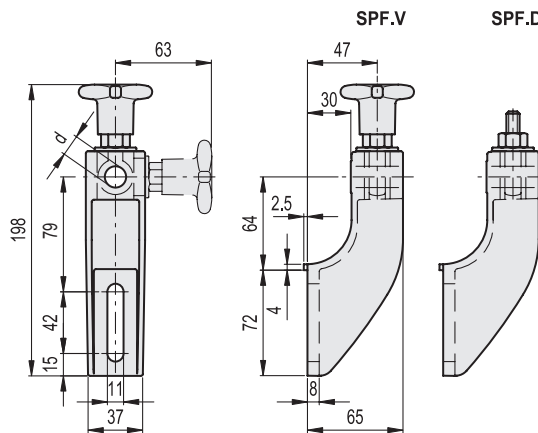
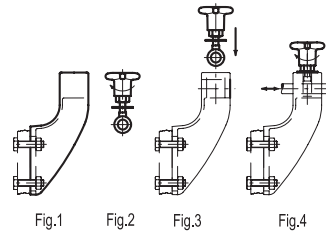

SPF.V



Code	Description	d Pin	△
419652	SPF.V-12	12	195
419654	SPF.V-14	14	190
419656	SPF.V-16	16	185

SPF.D



Code	Description	d Pin	△
419653	SPF.D-12	12	175
419655	SPF.D-14	14	170
419657	SPF.D-16	16	165

BRACKET

Glass-fibre reinforced polyamide based (PA) technopolymer, black colour, matte finish.

CLAMPING HANDWHEEL

Glass-fibre reinforced technopolymer, black colour, matte finish.

EYE SCREW AND WASHER

AISI 304 stainless steel.

BOSS

Hexagonal in nickel-plated brass for tightening by means of a key, threaded hole.

FEATURES AND APPLICATIONS

Particularly suitable when a linear positioning of the guide rail is required.

The vertical or horizontal positioning of the eye screw improves the assembly where necessary. Maximum tightening torque for screw assembly 39 Nm.

ACCESSORIES ON REQUEST

DSG: spacer for guide rail bracket, in glass-fibre reinforced technopolymer, black colour, matte finish.

ASSEMBLY INSTRUCTION

- Fit the guide rail bracket (Fig. 1).
- Insert the washer into the eye screw and screw either the knob or the nut (Fig. 2).
- Insert the eye in its housing either in the horizontal or vertical position (Fig. 3).
- Insert the guide pin in its clamping hole, set the linear positioning and then fasten (Fig. 4).

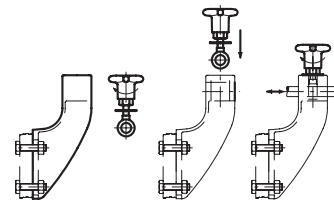
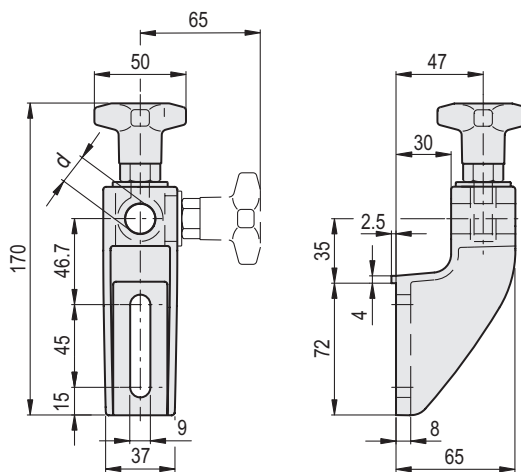

Fig.1 Fig.2 Fig.3 Fig.4



Code	Description	d	Δ
419701	SPFS.V-12	12	179
419702	SPFS.V-14	14	179
419703	SPFS.V-16	16	179

BRACKET

Glass-fibre reinforced polyamide based (PA) technopolymer, black colour, matte finish.

CLAMPING HANDWHEEL

Glass-fibre reinforced technopolymer, black colour, matte finish.

EYE SCREW AND WASHER

AISI 304 stainless steel.

BOSS

Hexagonal in nickel-plated brass for tightening by means of a key, threaded hole.

FEATURES AND APPLICATIONS

Particularly suitable when a linear positioning of the guide rail is required.

The vertical or horizontal positioning of the eye screw improves the assembly where necessary. Maximum tightening torque for screw assembly 39 Nm.

ACCESSORIES ON REQUEST

DSG: spacer for guide rail bracket, in glass-fibre reinforced technopolymer, black colour, matte finish.

ASSEMBLY INSTRUCTION

- Fit the guide rail bracket (Fig. 1).
- Insert the washer into the eye screw and screw either the knob or the nut (Fig. 2).
- Insert the eye in its housing either in the horizontal or vertical position (Fig. 3).
- Insert the guide pin in its clamping hole, set the linear positioning and then fasten (Fig. 4).

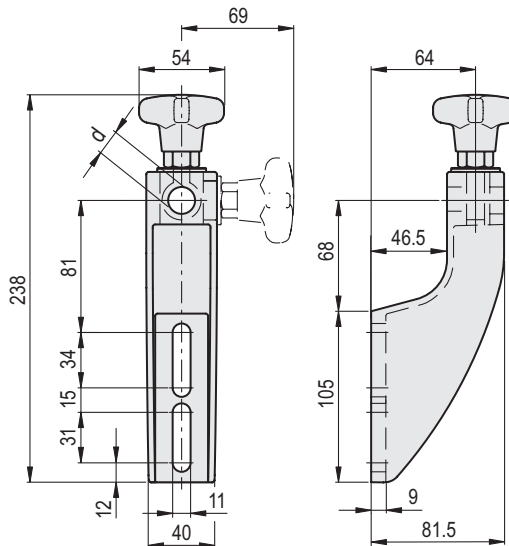
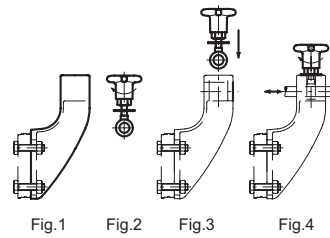

Code	Description	d	⚖️
419711	SPFM.V-12	12	246
419712	SPFM.V-14	14	246
419713	SPFM.V-16	16	246

BRACKET

Glass-fibre reinforced polyamide based (PA) technopolymer, black colour, matte finish.

CLAMPING HANDWHEEL

Glass-fibre reinforced technopolymer, black colour, matte finish.

EYE SCREW AND WASHER

AISI 304 stainless steel.

BOSS

Hexagonal in nickel-plated brass for tightening by means of a key, threaded hole.

FEATURES AND APPLICATIONS

Particularly suitable when a linear positioning of the guide rail is required.

The vertical or horizontal positioning of the eye screw improves the assembly where necessary. Maximum tightening torque for screw assembly 39 Nm.

ACCESSORIES ON REQUEST

DSG: spacer for guide rail bracket, in glass-fibre reinforced technopolymer, black colour, matte finish.

ASSEMBLY INSTRUCTION

- Fit the guide rail bracket (Fig. 1).
- Insert the washer into the eye screw and screw either the knob or the nut (Fig. 2).
- Insert the eye in its housing either in the horizontal or vertical position (Fig. 3).
- Insert the guide pin in its clamping hole, set the linear positioning and then fasten (Fig. 4).

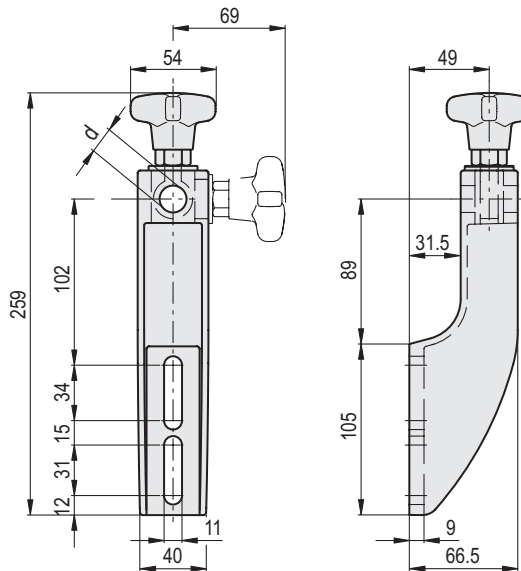
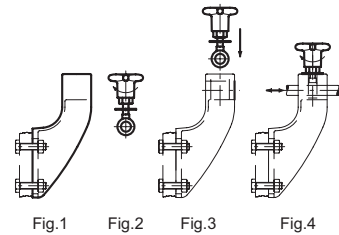

Code	Description	d	Δ
419721	SPFL.V-12	12	256
419722	SPFL.V-14	14	256
419723	SPFL.V-16	16	256

MATERIAL

Glass-fibre reinforced polyamide based (PA) technopolymer, black colour, matte finish.

STANDARD EXECUTIONS

- **DSG-A:** for use with guide rail brackets SPF, SPFS, SPR e SPR.V.
- **DSG-B:** for use with guide rail brackets SPR e SPR.V.
- **DSG-C:** for use with guide rail brackets SPFM e SPFL.

FEATURES AND APPLICATIONS

DSG spacers are used in combination with SPF, SPFS, SPFM, SPFL, SPR, SPR.V guide rail brackets when a more detached fixing positioning from the conveyor line is required.

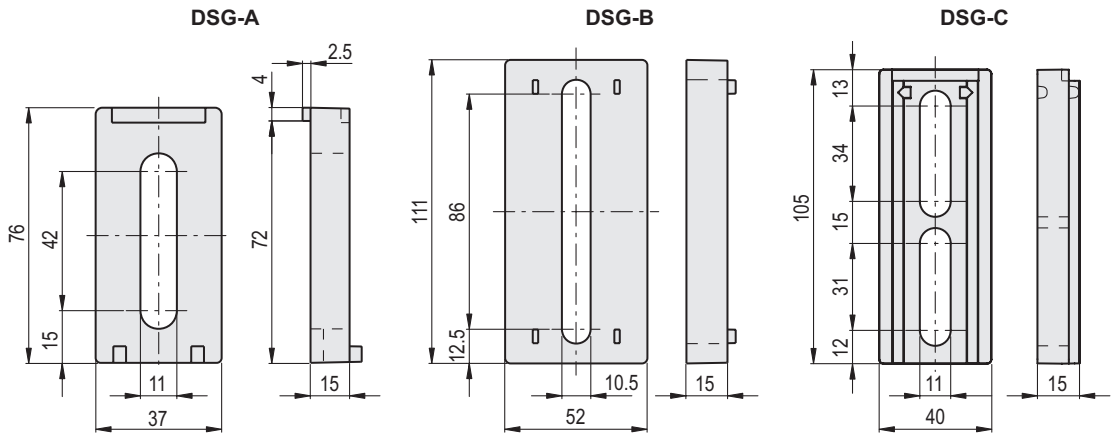

DSG-A

Code	Description	⚖️
419676	DSG-A	27.3

DSG-C

Code	Description	⚖️
419675	DSG-C	55

DSG-B

Code	Description	⚖️
419677	DSG-B	47.7

BRACKET

Glass-fibre reinforced polyamide based (PA) technopolymer, black colour, matte finish.

GUIDE RAIL CYLINDER

Glass-fibre reinforced technopolymer. Black colour, matte finish.

STANDARD EXECUTION

Eye screw, AISI 304 stainless steel nut and washer.

- **SPR-A:** with lower lip.
- **SPR-B:** without lower lip.

FEATURES AND APPLICATIONS

Particularly suitable when linear and angular positioning of the guide rail is required.

Maximum tightening torque for screw assembly 39 Nm.

ACCESSORIES ON REQUEST

DSG: spacer for guide rail bracket, in glass-fibre reinforced technopolymer, black colour, matte finish.

ASSEMBLY INSTRUCTIONS

- Fit the guide rail bracket (Fig. 1).
- Insert the eye screw in the guide rail support hole and screw the relevant nut and washer (Fig. 2).
- Assemble the guide rail cylinder on the eye (Fig. 3).
- Insert the guide pin in the guide rail cylinder hole. Set its linear and angular position and then fasten the nut (Fig. 4).

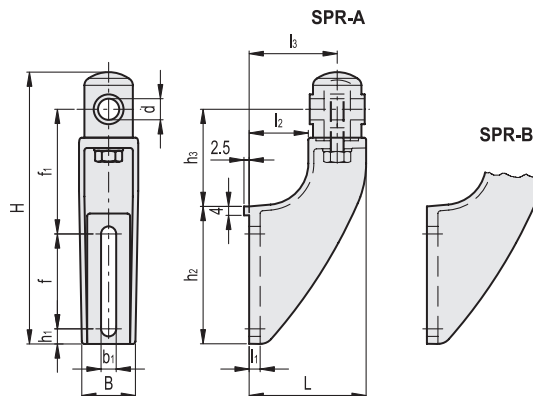
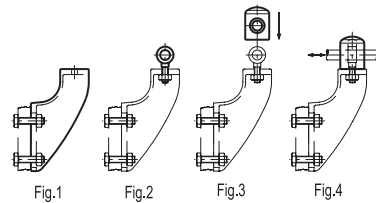

SPR-A

Code	Description	d Pin	H	L	B	f	f1	b1	h1	h2	h3	l1	l2	l3	△
419760	SPR.12-A	12	158	70	37	42	79	11	15	76	60	8	30	50	176
419761	SPR.14-A	14	158	70	37	42	79	11	15	76	60	8	30	50	175
419762	SPR.16-A	16	158	70	37	42	79	11	15	76	60	8	30	50	174

SPR-B

Code	Description	d Pin	H	L	B	f	f1	b1	h1	h2	h3	l1	l2	l3	△
419664	SPR.12-B	12	193	85	41	69	90	11	11	100	70	8	43	64	196
419665	SPR.14-B	14	193	85	41	69	90	11	11	100	70	8	43	64	195
419666	SPR.16-B	16	193	85	41	69	90	11	11	100	70	8	43	64	194

BRACKET

Glass-fibre reinforced polyamide based (PA) technopolymer, black colour, matte finish.

GUIDE RAIL CYLINDER

Glass-fibre reinforced technopolymer. Black colour, matte finish.

STANDARD EXECUTIONS

AISI 304 stainless steel eye screw.

Glass-fibre reinforced technopolymer clamping knob, black colour, matte finish, with nickel-plated brass hexagonal end for clamping by means of a key, threaded hole.

AISI 304 stainless steel screw, nut and washer for the fixing of guide rail cylinder to the bracket.

- **SPR.V-A:** with lower lip.
- **SPR.V-B:** without lower lip.

FEATURES

Particularly suitable when the angular and linear positioning needs to be executed in two different moments, for example when the distance between the guides has to be set more frequently than the angulation. Maximum tightening torque for screw assembly 39 Nm.

ACCESSORIES ON REQUEST

DSG: spacer for guide rail bracket, in glass-fibre reinforced technopolymer, black colour, matte finish.

SPECIAL EXECUTIONS ON REQUEST

AISI 304 stainless steel guide rail cylinder.

ASSEMBLY INSTRUCTIONS

- Fit the guide rail bracket (Fig. 1).
- Assemble the guide rail cylinder to the support, with screw, nut and washer (Fig. 2).
- Insert the washer on the eye screw and assemble the knob (Fig. 3).
- Insert the eye in the guide rail cylinder housing (Fig. 4).
- Insert the guide pin in the guide rail cylinder hole. Set its linear and angular position and then clamp the knob (linear positioning) and the fixing nut of guide rail cylinder (angular positioning) (Fig. 5).

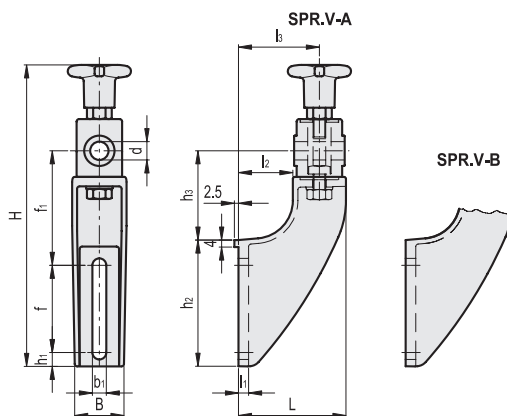
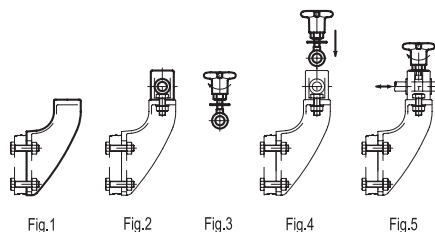

SPR.V-A

Code	Description	d Pin	H	L	B	f	f1	b1	h1	h2	h3	l1	l2	l3	⚖
419755	SPR.V-12-A	12	203	70	37	42	79	11	15	76	60	8	30	50	255
419756	SPR.V-14-A	14	203	70	37	42	79	11	15	76	60	8	30	50	250
419757	SPR.V-16-A	16	203	70	37	42	79	11	15	76	60	8	30	50	245



SPR.V-B

Code	Description	d Pin	H	L	B	f	f1	b1	h1	h2	h3	l1	l2	l3	⚖
419658	SPR.V-12-B	12	238	85	41	69	90	11	11	100	70	8	43	64	270
419659	SPR.V-14-B	14	238	85	41	69	90	11	11	100	70	8	43	64	265
419660	SPR.V-16-B	16	238	85	41	69	90	11	11	100	70	8	43	64	260



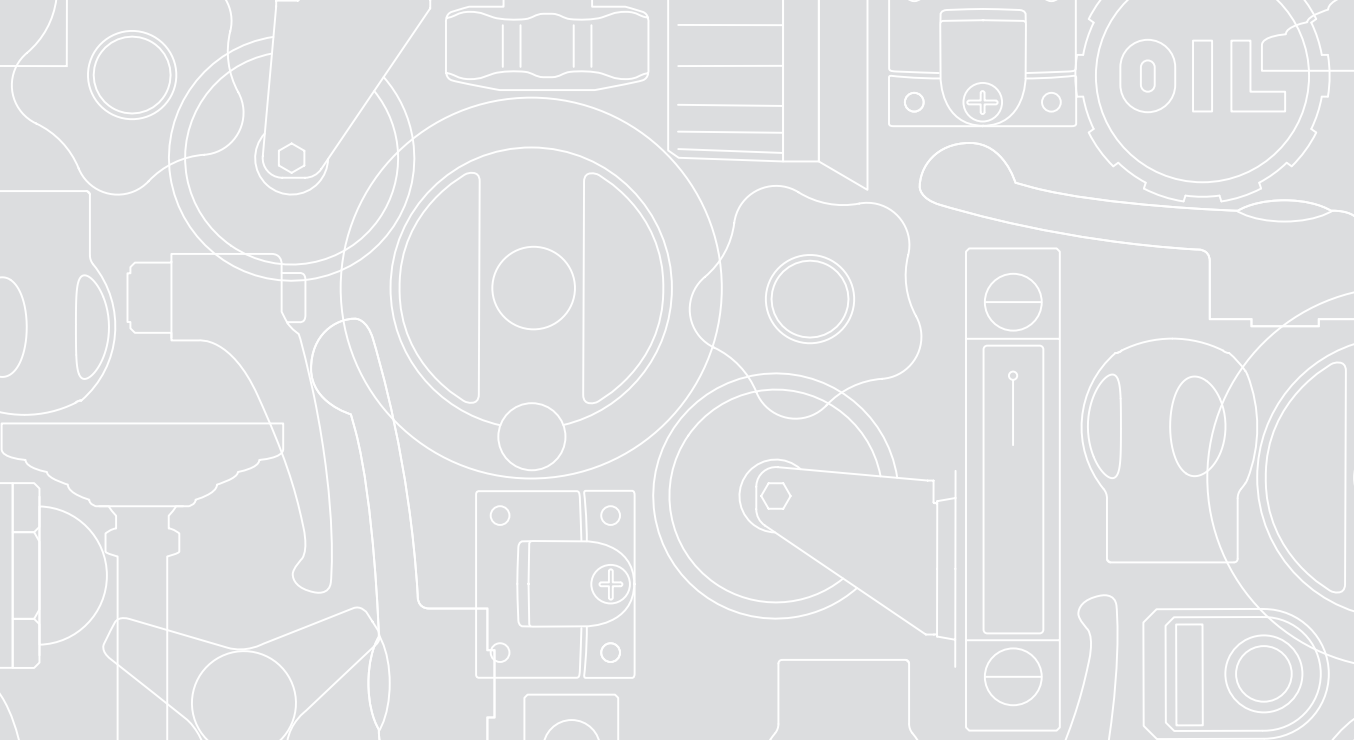

ELESA. More and more...



elesa®

ELESA S.p.A.
Via Pompei, 29
20900 Monza (MB) Italy
phone +39 039 2811.1
fax +39 039 836351
info@elesa.com

elesa.com