

MATERIAL

High-resistance reinforced phenolic based (PF) Duroplast, black colour, glossy finish.

INDICATOR HOUSING

Glass-fibre reinforced polyamide based (PA) technopolymer, black colour, matte finish.

REVOLVING HANDLE

l.301+x (see page 405) duroplast, black colour, glossy finish.

STANDARD EXECUTION

Black-oxide steel hub, not drilled.

See table for maximum permissible boring diameter d max and depth p max.

INDICATOR CHOICE (TO BE ORDERED SEPARATELY)

VD-XX+I solid handwheels can be used with analogue gravity indicators type GA01 - GA02 - GA05 (see page 464).

See also "Assembly instructions" for gravity indicators (on page 462).

SPECIAL EXECUTIONS ON REQUEST

Execution with hand reset: the indicator reading can be reset in any position within the positioning range, so that further readings can be referred to the reset point. To reset the reading turn the indicator housing until the two pointers reach the zero position, by keeping the indicator body still. By so doing the relevant position (phase) between the indicator and the handwheel can be changed by a small effort, but enough to avoid any accidental phase displacement.



ELESA Original design

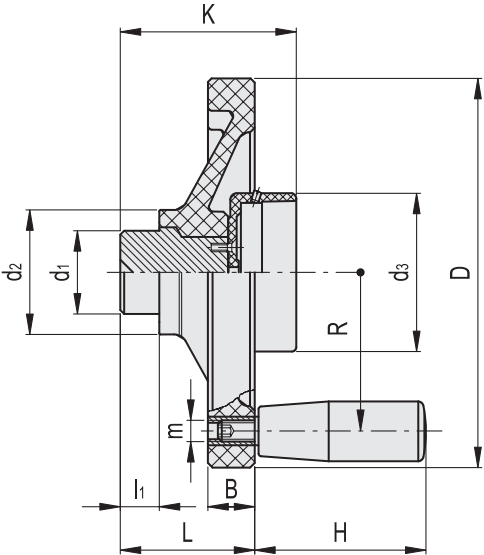
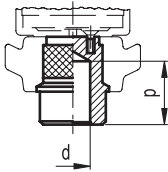

Code	Description	D	L	dmax	pmax	d1	d2	d3	l1	B	K	H	m	R	⚖
CE.31811	VD.225-GXX5+I	225	62	34	25	49	66	122	15	23	86	90	M10	99	1630
CE.31911	VD.250-GXX5+I	250	66	34	25	49	70	122	15	25	86	90	M10	109	1880
CE.32011	VD.300-GXX5+I	300	76	42	35	58	82	122	18	25	98	90	M10	134	3170
CE.32111	VD.350-GXX5+I	350	92	42	35	58	90	122	18	38	98	100	M10	157	4340

