

**MATERIAL**

Polyamide based (PA) technopolymer, natural colour.

**FEATURES AND APPLICATIONS**

Due to the diameter of the cone being smaller than that of the screw used, the washer compresses during assembly and fits into the screw's thread, thereby preventing it from coming loose.

The product can only be removed by unscrewing the screw, so it can only be used once.

It is made entirely from insulating material that is resistant to corrosion and chemicals. It is suitable for use in automotive applications, as well as in industry, aeronautics, electronics and in all cases where weight reduction is required.

The product is tested for mechanical and dimensional performance. Slight colour variations are perfectly normal and do not affect the quality of the product.

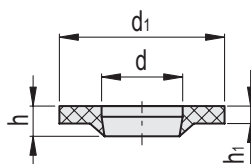

METRIC

Code	Description	d	d1	h	h1	⚖
505401	WAL-4.1-TP-N	4	9	3	1.5	1
505411	WAL-5.0-TP-N	5	10	3	1.5	1
505421	WAL-6.3-TP-N	6.5	12.5	2.5	1.5	1
505431	WAL-8.2-TP-N	8	16	3.5	1.5	1
505441	WAL-10.5-TP-N	10.5	15	4.5	2	1