

- 1
- 2
- 3
- 4
- 5
- 6
- 7
- 8
- 9
- 10
- 11
- 12
- 13
- 14
- 15
- 16
- 17
- 18

MATERIAL

Glass-fibre reinforced polyamide based (PA) technopolymer, black colour, matte finish.

BOSS CAP

Acetal resin based (POM) technopolymer, black colour, matte finish, push-fit assembly.

RING

Matte anodised aluminium.
(ELESA Original design - Reg. U.S. Pat. & TM Off.)

STANDARD EXECUTIONS

- Black-oxide steel boss, standard reamed hole (see page A-16).
- **VDT.**: without handle.
- **VDT+I**: with revolving handle I.621+x (see page 665) in technopolymer.
- **VDT+IR**: with fold-away handle IR.620 (see page 674) in technopolymer.

ACCESSORIES ON REQUEST

Axial retaining washer GN 184 (see page 1021).

SPECIAL EXECUTIONS ON REQUEST

Bosses with hole and keyway in compliance with ANSI B17.1-1967 tolerance (see page A-16).
To order the handwheel with keyway complete code and description with the index -K (i.e. 9170307-K VDT.100 A-3/8-K).

OTHER EXECUTIONS ON REQUEST

Standard metric holes.

ERGONOMY

The rim with internal rear scallops makes the grip and the manoeuvre of the handwheel easier.



ELESA Original design 2003

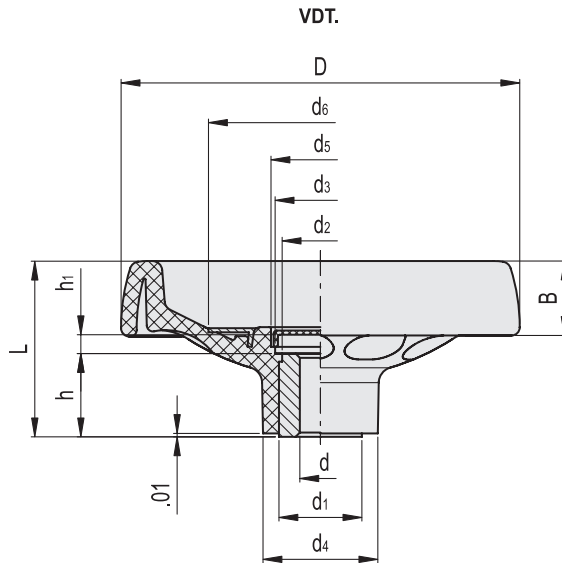
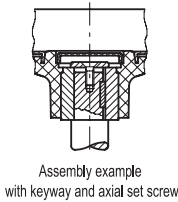

VDT.

INCH

Code	Description	D	d	L	B	d1	d2	d3	d4	d5	d6	h	h1	C# [ft·lb]	L# [ft·lb]	⚖️
9170307	VDT.100 A-3/8	3.94	0.375	1.93	0.87	0.87	0.79	1.02	1.26	1.1	2.13	0.87	0.22	133	15	0.34
9170507	VDT.125 A-3/8	4.92	0.375	2.24	0.94	1.02	0.94	1.1	1.42	1.22	2.76	1.06	0.28	147	17	0.63
9170707	VDT.160 A-1/2	6.3	0.500	2.52	1.06	1.38	1.3	1.5	1.81	1.57	3.54	1.1	0.43	295	18	1.11
9170907	VDT.200 A-5/8	7.87	0.625	2.68	1.18	1.57	1.5	1.97	2.01	2.05	4.33	1.22	0.35	442	26	1.61

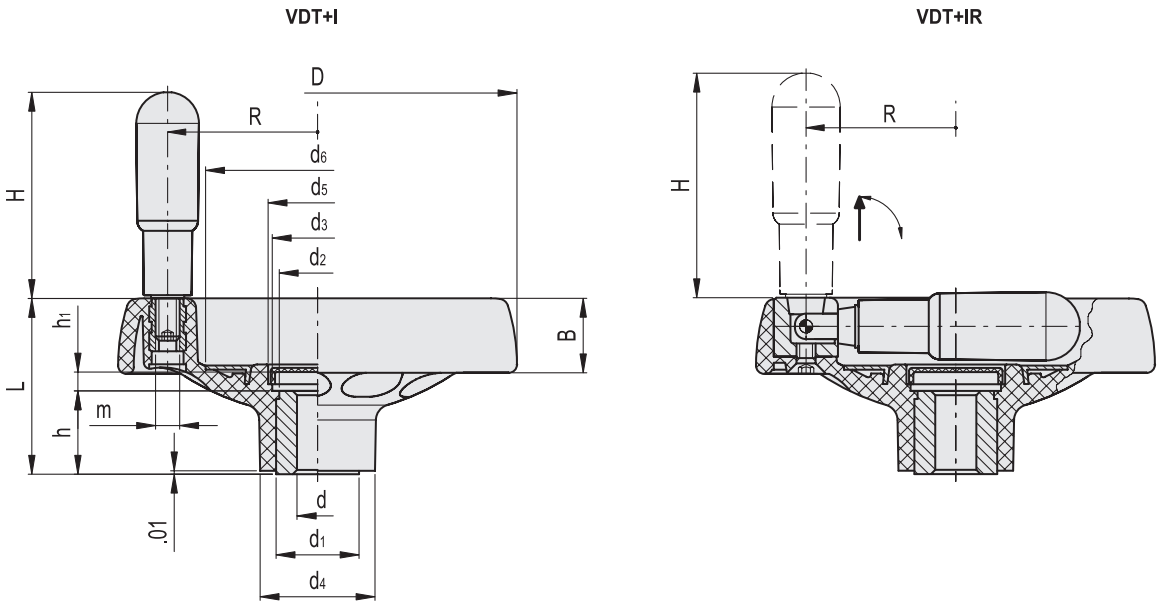

INCH

Code	Description	D	d	L	B	d1	d2	d3	d4	d5	d6	h	h1	H	m	R	C# [ft-lb]	L# [ft-lb]	⚖️
9170317	VDT.100+I A-3/8	3.94	0.375	1.93	0.87	0.87	0.79	1.02	1.26	1.1	2.13	0.87	0.22	2.36	M6	1.46	133	15	0.41
9170517	VDT.125+I A-3/8	4.92	0.375	2.24	0.94	1.02	0.94	1.1	1.42	1.22	2.76	1.06	0.28	2.56	M8	1.85	147	17	0.78
9170717	VDT.160+I A-1/2	6.3	0.500	2.52	1.06	1.38	1.3	1.5	1.81	1.57	3.54	1.1	0.43	3.15	M8	2.44	295	18	1.29
9170917	VDT.200+I A-5/8	7.87	0.625	2.68	1.18	1.57	1.5	1.97	2.01	2.05	4.33	1.22	0.35	3.54	M10	3.07	442	26	1.81

INCH

Code	Description	D	d	L	B	d1	d2	d3	d4	d5	d6	h	h1	H	R	C# [ft-lb]	L# [ft-lb]	⚖️
9170327	VDT.100+IR A-3/8	3.94	0.375	1.93	0.87	0.87	0.79	1.02	1.26	1.1	2.13	0.87	0.22	2.36	1.46	133	15	0.43
9170527	VDT.125+IR A-3/8	4.92	0.375	2.24	0.94	1.02	0.94	1.1	1.42	1.22	2.76	1.06	0.28	2.56	1.85	147	17	0.8
9170727	VDT.160+IR A-1/2	6.3	0.500	2.52	1.06	1.38	1.3	1.5	1.81	1.57	3.54	1.1	0.43	3.15	2.44	295	18	1.32
9170927	VDT.200+IR A-5/8	7.87	0.625	2.68	1.18	1.57	1.5	1.97	2.01	2.05	4.33	1.22	0.35	3.54	3.07	442	26	1.93

For maximum torque (C) and impact strength (L) see Technical Data on page A-3 A-3.

Models all rights reserved in accordance with the law. Always mention the source when reproducing our drawings and photos.