

METRIC

MATERIAL

Glass-fibre reinforced polyamide based (PA) technopolymer, RAL 9005 (C9) black colour or grey RAL 7040 (C33) colour, matte finish.

FEATURES AND APPLICATIONS

Hole reduction sleeves with spherical seats are suitable for ball diameter 'd 1' 14 mm of the base with ball joint TCC-SJB (see page -) and of the double ball joint TCC-SJD (see page -).

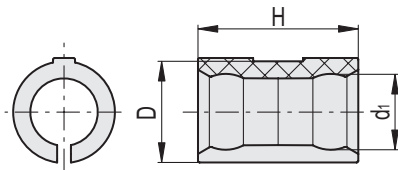
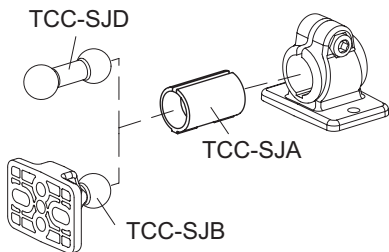

C9 RAL9005 C33 RAL7040

METRIC

Conversion Table	
1 mm = 0.039 inch	
D	
mm	inch
18	0.70

Code	Description	D	H	d1	⚖
600161-C9	TCC-SJA-18-S14-C9	18	29	14	5
600161-C33	TCC-SJA-18-S14-C33	18	29	14	5