

CLAMP

Glass-fibre reinforced polyamide based (PA) technopolymer, RAL 9005 (C9) black colour or grey RAL 7040 (C33) colour, resistant to UV rays, matte finish.

SCREWS AND NUTS (SUPPLIED)

Cylindrical-head screw with hexagon socket in AISI 304 stainless steel with anti-seizure treatment.

Self-locking nuts in AISI 304 stainless steel.

FEATURES

Clamps for tubes with a diameter of 18 ± 0.2 and 30 ± 0.2 mm.

For smaller diameter tubes, the hole reduction sleeve TCC-A can be used (ordered separately).

The "s" grub screws may be replaced by the kit TCC-KS.

TECHNICAL DATA

The resistance values shown in the table were measured during laboratory tests at ambient temperature with the screws tightened to the suggested torque "C#".

ACCESSORIES ON REQUEST (TO BE ORDERED SEPARATELY)

- TCC-A (see page -): reduction sleeves.
- TCC-KS (see page -): clamping kit.
- TCC-KV (see page -): screws and clamping nuts.
- GN 990 (see page -): connecting tubes.



ELESA Original design

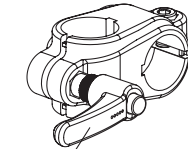
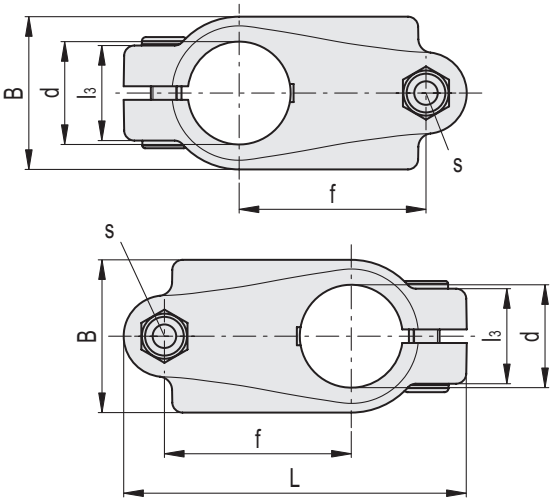

TCC-KS-ERX

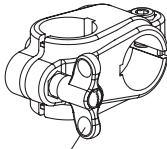

TCC-KS-EWN

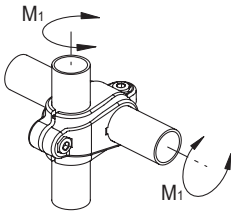
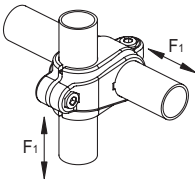

Conversion Table

1 mm = 0.039 inch

| d | |
|----|------|
| mm | inch |
| 18 | 0.70 |
| 30 | 1.17 |

C9 RAL9005 C33 RAL7040

INOX STAINLESS STEEL

METRIC

| Code | Description | d | L | B | f | l3 | s | C# [Nm] | F1* [N] | M1** [Nm] | ⚖ |
|------------|------------------|----|-------|----|------|----|----|---------|---------|-----------|-----|
| 600121-C9 | TCC-CR-18-18-C9 | 18 | 65 | 29 | 34 | 21 | M6 | 5 | 2150 | 17 | 41 |
| 600121-C33 | TCC-CR-18-18-C33 | 18 | 65 | 29 | 34 | 21 | M6 | 5 | 2150 | 17 | 41 |
| 600221-C9 | TCC-CR-30-30-C9 | 30 | 100.5 | 45 | 54.5 | 27 | M8 | 12 | 1350 | 21 | 123 |
| 600221-C33 | TCC-CR-30-30-C33 | 30 | 100.5 | 45 | 54.5 | 27 | M8 | 12 | 1350 | 21 | 123 |

Suggested torque for screw assembly.

* Resistance to tube pull out

** Resistance to tube rotation