

**CLAMP**

Glass-fibre reinforced polyamide based (PA) technopolymer, RAL 5005 blue colour, matte finish.



Produced from FDA compliant raw material (FDA CFR.21 and EU 10/2011).

**SCREWS AND NUTS (SUPPLIED)**

Cylindrical-head screw with hexagon socket in AISI 304 stainless steel with anti-seizure treatment.



Self-locking nuts in AISI 304 stainless steel.

**FEATURES AND APPLICATIONS**

Clamps for tubes with a diameter of 18 ± 0.2 and 30 ± 0.2 mm.



For smaller diameter tubes, the hole reduction sleeve TCC-A can be used (ordered separately).



The "s" grub screws may be replaced by the kit TCC-KS.



The RAL 5005 blue colour is easily visible in case of accidental food contamination.



Particularly suitable for applications in the food and pharmaceutical industries.

**TECHNICAL DATA**

The resistance values shown in the table were measured during laboratory tests at ambient temperature with the screws tightened to the suggested torque "C#".

**ACCESSORIES ON REQUEST (TO BE ORDERED SEPARATELY)**

- TCC-A (see page -): reduction sleeves.
- TCC-KS (see page -): clamping kit.
- TCC-KV (see page -): screws and clamping nuts.
- GN 990 (see page -): connecting tubes.



ELESA Original design

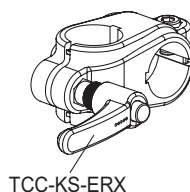
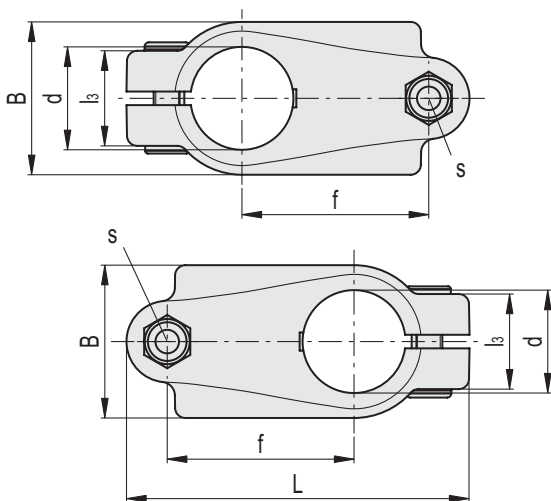

TCC-KS-ERX

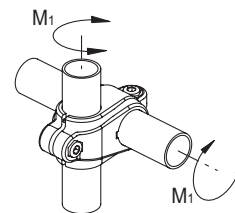
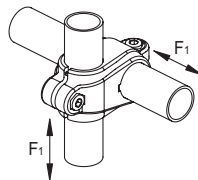

TCC-KS-EWN

**Conversion Table**

1 mm = 0.039 inch

| d | |
|----|------|
| mm | inch |
| 18 | 0.70 |
| 30 | 1.17 |

| Code | Description | d | L | B | f | l3 | s | C# [Nm] | F1* [N] | M1** [Nm] | ⚖️ |
|--------|-----------------|----|-------|----|------|----|----|------------|------------|--------------|-----|
| 191121 | TCC-CR-18-18-VD | 18 | 65 | 29 | 34 | 21 | M6 | 5 | 2150 | 17 | 41 |
| 191221 | TCC-CR-30-30-VD | 30 | 100.5 | 45 | 54.5 | 27 | M8 | 12 | 1350 | 21 | 123 |

Suggested torque for screw assembly.

* Resistance to tube pull out

** Resistance to tube rotation