

- 1
 - 2
 - 3
 - 4
 - 5
 - 6
 - 7
 - 8
 - 9
 - 10
 - 11
 - 12
 - 13
 - 14
 - 15
 - 16
 - 17
 - 18
 - 19
- Standard machine parts

MATERIAL

Polyamide based (PA) technopolymer, natural colour.

FEATURES AND APPLICATIONS

The screw is similar in shape and size to that specified in DIN 551 or ISO 4766.

As it has no head, it can be inserted fully into the hole, sitting flush with the surface.

It is made entirely from insulating material that is resistant to corrosion and chemicals. It is suitable for applications in industry, aeronautics and electronics, and in all cases where weight reduction is required.

The product is tested for mechanical and dimensional performance. Slight colour variations are perfectly normal and do not affect the quality of the product.

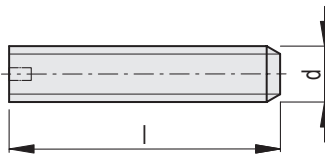

METRIC

Code	Description	d	l	Maximum tightening torque [Nm]	⚖️
504501	SRD.551-M4X10-TP-N	M4	10	0.15	1
504502	SRD.551-M4X16-TP-N	M4	16	0.15	1
504503	SRD.551-M4X20-TP-N	M4	20	0.15	1
504504	SRD.551-M4X25-TP-N	M4	25	0.15	1
504511	SRD.551-M5X16-TP-N	M5	16	0.25	1
504512	SRD.551-M5X20-TP-N	M5	20	0.25	1.5
504513	SRD.551-M5X25-TP-N	M5	25	0.25	1.5
504514	SRD.551-M5X30-TP-N	M5	30	0.25	2
504515	SRD.551-M5X40-TP-N	M5	40	0.25	2
504516	SRD.551-M5X50-TP-N	M5	50	0.25	2.5
504521	SRD.551-M6X16-TP-N	M6	16	0.5	1.5
504522	SRD.551-M6X20-TP-N	M6	20	0.5	1.5
504523	SRD.551-M6X25-TP-N	M6	25	0.5	2
504524	SRD.551-M6X30-TP-N	M6	30	0.5	2.5
504525	SRD.551-M6X40-TP-N	M6	40	0.5	3
504526	SRD.551-M6X50-TP-N	M6	50	0.5	3.5
504531	SRD.551-M8X20-TP-N	M8	20	1.9	2.5
504532	SRD.551-M8X25-TP-N	M8	25	1.9	2.5
504533	SRD.551-M8X30-TP-N	M8	30	1.9	3
504534	SRD.551-M8X40-TP-N	M8	40	1.9	4
504535	SRD.551-M8X50-TP-N	M8	50	1.9	4.5
504541	SRD.551-M10X20-TP-N	M10	20	3	4
504542	SRD.551-M10X25-TP-N	M10	25	3	4.5
504543	SRD.551-M10X30-TP-N	M10	30	3	5
504544	SRD.551-M10X40-TP-N	M10	40	3	6
504545	SRD.551-M10X50-TP-N	M10	50	3	7.5
504546	SRD.551-M10X60-TP-N	M10	60	3	9
504551	SRD.551-M12X20-TP-N	M12	20	4.7	5.5
504552	SRD.551-M12X30-TP-N	M12	30	4.7	6.5
504553	SRD.551-M12X40-TP-N	M12	40	4.7	8
504554	SRD.551-M12X50-TP-N	M12	50	4.7	10
504555	SRD.551-M12X60-TP-N	M12	60	4.7	11.5
504556	SRD.551-M12X80-TP-N	M12	80	4.7	14.5
504561	SRD.551-M16X20-TP-N	M16	20	9.5	9.5
504562	SRD.551-M16X30-TP-N	M16	30	9.5	11.5
504563	SRD.551-M16X40-TP-N	M16	40	9.5	14
504564	SRD.551-M16X50-TP-N	M16	50	9.5	16
504565	SRD.551-M16X60-TP-N	M16	60	9.5	19
504566	SRD.551-M16X80-TP-N	M16	80	9.5	24
504567	SRD.551-M16X100-TP-N	M16	100	9.5	30