

MATERIAL

Polyamide based (PA) technopolymer, natural colour.

FEATURES AND APPLICATIONS

The wing nut screw is similar in shape and size to that specified in DIN 316 and requires no tools for tightening.

It is made entirely from insulating material that is resistant to corrosion and chemicals. It is suitable for applications in industry, aeronautics and electronics, and in all cases where weight reduction is required.

The product is tested for mechanical and dimensional performance. Slight colour variations are perfectly normal and do not affect the quality of the product.

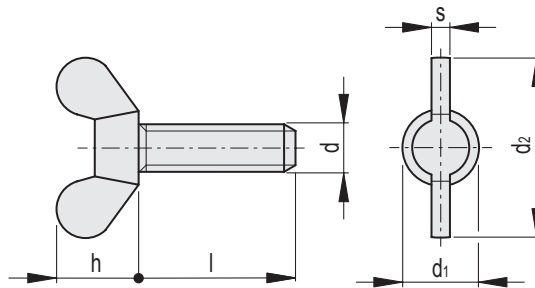
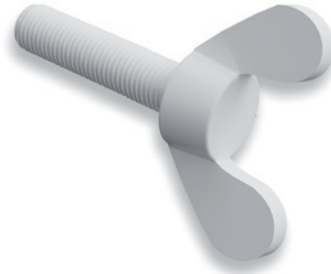

METRIC

| Code | Description | d | d1 | d2 | l | s | h | Maximum tightening torque [Nm] | ⚖️ |
|--------|---------------------|-----|------|------|----|-----|------|--------------------------------|-----|
| 504301 | SRD.316-M4X10-TP-N | M4 | 8 | 17.5 | 10 | 1.5 | 8.5 | 0.15 | 1 |
| 504302 | SRD.316-M4X16-TP-N | M4 | 8 | 17.5 | 16 | 1.5 | 8.5 | 0.15 | 1 |
| 504303 | SRD.316-M4X20-TP-N | M4 | 8 | 17.5 | 20 | 1.5 | 8.5 | 0.15 | 1 |
| 504304 | SRD.316-M4X25-TP-N | M4 | 8 | 17.5 | 25 | 1.5 | 8.5 | 0.15 | 1 |
| 504311 | SRD.316-M5X16-TP-N | M5 | 10.5 | 22.5 | 16 | 2 | 11 | 0.25 | 1 |
| 504312 | SRD.316-M5X20-TP-N | M5 | 10.5 | 22.5 | 20 | 2 | 11 | 0.25 | 1 |
| 504313 | SRD.316-M5X25-TP-N | M5 | 10.5 | 22.5 | 25 | 2 | 11 | 0.25 | 1.5 |
| 504314 | SRD.316-M5X30-TP-N | M5 | 10.5 | 22.5 | 30 | 2 | 11 | 0.25 | 1.5 |
| 504315 | SRD.316-M5X40-TP-N | M5 | 10.5 | 22.5 | 40 | 2 | 11 | 0.25 | 2 |
| 504316 | SRD.316-M5X50-TP-N | M5 | 10.5 | 22.5 | 50 | 2 | 11 | 0.25 | 2.5 |
| 504321 | SRD.316-M6X16-TP-N | M6 | 12.5 | 28 | 16 | 2.5 | 13.5 | 0.5 | 1.5 |
| 504322 | SRD.316-M6X20-TP-N | M6 | 12.5 | 28 | 20 | 2.5 | 13.5 | 0.5 | 1.5 |
| 504323 | SRD.316-M6X25-TP-N | M6 | 12.5 | 28 | 25 | 2.5 | 13.5 | 0.5 | 2 |
| 504324 | SRD.316-M6X30-TP-N | M6 | 12.5 | 28 | 30 | 2.5 | 13.5 | 0.5 | 2 |
| 504325 | SRD.316-M6X40-TP-N | M6 | 12.5 | 28 | 40 | 2.5 | 13.5 | 0.5 | 2.5 |
| 504326 | SRD.316-M6X50-TP-N | M6 | 12.5 | 28 | 50 | 2.5 | 13.5 | 0.5 | 3 |
| 504331 | SRD.316-M8X20-TP-N | M8 | 14 | 30.5 | 20 | 3 | 15 | 1.9 | 2 |
| 504332 | SRD.316-M8X25-TP-N | M8 | 14 | 30.5 | 25 | 3 | 15 | 1.9 | 2.5 |
| 504333 | SRD.316-M8X30-TP-N | M8 | 14 | 30.5 | 30 | 3 | 15 | 1.9 | 3 |
| 504334 | SRD.316-M8X40-TP-N | M8 | 14 | 30.5 | 40 | 3 | 15 | 1.9 | 3.5 |
| 504335 | SRD.316-M8X50-TP-N | M8 | 14 | 30.5 | 50 | 3 | 15 | 1.9 | 4.5 |
| 504341 | SRD.316-M10X20-TP-N | M10 | 16.5 | 36 | 20 | 3.5 | 17.5 | 3 | 3.5 |
| 504342 | SRD.316-M10X25-TP-N | M10 | 16.5 | 36 | 25 | 3.5 | 17.5 | 3 | 4 |
| 504343 | SRD.316-M10X30-TP-N | M10 | 16.5 | 36 | 30 | 3.5 | 17.5 | 3 | 4.5 |
| 504344 | SRD.316-M10X40-TP-N | M10 | 16.5 | 36 | 40 | 3.5 | 17.5 | 3 | 5.5 |
| 504345 | SRD.316-M10X50-TP-N | M10 | 16.5 | 36 | 50 | 3.5 | 17.5 | 3 | 6.5 |
| 504346 | SRD.316-M10X60-TP-N | M10 | 16.5 | 36 | 60 | 3.5 | 17.5 | 3 | 8 |
| 504351 | SRD.316-M12X20-TP-N | M12 | 16.5 | 36 | 20 | 3.5 | 17.5 | 3 | 5.5 |
| 504352 | SRD.316-M12X30-TP-N | M12 | 16.5 | 36 | 25 | 3.5 | 17.5 | 3 | 6.5 |
| 504353 | SRD.316-M12X40-TP-N | M12 | 16.5 | 36 | 30 | 3.5 | 17.5 | 3 | 8 |
| 504354 | SRD.316-M12X50-TP-N | M12 | 16.5 | 36 | 40 | 3.5 | 17.5 | 3 | 9.5 |
| 504355 | SRD.316-M12X60-TP-N | M12 | 16.5 | 36 | 50 | 3.5 | 17.5 | 3 | 11 |
| 504356 | SRD.316-M12X80-TP-N | M12 | 16.5 | 36 | 60 | 3.5 | 17.5 | 3 | 13 |

Clamping elements