

- 1
- 2
- 3
- 4
- 5
- 6
- 7
- 8
- 9
- 10
- 11
- 12
- 13
- 14
- 15
- 16
- 17
- 18
- 19

**MATERIAL**

Zinc-plated steel threaded insert.

**NO-SLIP COATING**

Thermoplastic elastomer (TPE), hardness 80 shore A.

**STANDARD EXECUTION**

Magnet in neodymium iron boron (NdFeB)

D=12÷43 temperatures to 60°C, D=57÷88 temperatures up to 80°C.

- **RMF-ND-BK**: threaded hole, no-slip coating in RAL 9011 black colour.

- **RMF-ND-WT**: threaded hole, no-slip coating in RAL 9016 white colour.

Retaining magnets technical data (on page 756).

**FEATURES AND APPLICATIONS**

RMF flat retaining magnets are shielded magnetic systems with high performances and moderate overall dimensions.

The elastomer surface increases the friction coefficient when lateral retaining forces are present, giving a better adhesion. These magnets are preferably used for sensitive surfaces.



Conversion Table	
1 mm = 0.039 inch	
D	
mm	inch
12	0.47
18	0.70
22	0.86
31	1.21
43	1.68
57	2.22
66	2.57
88	3.43

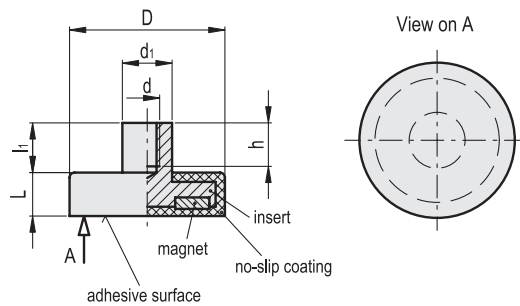

**RMF-ND-BK**

METRIC

Code	Description	D	d	L	h	d1	l1	Nominal adhesive forces* [N]	⚖
501501	RMF-ND-12-BK	12	M4	7	6	8	8	13	6
501516	RMF-ND-18-BK	18	M4	6	5	8	5.5	37	9
501511	RMF-ND-22-BK	22	M4	6	5	8	5.5	58	13
501521	RMF-ND-31-BK	31	M4	6	5	8	5.5	89	22
501531	RMF-ND-43-BK	43	M4	6	5	8	4.5	100	30
501536	RMF-ND-57-BK	57	M5	7.6	8	10	5.5	200	82
501541	RMF-ND-66-BK	66	M5	8.5	8	10	6.5	250	105
501551	RMF-ND-88-BK	88	M8	8.5	11	12	8.5	550	192

**RMF-ND-WT**

Code	Description	D	d	L	h	d1	l1	Nominal adhesive forces* [N]	⚖
501503	RMF-ND-12-WT	12	M4	7	6	8	8	13	6
501517	RMF-ND-18-WT	18	M4	6	5	8	5.5	58	9
501513	RMF-ND-22-WT	22	M4	6	5	8	5.5	58	13
501523	RMF-ND-31-WT	31	M4	6	5	8	5.5	89	22
501533	RMF-ND-43-WT	43	M4	6	5	8	4.5	100	30
501537	RMF-ND-57-WT	57	M5	7.6	8	10	5.5	58	82
501543	RMF-ND-66-WT	66	M5	8.5	8	10	6.5	250	105
501553	RMF-ND-88-WT	88	M8	8.5	11	12	8.5	550	192

Industrial magnets

\* The values of the nominal adhesive forces are approximate and refer to magnetic properties observed on laboratory samples.