

- 1
- 2
- 3
- 4
- 5
- 6
- 7
- 8
- 9
- 10
- 11
- 12
- 13
- 14
- 15
- 16
- 17
- 18

**MATERIAL**

C10 zinc-plated steel.

**BASE**

Manganese phosphate pressed steel, black colour.

**HEXAGON-SOCKET HEAD SCREWS WITH COUNTERSINK FOR CYLINDER SUPPORT**

Black-oxide steel.

**CYLINDER SUPPORT BUSHINGS**

Hardened steel.

**CYLINDER BODY AND HEADERS**

Aluminium.

**PUSH LEVER**

AISI 420 stainless steel.

**ROTATING PINS AND SEEGER RINGS**

Ground and hardened steel.

**MAXIMUM WORKING PRESSURE**

6 bars.

**MAX WORKING TEMPERATURE**

70°C.

**CLAMPING BOLT**

To be ordered separately.

**FEATURES AND APPLICATIONS**

All articulated joints are lubricated with special grease. PFB pneumatic clamps are all equipped with a magnetic cylinder which, through the use of the proximity switch PSWX (see page -) (to be ordered separately) gives drive and/or control impulses while active. All magnetic cylinders are equipped with an automatic pneumatic brake in the rear head.

Using a lubrication filter assembly is necessary for the cylinder to work properly for a long time, whereas flow regulators are recommended to guarantee long life of mechanical components.

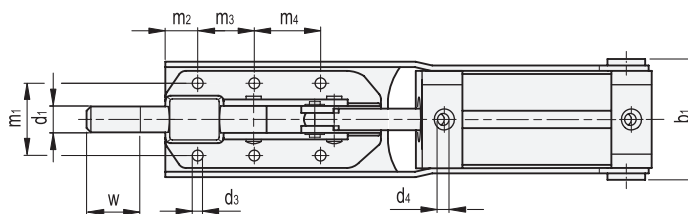
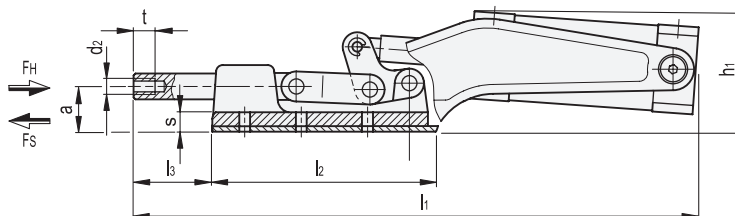

Conversion Table	
1 mm = 0.039 inch	
d2	
mm	inch
6	0.23
8	0.31
10	0.39
12	0.47

Code	Description	a	b1	d1	d2	d3	d4	h1	l1	l2	l3	m1	m2	m3	m4	s	t	w	Stroke	FH* [N]	FS# [N]	⚙️
GG.AO444	PFB.70/SP4	13.5	48	8.5	M6	4.3	M5	50	163	70	20	26	13	26	-	7.5	12	12	1200	780	500	
GG.AO446	PFB.360/SP4	27.5	58	12	M8	5.5	G1/8	69	274	94	32	33.5	30	36.5	-	9.5	15	23	5600	1290	1400	
GG.AO448	PFB.1100/SP4	28	70	16	M10	8.5	G1/4	85	361	138	49	41	15	35	41	11	18	32	16000	4480	2600	
GG.AO450	PFB.2100/SP4	38.5	82.5	20	M12	8.5	G1/4	96.5	482	190	61.5	50	35	50	50	13.5	22	45	25000	5520	5200	

\* Holding force.  
# Clamping force ~6 bar.