



- 1
- 2
- 3
- 4
- 5
- 6
- 7
- 8
- 9
- 10
- 11
- 12
- 13
- 14
- 15
- 16
- 17
- 18
- 19

BASE

Glass-fibre reinforced polyamide based (PA) special conductive technopolymer, black colour, matte finish.
 Surface resistivity = $10^3 \Omega$ (ASTM D257 measuring method).
 Volume resistivity = $10^3 \Omega\text{cm}$ (ASTM D257 measuring method).

ARTICULATED STEM

Threaded AISI 304 stainless steel with regulation hexagon.

STANDARD EXECUTIONS

- **LVA-SST-ESD-C**: without no-slip disk.
 - **LVA-AS-SST-ESD-C**: with NBR conductive rubber, hardness 70 Shore A, supplied assembled.
- Surface resistivity = $10^3 \Omega$ (ASTM D257 measuring method).
 Volume resistivity = $10^3 \Omega\text{cm}$ (ASTM D257 measuring method).

FEATURES AND APPLICATIONS

The special conductive technopolymer (ESD-C Electrostatic Discharge Conductive) prevents the accumulation of electrostatic charge. The bases are suitable for "ESD PROTECTED AREA" (EPA) where components, which are susceptible to electrostatic discharges, are handled. The (ESD-C) indelibly printed mark on the surface of the levelling elements bases identifies the particular conductive features of the material according to EN 100015/1 and IEC 61340-5-1. The particular assembling system of the no-slip disk to the base assures a perfect anchoring, preventing separation even in case of impact during transport or of adhesion (sticking) to the floor (see No-slip disks on page 1283).

ORDER INFORMATION

The levelling elements are supplied unassembled to make carriage and storage easier. The components (base and stem) are supplied in separate packing: less volume taken and better protection from scratches and dirt.
 To order bases and stems separately, see:
 - table of possible combinations Bases/Stems (see page 839)
 - the codes of the Bases (see page 836)
 - the codes of the Stems (see page 985).

ACCESSORIES ON REQUEST

AISI 304 stainless steel nut (see Nuts NT. on page 835).



ELESA Original design

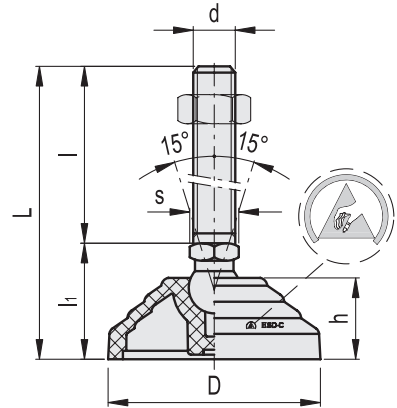

LVA-SST-ESD-C

Code	Description	D	d2A	L	l	l1	h	s	Articulation Ø	Max. limit static load* [lbf]	⚖️
90323121-ESD	LVA-60-14-SST-3/8-16X2-ESD-C	2.36	3/8-16	3.30	2	1.30	0.94	9/16	0.55	3147.33	0.17
90323125-ESD	LVA-60-14-SST-3/8-16X4-ESD-C	2.36	3/8-16	5.30	4	1.30	0.94	9/16	0.55	3147.33	0.28
90323127-ESD	LVA-60-14-SST-3/8-16X6-ESD-C	2.36	3/8-16	7.30	6	1.30	0.94	9/16	0.55	3147.33	0.18
90323321-ESD	LVA-60-14-SST-1/2-13X2-ESD-C	2.36	1/2-13	3.30	2	1.30	0.94	9/16	0.55	3147.33	0.19
90323325-ESD	LVA-60-14-SST-1/2-13X4-ESD-C	2.36	1/2-13	5.30	4	1.30	0.94	9/16	0.55	3147.33	0.30
90323331-ESD	LVA-60-14-SST-1/2-13X6-ESD-C	2.36	1/2-13	7.30	6	1.30	0.94	9/16	0.55	3147.33	0.28
90323521-ESD	LVA-60-14-SST-5/8-11X4-ESD-C	2.36	5/8-11	5.30	4	1.30	0.94	5/8	0.55	3147.33	0.40
90323525-ESD	LVA-60-14-SST-5/8-11X6-ESD-C	2.36	5/8-11	7.30	6	1.30	0.94	5/8	0.55	3147.33	0.57
90323541-ESD	LVA-60-14-SST-5/8-11X8-ESD-C	2.36	5/8-11	9.30	8	1.30	0.94	5/8	0.55	3147.33	0.62
90323621-ESD	LVA-60-24-SST-5/8-11X4-ESD-C	2.36	5/8-11	5.69	4	1.69	0.94	15/16	0.94	4046.56	0.60
90323625-ESD	LVA-60-24-SST-5/8-11X6-ESD-C	2.36	5/8-11	7.69	6	1.69	0.94	15/16	0.94	4046.56	0.72
90323641-ESD	LVA-60-24-SST-5/8-11X8-ESD-C	2.36	5/8-11	9.69	8	1.69	0.94	15/16	0.94	4046.56	0.78
90323725-ESD	LVA-60-24-SST-3/4-10X4-ESD-C	2.36	3/4-10	5.69	4	1.69	0.94	15/16	0.94	4046.56	0.77
90323741-ESD	LVA-60-24-SST-3/4-10X6-ESD-C	2.36	3/4-10	7.69	6	1.69	0.94	15/16	0.94	4046.56	0.94
90323761-ESD	LVA-60-24-SST-3/4-10X8-ESD-C	2.36	3/4-10	9.69	8	1.69	0.94	15/16	0.94	4046.56	1.22

* The max static load is the value above which the load applied to the element may cause some plastic material breakage, in particular conditions of use. Obviously, a factor that takes into consideration the importance and the safety level of the specific application must be applied to this value.

Levelling elements and supports

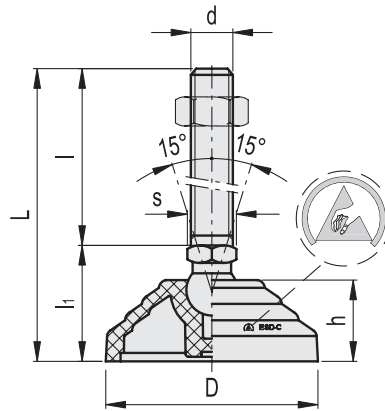

INOX STAINLESS STEEL INCH

LV.A-SST-ESD-C

Code	Description	D	d2A	L	l	l1	h	s	Articulation Ø	Max. limit static load* [lbf]	⚖️
90324005-ESD	LV.A-70-14-SST-3/8-16X2-ESD-C	2.76	3/8-16	3.10	2	1.10	0.75	9/16	0.55	3147.33	0.17
90324011-ESD	LV.A-70-14-SST-3/8-16X4-ESD-C	2.76	3/8-16	5.10	4	1.10	0.75	9/16	0.55	3147.33	0.28
90324013-ESD	LV.A-70-14-SST-3/8-16X6-ESD-C	2.76	3/8-16	7.10	6	1.10	0.75	9/16	0.55	3147.33	0.18
90324061-ESD	LV.A-70-14-SST-1/2-13X2-ESD-C	2.76	1/2-13	3.10	2	1.10	0.75	9/16	0.55	3147.33	0.19
90324065-ESD	LV.A-70-14-SST-1/2-13X4-ESD-C	2.76	1/2-13	5.10	4	1.10	0.75	9/16	0.55	3147.33	0.30
90324071-ESD	LV.A-70-14-SST-1/2-13X6-ESD-C	2.76	1/2-13	7.10	6	1.10	0.75	9/16	0.55	3147.33	0.28
90324101-ESD	LV.A-70-14-SST-5/8-11X4-ESD-C	2.76	5/8-11	5.10	4	1.10	0.75	5/8	0.55	3147.33	0.40
90324105-ESD	LV.A-70-14-SST-5/8-11X6-ESD-C	2.76	5/8-11	7.10	6	1.10	0.75	5/8	0.55	3147.33	0.57
90324111-ESD	LV.A-70-14-SST-5/8-11X8-ESD-C	2.76	5/8-11	9.10	8	1.10	0.75	5/8	0.55	3147.33	0.63
90324121-ESD	LV.A-80-14-SST-3/8-16X2-ESD-C	3.15	3/8-16	3.30	2	1.30	0.94	9/16	0.55	3596.94	0.23
90324125-ESD	LV.A-80-14-SST-3/8-16X4-ESD-C	3.15	3/8-16	5.30	4	1.30	0.94	9/16	0.55	3596.94	0.34
90324127-ESD	LV.A-80-14-SST-3/8-16X6-ESD-C	3.15	3/8-16	7.30	6	1.30	0.94	9/16	0.55	3596.94	0.24
90324321-ESD	LV.A-80-14-SST-1/2-13X2-ESD-C	3.15	1/2-13	3.30	2	1.30	0.94	9/16	0.55	3596.94	0.25
90324325-ESD	LV.A-80-14-SST-1/2-13X4-ESD-C	3.15	1/2-13	5.30	4	1.30	0.94	9/16	0.55	3596.94	0.35
90324331-ESD	LV.A-80-14-SST-1/2-13X6-ESD-C	3.15	1/2-13	7.30	6	1.30	0.94	9/16	0.55	3596.94	0.34
90324521-ESD	LV.A-80-14-SST-5/8-11X4-ESD-C	3.15	5/8-11	5.30	4	1.30	0.94	5/8	0.55	3596.94	0.46
90324525-ESD	LV.A-80-14-SST-5/8-11X6-ESD-C	3.15	5/8-11	7.30	6	1.30	0.94	5/8	0.55	3596.94	0.63
90324541-ESD	LV.A-80-14-SST-5/8-11X8-ESD-C	3.15	5/8-11	9.30	8	1.30	0.94	5/8	0.55	3596.94	0.68
90324621-ESD	LV.A-80-24-SST-5/8-11X4-ESD-C	3.15	5/8-11	5.69	4	1.69	0.94	15/16	0.94	4046.56	0.65
90324625-ESD	LV.A-80-24-SST-5/8-11X6-ESD-C	3.15	5/8-11	7.69	6	1.69	0.94	15/16	0.94	4046.56	0.77
90324641-ESD	LV.A-80-24-SST-5/8-11X8-ESD-C	3.15	5/8-11	9.69	8	1.69	0.94	15/16	0.94	4046.56	0.82
90324725-ESD	LV.A-80-24-SST-3/4-10X4-ESD-C	3.15	3/4-10	5.69	4	1.69	0.94	15/16	0.94	4046.56	0.82
90324741-ESD	LV.A-80-24-SST-3/4-10X6-ESD-C	3.15	3/4-10	7.69	6	1.69	0.94	15/16	0.94	4046.56	0.99
90324761-ESD	LV.A-80-24-SST-3/4-10X8-ESD-C	3.15	3/4-10	9.69	8	1.69	0.94	15/16	0.94	4046.56	1.27
90325451-ESD	LV.A-100-14-SST-3/8-16X2-ESD-C	3.94	3/8-16	3.30	2	1.30	0.94	9/16	0.55	4046.56	0.30
90325453-ESD	LV.A-100-14-SST-3/8-16X4-ESD-C	3.94	3/8-16	5.30	4	1.30	0.94	9/16	0.55	4046.56	0.40
90325455-ESD	LV.A-100-14-SST-3/8-16X6-ESD-C	3.94	3/8-16	7.30	6	1.30	0.94	9/16	0.55	4046.56	0.30
90325471-ESD	LV.A-100-14-SST-1/2-13X2-ESD-C	3.94	1/2-13	3.30	2	1.30	0.94	9/16	0.55	4046.56	0.32
90325473-ESD	LV.A-100-14-SST-1/2-13X4-ESD-C	3.94	1/2-13	5.30	4	1.30	0.94	9/16	0.55	4046.56	0.42
90325475-ESD	LV.A-100-14-SST-1/2-13X6-ESD-C	3.94	1/2-13	7.30	6	1.30	0.94	9/16	0.55	4046.56	0.40
90325481-ESD	LV.A-100-14-SST-5/8-11X4-ESD-C	3.94	5/8-11	5.30	4	1.30	0.94	5/8	0.55	4046.56	0.52
90325483-ESD	LV.A-100-14-SST-5/8-11X6-ESD-C	3.94	5/8-11	7.30	6	1.30	0.94	5/8	0.55	4046.56	0.69
90325485-ESD	LV.A-100-14-SST-5/8-11X8-ESD-C	3.94	5/8-11	9.30	8	1.30	0.94	5/8	0.55	4046.56	0.75
90325521-ESD	LV.A-100-24-SST-5/8-11X4-ESD-C	3.94	5/8-11	5.69	4	1.69	0.94	15/16	0.94	5620.22	0.71
90325525-ESD	LV.A-100-24-SST-5/8-11X6-ESD-C	3.94	5/8-11	7.69	6	1.69	0.94	15/16	0.94	5620.22	0.83
90325541-ESD	LV.A-100-24-SST-5/8-11X8-ESD-C	3.94	5/8-11	9.69	8	1.69	0.94	15/16	0.94	5620.22	0.89
90325625-ESD	LV.A-100-24-SST-3/4-10X4-ESD-C	3.94	3/4-10	5.69	4	1.69	0.94	15/16	0.94	5620.22	0.88
90325641-ESD	LV.A-100-24-SST-3/4-10X6-ESD-C	3.94	3/4-10	7.69	6	1.69	0.94	15/16	0.94	5620.22	1.05
90325661-ESD	LV.A-100-24-SST-3/4-10X8-ESD-C	3.94	3/4-10	9.69	8	1.69	0.94	15/16	0.94	5620.22	1.33
90326521-ESD	LV.A-125-24-SST-5/8-11X4-ESD-C	4.92	5/8-11	6.64	4	2.64	1.81	15/16	0.94	5620.22	0.97
90326525-ESD	LV.A-125-24-SST-5/8-11X6-ESD-C	4.92	5/8-11	8.64	6	2.64	1.81	15/16	0.94	5620.22	1.09
90326541-ESD	LV.A-125-24-SST-5/8-11X8-ESD-C	4.92	5/8-11	10.64	8	2.64	1.81	15/16	0.94	5620.22	1.15
90326625-ESD	LV.A-125-24-SST-3/4-10X4-ESD-C	4.92	3/4-10	6.64	4	2.64	1.81	15/16	0.94	5620.22	1.14
90326641-ESD	LV.A-125-24-SST-3/4-10X6-ESD-C	4.92	3/4-10	8.64	6	2.64	1.81	15/16	0.94	5620.22	1.31
90326661-ESD	LV.A-125-24-SST-3/4-10X8-ESD-C	4.92	3/4-10	10.64	8	2.64	1.81	15/16	0.94	5620.22	1.59

* The max static load is the value above which the load applied to the element may cause some plastic material breakage, in particular conditions of use. Obviously, a factor that takes into consideration the importance and the safety level of the specific application must be applied to this value.



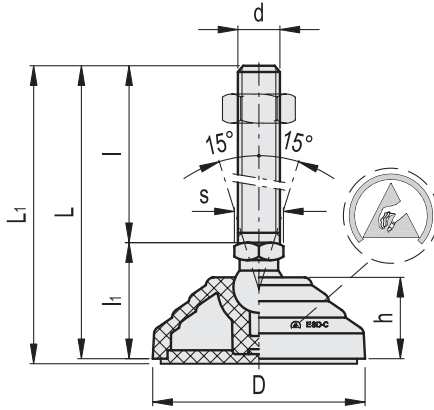
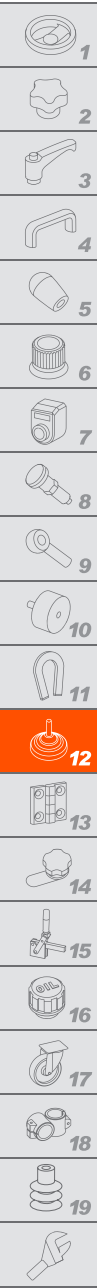

LV.A-AS-ESD-C

Code	Description	D	d2A	L	L1	l	l1	h	s	Articulation Ø	Max. limit static load* [lbf]	⚖️
90327121-ESD	LV.A-60-14-AS-SST-3/8-16X2-ESD-C	2.36	3/8-16	3.30	3.42	2	1.30	0.94	9/16	0.55	3147.33	0.21
90327125-ESD	LV.A-60-14-AS-SST-3/8-16X4-ESD-C	2.36	3/8-16	5.30	5.42	4	1.30	0.94	9/16	0.55	3147.33	0.32
90327127-ESD	LV.A-60-14-AS-SST-3/8-16X6-ESD-C	2.36	3/8-16	7.30	7.42	6	1.30	0.94	9/16	0.55	3147.33	0.22
90327321-ESD	LV.A-60-14-AS-SST-1/2-13X2-ESD-C	2.36	1/2-13	3.30	3.42	2	1.30	0.94	9/16	0.55	3147.33	0.23
90327325-ESD	LV.A-60-14-AS-SST-1/2-13X4-ESD-C	2.36	1/2-13	5.30	5.42	4	1.30	0.94	9/16	0.55	3147.33	0.33
90327331-ESD	LV.A-60-14-AS-SST-1/2-13X6-ESD-C	2.36	1/2-13	7.30	7.42	6	1.30	0.94	9/16	0.55	3147.33	0.32
90327521-ESD	LV.A-60-14-AS-SST-5/8-11X4-ESD-C	2.36	5/8-11	5.30	5.42	4	1.30	0.94	5/8	0.55	3147.33	0.44
90327525-ESD	LV.A-60-14-AS-SST-5/8-11X6-ESD-C	2.36	5/8-11	7.30	7.42	6	1.30	0.94	5/8	0.55	3147.33	0.60
90327541-ESD	LV.A-60-14-AS-SST-5/8-11X8-ESD-C	2.36	5/8-11	9.30	9.42	8	1.30	0.94	5/8	0.55	3147.33	0.66
90327621-ESD	LV.A-60-24-AS-SST-5/8-11X4-ESD-C	2.36	5/8-11	5.69	5.81	4	1.69	0.94	15/16	0.94	4046.56	0.64
90327625-ESD	LV.A-60-24-AS-SST-5/8-11X6-ESD-C	2.36	5/8-11	7.69	7.81	6	1.69	0.94	15/16	0.94	4046.56	0.76
90327641-ESD	LV.A-60-24-AS-SST-5/8-11X8-ESD-C	2.36	5/8-11	9.69	9.81	8	1.69	0.94	15/16	0.94	4046.56	0.82
90327725-ESD	LV.A-60-24-AS-SST-3/4-10X4-ESD-C	2.36	3/4-10	5.69	5.81	4	1.69	0.94	15/16	0.94	4046.56	0.81
90327741-ESD	LV.A-60-24-AS-SST-3/4-10X6-ESD-C	2.36	3/4-10	7.69	7.81	6	1.69	0.94	15/16	0.94	4046.56	0.98
90327761-ESD	LV.A-60-24-AS-SST-3/4-10X8-ESD-C	2.36	3/4-10	9.69	9.81	8	1.69	0.94	15/16	0.94	4046.56	1.26
90328005-ESD	LV.A-70-14-AS-SST-3/8-16X2-ESD-C	2.76	3/8-16	3.10	3.22	2	1.10	0.75	9/16	0.55	3147.33	0.22
90328011-ESD	LV.A-70-14-AS-SST-3/8-16X4-ESD-C	2.76	3/8-16	5.10	5.22	4	1.10	0.75	9/16	0.55	3147.33	0.33
90328013-ESD	LV.A-70-14-AS-SST-3/8-16X6-ESD-C	2.76	3/8-16	7.10	7.22	6	1.10	0.75	9/16	0.55	3147.33	0.23
90328061-ESD	LV.A-70-14-AS-SST-1/2-13X2-ESD-C	2.76	1/2-13	3.10	3.22	2	1.10	0.75	9/16	0.55	3147.33	0.24
90328065-ESD	LV.A-70-14-AS-SST-1/2-13X4-ESD-C	2.76	1/2-13	5.10	5.22	4	1.10	0.75	9/16	0.55	3147.33	0.35
90328071-ESD	LV.A-70-14-AS-SST-1/2-13X6-ESD-C	2.76	1/2-13	7.10	7.22	6	1.10	0.75	9/16	0.55	3147.33	0.33
90328101-ESD	LV.A-70-14-AS-SST-5/8-11X4-ESD-C	2.76	5/8-11	5.10	5.22	4	1.10	0.75	5/8	0.55	3147.33	0.45
90328105-ESD	LV.A-70-14-AS-SST-5/8-11X6-ESD-C	2.76	5/8-11	7.10	7.22	6	1.10	0.75	5/8	0.55	3147.33	0.62
90328111-ESD	LV.A-70-14-AS-SST-5/8-11X8-ESD-C	2.76	5/8-11	9.10	9.22	8	1.10	0.75	5/8	0.55	3147.33	0.67
90328121-ESD	LV.A-80-14-AS-SST-3/8-16X2-ESD-C	3.15	3/8-16	3.30	3.42	2	1.30	0.94	9/16	0.55	3596.94	0.28
90328125-ESD	LV.A-80-14-AS-SST-3/8-16X4-ESD-C	3.15	3/8-16	5.30	5.42	4	1.30	0.94	9/16	0.55	3596.94	0.39
90328127-ESD	LV.A-80-14-AS-SST-3/8-16X6-ESD-C	3.15	3/8-16	7.30	7.42	6	1.30	0.94	9/16	0.55	3596.94	0.28
90328321-ESD	LV.A-80-14-AS-SST-1/2-13X2-ESD-C	3.15	1/2-13	3.30	3.42	2	1.30	0.94	9/16	0.55	3596.94	0.30
90328325-ESD	LV.A-80-14-AS-SST-1/2-13X4-ESD-C	3.15	1/2-13	5.30	5.42	4	1.30	0.94	9/16	0.55	3596.94	0.40
90328331-ESD	LV.A-80-14-AS-SST-1/2-13X6-ESD-C	3.15	1/2-13	7.30	7.42	6	1.30	0.94	9/16	0.55	3596.94	0.39
90328521-ESD	LV.A-80-14-AS-SST-5/8-11X4-ESD-C	3.15	5/8-11	5.30	5.42	4	1.30	0.94	5/8	0.55	3596.94	0.51
90328525-ESD	LV.A-80-14-AS-SST-5/8-11X6-ESD-C	3.15	5/8-11	7.30	7.42	6	1.30	0.94	5/8	0.55	3596.94	0.67
90328541-ESD	LV.A-80-14-AS-SST-5/8-11X8-ESD-C	3.15	5/8-11	9.30	9.42	8	1.30	0.94	5/8	0.55	3596.94	0.73
90328621-ESD	LV.A-80-24-AS-SST-5/8-11X4-ESD-C	3.15	5/8-11	5.69	5.81	4	1.69	0.94	15/16	0.94	4046.56	0.70
90328625-ESD	LV.A-80-24-AS-SST-5/8-11X6-ESD-C	3.15	5/8-11	7.69	7.81	6	1.69	0.94	15/16	0.94	4046.56	0.82
90328641-ESD	LV.A-80-24-AS-SST-5/8-11X8-ESD-C	3.15	5/8-11	9.69	9.81	8	1.69	0.94	15/16	0.94	4046.56	0.88
90328725-ESD	LV.A-80-24-AS-SST-3/4-10X4-ESD-C	3.15	3/4-10	5.69	5.81	4	1.69	0.94	15/16	0.94	4046.56	0.87
90328741-ESD	LV.A-80-24-AS-SST-3/4-10X6-ESD-C	3.15	3/4-10	7.69	7.81	6	1.69	0.94	15/16	0.94	4046.56	1.04
90328761-ESD	LV.A-80-24-AS-SST-3/4-10X8-ESD-C	3.15	3/4-10	9.69	9.81	8	1.69	0.94	15/16	0.94	4046.56	1.32

* The max static load is the value above which the load applied to the element may cause some plastic material breakage, in particular conditions of use. Obviously, a factor that takes into consideration the importance and the safety level of the specific application must be applied to this value.

Levelling elements and supports

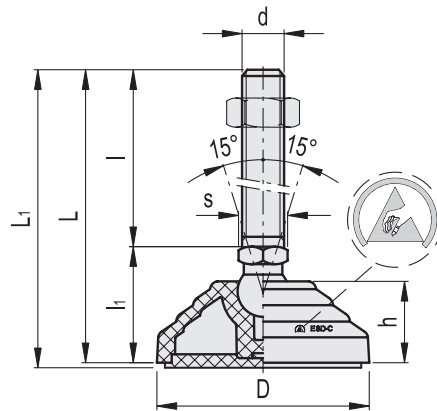

INOX STAINLESS STEEL INCH

LV.A-AS-ESD-C

Code	Description	D	d2A	L	L1	l	l1	h	s	Articulation Ø	Max. limit static load* [lbf]	⚖️
90329451-ESD	LV.A-100-14-AS-SST-3/8-16X2-ESD-C	3.94	3/8-16	3.30	3.42	2	1.30	0.94	9/16	0.55	4046.56	0.38
90329453-ESD	LV.A-100-14-AS-SST-3/8-16X4-ESD-C	3.94	3/8-16	5.30	5.42	4	1.30	0.94	9/16	0.55	4046.56	0.49
90329455-ESD	LV.A-100-14-AS-SST-3/8-16X6-ESD-C	3.94	3/8-16	7.30	7.42	6	1.30	0.94	9/16	0.55	4046.56	0.39
90329471-ESD	LV.A-100-14-AS-SST-1/2-13X2-ESD-C	3.94	1/2-13	3.30	3.42	2	1.30	0.94	9/16	0.55	4046.56	0.40
90329473-ESD	LV.A-100-14-AS-SST-1/2-13X4-ESD-C	3.94	1/2-13	5.30	5.42	4	1.30	0.94	9/16	0.55	4046.56	0.51
90329475-ESD	LV.A-100-14-AS-SST-1/2-13X6-ESD-C	3.94	1/2-13	7.30	7.42	6	1.30	0.94	9/16	0.55	4046.56	0.49
90329481-ESD	LV.A-100-14-AS-SST-5/8-11X4-ESD-C	3.94	5/8-11	5.30	5.42	4	1.30	0.94	5/8	0.55	4046.56	0.61
90329483-ESD	LV.A-100-14-AS-SST-5/8-11X6-ESD-C	3.94	5/8-11	7.30	7.42	6	1.30	0.94	5/8	0.55	4046.56	0.78
90329485-ESD	LV.A-100-14-AS-SST-5/8-11X8-ESD-C	3.94	5/8-11	9.30	9.42	8	1.30	0.94	5/8	0.55	4046.56	0.83
90329521-ESD	LV.A-100-24-AS-SST-5/8-11X4-ESD-C	3.94	5/8-11	5.69	5.81	4	1.69	0.94	15/16	0.94	5620.22	0.83
90329525-ESD	LV.A-100-24-AS-SST-5/8-11X6-ESD-C	3.94	5/8-11	7.69	7.81	6	1.69	0.94	15/16	0.94	5620.22	0.94
90329541-ESD	LV.A-100-24-AS-SST-5/8-11X8-ESD-C	3.94	5/8-11	9.69	9.81	8	1.69	0.94	15/16	0.94	5620.22	1.00
90329625-ESD	LV.A-100-24-AS-SST-3/4-10X4-ESD-C	3.94	3/4-10	5.69	5.81	4	1.69	0.94	15/16	0.94	5620.22	0.99
90329641-ESD	LV.A-100-24-AS-SST-3/4-10X6-ESD-C	3.94	3/4-10	7.69	7.81	6	1.69	0.94	15/16	0.94	5620.22	1.16
90329661-ESD	LV.A-100-24-AS-SST-3/4-10X8-ESD-C	3.94	3/4-10	9.69	9.81	8	1.69	0.94	15/16	0.94	5620.22	1.44
90330221-ESD	LV.A-125-24-AS-SST-5/8-11X4-ESD-C	4.92	5/8-11	6.64	6.76	4	2.64	1.81	15/16	0.94	5620.22	1.14
90330225-ESD	LV.A-125-24-AS-SST-5/8-11X6-ESD-C	4.92	5/8-11	8.64	8.76	6	2.64	1.81	15/16	0.94	5620.22	1.26
90330241-ESD	LV.A-125-24-AS-SST-5/8-11X8-ESD-C	4.92	5/8-11	10.64	10.76	8	2.64	1.81	15/16	0.94	5620.22	1.32
90330325-ESD	LV.A-125-24-AS-SST-3/4-10X4-ESD-C	4.92	3/4-10	6.64	6.76	4	2.64	1.81	15/16	0.94	5620.22	1.31
90330341-ESD	LV.A-125-24-AS-SST-3/4-10X6-ESD-C	4.92	3/4-10	8.64	8.76	6	2.64	1.81	15/16	0.94	5620.22	1.76
90330361-ESD	LV.A-125-24-AS-SST-3/4-10X8-ESD-C	4.92	3/4-10	10.64	10.76	8	2.64	1.81	15/16	0.94	5620.22	1.48

* The max static load is the value above which the load applied to the element may cause some plastic material breakage, in particular conditions of use. Obviously, a factor that takes into consideration the importance and the safety level of the specific application must be applied to this value.

