

I.780-N | Cylindrical fixed handles

Technopolymer



- 1
- 2
- 3
- 4
- 5
- 6
- 7
- 8
- 9
- 10
- 11
- 12
- 13
- 14
- 15
- 16
- 17
- 18

MATERIAL

Glass-fibre reinforced polyamide based (PA) technopolymer, black colour, matte finish.

MOUNTING

Blind hole.

The elastic coupling, by press-fit assembly on h9 tolerance drawn stock bars, is not affected by vibrations and prevents the handle from slipping off (see Technical data on page A-13).

ASSEMBLY INSTRUCTIONS

Fit the handle onto slight chamfered shaft end and push as far as possible by hand or by means of a small press. Alternatively it is possible to tap the handle with a plastic or wooden mallet until firmly in place. In this case we strongly recommend to use a cloth or other suitable soft material over the product to avoid any surface damage.



ELESA Original design

Conversion Table	
1 mm = 0.039 inch	
mm	inch
40	1.57
50	1.97
56	2.20
65	2.56
80	3.14
90	3.54
100	3.94

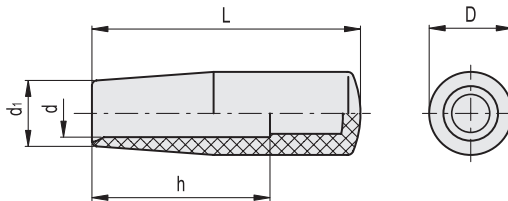

Code	Description	D	L	d	d1	h	⚖️
124601	I.780/40-N8-C9	18	40	8	15	28	8
124611	I.780/50-N10-C9	21	50	10	17	35	10
124621	I.780/56-N10-C9	22	56	10	18	40	14
124631	I.780/65-N10-C9	24.5	65	10	20.5	45	17
124636	I.780/65-N12-C9	24.5	65	12	20.5	45	16
124804	I.780/80-N12-C9	26.5	80	12	21	50	25
124646	I.780/80-N14-C9	26.5	80	14	21	50	24
124651	I.780/90-N15-C9	28.5	90	15	22.5	60	33
124656	I.780/90-N16-C9	28.5	90	16	22.5	60	32
124661	I.780/100-N16-C9	31	100	16	25	60	36

Fixed & Revolving handles