

- 1
- 2
- 3
- 4
- 5
- 6
- 7
- 8
- 9
- 10
- 11
- 12
- 13
- 14
- 15
- 16
- 17
- 18

MATERIAL

Polypropylene (PP) based technopolymer, high resilience, with "soft-touch" thermoplastic elastomer (TPE) coating mechanically and chemically seamed, hardness 70 Shore A, black colour, matte finish.

STANDARD EXECUTION

I.618-N-SOFT: smooth blind hole. The elastic coupling, by press-fit assembly on h9 tolerance drawn stock bars, is not affected by vibrations and prevents the handle from slipping off (see Technical data on page A-13).

I.618-B-SOFT: brass boss, threaded blind hole. We recommend using a locking nut to secure the handle in the desired position.

FEATURES AND APPLICATIONS

Handle with "soft-touch" coating: it improves grip even in the presence of oils, grease, and sweaty hands.

Particularly suitable for fitness machines, tools and machines for gardening and goods transport, high-precision instruments and disability aids.

ASSEMBLY INSTRUCTIONS (I.618-N-SOFT)

Carefully fit the handle onto the slightly bevelled end of the shaft and advance it as far as possible by hand or with a press. Alternatively, use a plastic or wooden mallet to strike the handle with light, sharp blows until it stops. In this case we recommend placing a soft material in order to cushion the contact between the surfaces and avoid damage to the SOFT covering.



Conversion Table	
1 mm = 0.039 inch	
▼	
mm	inch
81.5	32.1

I.618-N-SOFT

I.618-B-SOFT

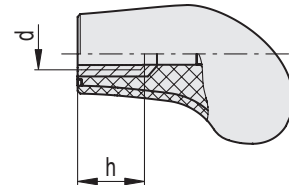
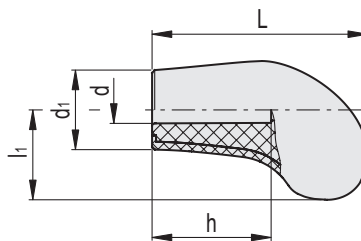
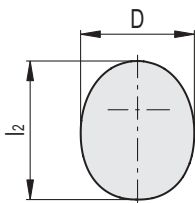

I.618-N-SOFT

METRIC

Code	Description	D	L	d	d1	h	l1	l2	△△
125501	I.618/80 N-10-SOFT	43	81.5	10	30	45	34	52.5	82
125511	I.618/80 N-12-SOFT	43	81.5	12	30	45	34	52.5	75
125521	I.618/80 N-14-SOFT	43	81.5	14	30	45	34	52.5	74
125531	I.618/80 N-16-SOFT	43	81.5	16	30	45	34	52.5	72

I.618-B-SOFT

METRIC

Code	Description	D	L	d	d1	h	l1	l2	△△
125541	I.618/80 B-M10-SOFT	43	81.5	M10	30	25	34	52.5	79
125551	I.618/80 B-M12-SOFT	43	81.5	M12	30	20	34	52.5	78

Fixed & Revolving handles