

THREADED BODY

AISI 303 stainless steel, screwdriver slotted head.

STANDARD EXECUTIONS

AISI 303 stainless steel bolt, stainless steel spring.

- **EN 615.1-NI-BN**: normal end force.
- **EN 615.1-NI-BSN**: heavy end force (marked with two lines).
- **EN 615.1-NI-BN/LE**: normal end force with locking patch.
- **EN 615.1-NI-BSN/LE**: heavy end force with locking patch (marked with two lines).

Nylon locking patch for applications subject to vibrations or to eliminate the need for check nuts. Not recommended for applications in soft materials.

Countersink the mating thread at least .030 to .045 larger than the major diameter of the plunger to make its insertion easier.

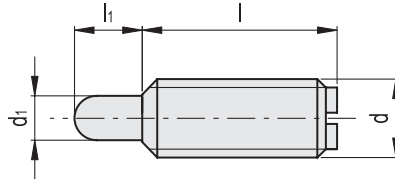

EN 615.1-NI-BN

EN 615.1-NI-BN/LE

Code	Description	Code	Description	d	d1	l	l1	Spring preload [lbf]	Spring max load [lbf]	⚖️
EN.933602	EN 615.1-6-32-BN	EN.933702	EN 615.1-6-32-BN/LE	6-32	0.04	0.37	0.06	0	2	0
EN.933612	EN 615.1-8-32-BN	EN.933712	EN 615.1-8-32-BN/LE	8-32	0.07	0.44	0.05	1	2	0
EN.933622	EN 615.1-8-36-BN	EN.933722	EN 615.1-8-36-BN/LE	8-36	0.07	0.44	0.05	1	2	0
EN.933632	EN 615.1-10-32-BN	EN.933732	EN 615.1-10-32-BN/LE	10-32	0.09	0.47	0.06	1	2	0
EN.933642	EN 615.1-1/4-20-BN	EN.933742	EN 615.1-1/4-20-BN/LE	1/4-20	0.12	0.53	0.07	1	3	0.01
EN.933662	EN 615.1-5/16-18-BN	EN.933762	EN 615.1-5/16-18-BN/LE	5/16-18	0.13	0.58	0.08	1	4	0.01
EN.933672	EN 615.1-3/8-16-BN	EN.933772	EN 615.1-3/8-16-BN/LE	3/8-16	0.19	0.62	0.11	2	5	0.01
EN.933682	EN 615.1-1/2-13-BN	EN.933782	EN 615.1-1/2-13-BN/LE	1/2-13	0.25	0.75	0.15	2	5	0.03
EN.933692	EN 615.1-5/8-11-BN	EN.933792	EN 615.1-5/8-11-BN/LE	5/8-11	0.31	1.06	0.21	2	9	0.06

EN 615.1-NI-BSN

EN 615.1-NI-BSN/LE

Code	Description	Code	Description	d	d1	l	l1	Spring preload [lbf]	Spring max load [lbf]	⚖️
EN.933604	EN 615.1-6-32-BSN	EN.933704	EN 615.1-6-32-BSN/LE	6-32	0.04	0.37	0.06	0	2	0
EN.933614	EN 615.1-8-32-BSN	EN.933714	EN 615.1-8-32-BSN/LE	8-32	0.07	0.44	0.05	2	5	0
EN.933624	EN 615.1-8-36-BSN	EN.933724	EN 615.1-8-36-BSN/LE	8-36	0.07	0.44	0.05	2	5	0
EN.933634	EN 615.1-10-32-BSN	EN.933734	EN 615.1-10-32-BSN/LE	10-32	0.09	0.47	0.06	3	6	0
EN.933644	EN 615.1-1/4-20-BSN	EN.933744	EN 615.1-1/4-20-BSN/LE	1/4-20	0.12	0.53	0.07	3	10	0.01
EN.933664	EN 615.1-5/16-18-BSN	EN.933764	EN 615.1-5/16-18-BSN/LE	5/16-18	0.13	0.58	0.08	4	13	0.01
EN.933674	EN 615.1-3/8-16-BSN	EN.933774	EN 615.1-3/8-16-BSN/LE	3/8-16	0.19	0.62	0.11	5	16	0.01
EN.933684	EN 615.1-1/2-13-BSN	EN.933784	EN 615.1-1/2-13-BSN/LE	1/2-13	0.25	0.75	0.15	5	22	0.03
EN.933694	EN 615.1-5/8-11-BSN	EN.933794	EN 615.1-5/8-11-BSN/LE	5/8-11	0.31	1.06	0.21	7	44	0.06



Indexing and positioning elements