

# EN 615.1 Bolt spring plungers

Threaded body, Steel

INCH



- 1
- 2
- 3
- 4
- 5
- 6
- 7
- 8
- 9
- 10
- 11
- 12
- 13
- 14
- 15
- 16
- 17
- 18

## THREADED BODY

Black-oxide steel, screwdriver slotted head.

## STANDARD EXECUTIONS

Black oxide hardened bolt, stainless steel spring.

- **EN 615.1-B**: normal end force.
- **EN 615.1-BS**: heavy end force (marked with two lines).
- **EN 615.1-B/LE**: normal end force with locking patch.
- **EN 615.1-BS/LE**: heavy end force with locking patch (marked with two lines).

Nylon locking patch for applications subject to vibrations or to eliminate the need for check nuts. Not recommended for applications in soft materials.

Countersink the mating thread at least .030 to .045 larger than the major diameter of the plunger to make insertion of the plunger easier.

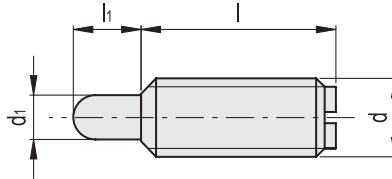

## EN 615.1-B

## EN 615.1-B/LE

INCH

Code	Description	Code	Description	d	d1	l	l1	Spring preload [lbf]	Spring max load [lbf]	⚖️
EN.933501	EN 615.1-6-32-B	EN.933502	EN 615.1-6-32-B/LE	6-32	0.04	0.37	0.06	0	2	0
EN.933511	EN 615.1-8-32-B	EN.933512	EN 615.1-8-32-B/LE	8-32	0.07	0.44	0.05	1	2	0
EN.933521	EN 615.1-8-36-B	EN.933522	EN 615.1-8-36-B/LE	8-36	0.07	0.44	0.05	1	2	0
EN.933531	EN 615.1-10-32-B	EN.933532	EN 615.1-10-32-B/LE	10-32	0.09	0.47	0.06	1	2	0
EN.933541	EN 615.1-1/4-20-B	EN.933542	EN 615.1-1/4-20-B/LE	1/4-20	0.12	0.53	0.07	1	3	0.01
EN.933561	EN 615.1-5/16-18-B	EN.933562	EN 615.1-5/16-18-B/LE	5/16-18	0.13	0.58	0.08	1	4	0.01
EN.933571	EN 615.1-3/8-16-B	EN.933572	EN 615.1-3/8-16-B/LE	3/8-16	0.19	0.62	0.11	2	5	0.01
EN.933581	EN 615.1-1/2-13-B	EN.933582	EN 615.1-1/2-13-B/LE	1/2-13	0.25	0.75	0.15	2	5	0.03
EN.933591	EN 615.1-5/8-11-B	EN.933592	EN 615.1-5/8-11-B/LE	5/8-11	0.31	1.06	0.21	2	9	0.06

## EN 615.1-BS

## EN 615.1-BS/LE

INCH

Code	Description	Code	Description	d	d1	l	l1	Spring preload [lbf]	Spring max load [lbf]	⚖️
EN.933503	EN 615.1-6-32-BS	EN.933504	EN 615.1-6-32-BS/LE	6-32	0.04	0.37	0.06	0	2	0
EN.933513	EN 615.1-8-32-BS	EN.933514	EN 615.1-8-32-BS/LE	8-32	0.07	0.44	0.05	2	5	0
EN.933523	EN 615.1-8-36-BS	EN.933524	EN 615.1-8-36-BS/LE	8-36	0.07	0.44	0.05	2	5	0
EN.933533	EN 615.1-10-32-BS	EN.933534	EN 615.1-10-32-BS/LE	10-32	0.09	0.47	0.06	3	6	0
EN.933543	EN 615.1-1/4-20-BS	EN.933544	EN 615.1-1/4-20-BS/LE	1/4-20	0.12	0.53	0.07	3	10	0.01
EN.933563	EN 615.1-5/16-18-BS	EN.933564	EN 615.1-5/16-18-BS/LE	5/16-18	0.13	0.58	0.08	4	13	0.01
EN.933573	EN 615.1-3/8-16-BS	EN.933574	EN 615.1-3/8-16-BS/LE	3/8-16	0.19	0.62	0.11	5	16	0.01
EN.933583	EN 615.1-1/2-13-BS	EN.933584	EN 615.1-1/2-13-BS/LE	1/2-13	0.25	0.75	0.15	5	22	0.03
EN.933593	EN 615.1-5/8-11-BS	EN.933594	EN 615.1-5/8-11-BS/LE	5/8-11	0.31	1.06	0.21	7	44	0.06

Indexing and positioning elements