

THREADED BODY

AISI 303 stainless steel, screwdriver slotted head.

STANDARD EXECUTIONS

Hardened stainless steel ball and stainless steel spring.

- **EN 615-NI-LN**: light end force (marked with one line).
- **EN 615-NI-KN**: normal end force.
- **EN 615-NI-KSN**: heavy end force (marked with two lines).
- **EN 615-NI-LN/LE**: light end force with locking patch (marked with one line).
- **EN 615-NI-KN/LE**: normal end force with locking patch.
- **EN 615-NI-KSN/LE**: heavy end force with locking patch (marked with two lines).

Nylon locking patch for applications subject to vibrations or to eliminate the need for check nuts. Not recommended for applications in soft materials.

Countersink the mating thread at least .030 to .045 larger than the major diameter of the plunger to make insertion of the plunger easier.

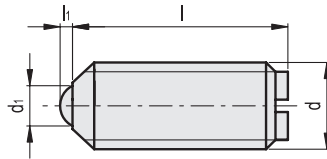

EN 615-NI-LN

EN 615-NI-LN/LE

INOX STAINLESS STEEL INCH

Code	Description	Code	Description	d	d1	l	l1	Spring preload [lb _f]	Spring max load [lb _f]	⚖️
EN.933211	EN 615-10-32-LN	EN.933212	EN 615-10-32-LN/LE	10-32	0.09	0.52	0.02	1	2	0
EN.933221	EN 615-1/4-20-LN	EN.933222	EN 615-1/4-20-LN/LE	1/4-20	0.13	0.53	0.04	2	4	0
EN.933241	EN 615-5/16-18-LN	EN.933242	EN 615-5/16-18-LN/LE	5/16-18	0.16	0.58	0.04	2	5	0.01
EN.933251	EN 615-3/8-16-LN	EN.933252	EN 615-3/8-16-LN/LE	3/8-16	0.19	0.63	0.05	2	5	0.01
EN.933261	EN 615-1/2-13-LN	EN.933262	EN 615-1/2-13-LN/LE	1/2-13	0.28	0.75	0.07	3	6	0.03
EN.933271	EN 615-5/8-11-LN	EN.933272	EN 615-5/8-11-LN/LE	5/8-11	0.98	0.98	0.09	4	9	0.06

EN 615-NI-KN

EN 615-NI-KN/LE

INOX STAINLESS STEEL INCH

Code	Description	Code	Description	d	d1	l	l1	Spring preload [lb _f]	Spring max load [lb _f]	⚖️
EN.933199	EN 615-4-48-KN	EN.933200	EN 615-4-48-KN/LE	4-48	0.06	0.19	0.02	0	0	0
EN.933201	EN 615-5-40-KN	EN.933202	EN 615-5-40-KN/LE	5-40	0.06	0.25	0.02	0	1	0
EN.933203	EN 615-6-32-KN	EN.933204	EN 615-6-32-KN/LE	6-32	0.08	0.31	0.02	0	1	0
EN.933205	EN 615-6-40-KN	EN.933206	EN 615-6-40-KN/LE	6-40	0.08	0.31	0.02	0	1	0
EN.933207	EN 615-8-32-KN	EN.933208	EN 615-8-32-KN/LE	8-32	0.09	0.34	0.02	1	1	0
EN.933209	EN 615-8-36-KN	EN.933210	EN 615-8-36-KN/LE	8-36	0.09	0.34	0.02	1	1	0
EN.933213	EN 615-10-32-KN	EN.933214	EN 615-10-32-KN/LE	10-32	0.09	0.52	0.02	2	3	0
EN.933223	EN 615-1/4-20-KN	EN.933224	EN 615-1/4-20-KN/LE	1/4-20	0.13	0.53	0.04	4	7	0
EN.933243	EN 615-5/16-18-KN	EN.933244	EN 615-5/16-18-KN/LE	5/16-18	0.16	0.58	0.04	4	8	0.01
EN.933253	EN 615-3/8-16-KN	EN.933254	EN 615-3/8-16-KN/LE	3/8-16	0.19	0.63	0.05	5	10	0.01
EN.933263	EN 615-1/2-13-KN	EN.933264	EN 615-1/2-13-KN/LE	1/2-13	0.28	0.75	0.07	6	12	0.03
EN.933273	EN 615-5/8-11-KN	EN.933274	EN 615-5/8-11-KN/LE	5/8-11	0.98	0.98	0.09	9	18	0.06

EN 615-NI-KSN

EN 615-NI-KSN/LE

INOX STAINLESS STEEL INCH

Code	Description	Code	Description	d	d1	l	l1	Spring preload [lb _f]	Spring max load [lb _f]	⚖️
EN.933215	EN 615-10-32-KSN	EN.933216	EN 615-10-32-KSN/LE	10-32	0.09	0.52	0.02	3	5	0
EN.933225	EN 615-1/4-20-KSN	EN.933226	EN 615-1/4-20-KSN/LE	1/4-20	0.13	0.53	0.04	6	9	0
EN.933245	EN 615-5/16-18-KSN	EN.933246	EN 615-5/16-18-KSN/LE	5/16-18	0.16	0.58	0.04	6	11	0.01
EN.933255	EN 615-3/8-16-KSN	EN.933256	EN 615-3/8-16-KSN/LE	3/8-16	0.19	0.63	0.05	8	15	0.01
EN.933265	EN 615-1/2-13-KSN	EN.933266	EN 615-1/2-13-KSN/LE	1/2-13	0.28	0.75	0.07	6	24	0.03
EN.933275	EN 615-5/8-11-KSN	EN.933276	EN 615-5/8-11-KSN/LE	5/8-11	0.98	0.98	0.09	7	40	0.06

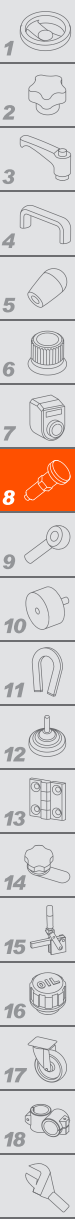

Indexing and positioning elements