

# EN 615 | Ball spring plungers

Threaded body, Steel

INCH



- 1
- 2
- 3
- 4
- 5
- 6
- 7
- 8
- 9
- 10
- 11
- 12
- 13
- 14
- 15
- 16
- 17
- 18

## THREADED BODY

Black-oxide steel, screwdriver slotted head.

## STANDARD EXECUTIONS

Hardened stainless steel ball and stainless steel spring.

- **EN 615-L**: light end force (marked with one line).
- **EN 615-K**: normal end force.
- **EN 615-KS**: heavy end force (marked with two lines).
- **EN 615-L/LE**: light end force with locking patch (marked with one line).
- **EN 615-K/LE**: normal end force with locking patch.
- **EN 615-KS/LE**: heavy end force with locking patch (marked with two lines).

Nylon locking patch for applications subject to vibrations or to eliminate the need for check nuts. Not recommended for applications in soft materials.

Countersink the mating thread at least .030 to .045 larger than the major diameter of the plunger to make insertion of the plunger easier.

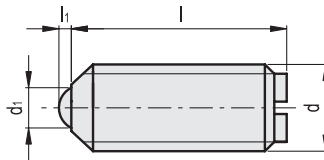

## EN 615-L

## EN 615-L/LE

INCH

Code	Description	Code	Description	d	d1	l	l1	Spring preload [lbf]	Spring max load [lbf]	⚖️
EN.933111	EN 615-10-32-L	EN.933112	EN 615-10-32-L/LE	10-32	0.09	0.52	0.02	1	2	0
EN.933121	EN 615-1/4-20-L	EN.933122	EN 615-1/4-20-L/LE	1/4-20	0.13	0.53	0.04	2	4	0
EN.933141	EN 615-5/16-18-L	EN.933142	EN 615-5/16-18-L/LE	5/16-18	0.16	0.58	0.04	2	5	0.01
EN.933151	EN 615-3/8-16-L	EN.933152	EN 615-3/8-16-L/LE	3/8-16	0.19	0.63	0.05	2	5	0.01
EN.933161	EN 615-1/2-13-L	EN.933162	EN 615-1/2-13-L/LE	1/2-13	0.28	0.75	0.07	3	6	0.03
EN.933171	EN 615-5/8-11-L	EN.933172	EN 615-5/8-11-L/LE	5/8-11	0.98	0.98	0.09	4	9	0.06

## EN 615-K

## EN 615-K/LE

INCH

Code	Description	Code	Description	d	d1	l	l1	Spring preload [lbf]	Spring max load [lbf]	⚖️
EN.933099	EN 615-4-48-K	EN.933100	EN 615-4-48-K/LE	4-48	0.06	0.19	0.02	0	0	0
EN.933101	EN 615-5-40-K	EN.933102	EN 615-5-40-K/LE	5-40	0.06	0.25	0.02	0	1	0
EN.933103	EN 615-6-32-K	EN.933104	EN 615-6-32-K/LE	6-32	0.08	0.31	0.02	0	1	0
EN.933105	EN 615-6-40-K	EN.933106	EN 615-6-40-K/LE	6-40	0.08	0.31	0.02	0	1	0
EN.933107	EN 615-8-32-K	EN.933108	EN 615-8-32-K/LE	8-32	0.09	0.34	0.02	1	1	0
EN.933109	EN 615-8-36-K	EN.933110	EN 615-8-36-K/LE	8-36	0.09	0.34	0.02	1	1	0
EN.933113	EN 615-10-32-K	EN.933114	EN 615-10-32-K/LE	10-32	0.09	0.52	0.02	2	3	0
EN.933123	EN 615-1/4-20-K	EN.933124	EN 615-1/4-20-K/LE	1/4-20	0.13	0.53	0.04	4	7	0
EN.933143	EN 615-5/16-18-K	EN.933144	EN 615-5/16-18-K/LE	5/16-18	0.16	0.58	0.04	4	8	0.01
EN.933153	EN 615-3/8-16-K	EN.933154	EN 615-3/8-16-K/LE	3/8-16	0.19	0.63	0.05	5	10	0.01
EN.933163	EN 615-1/2-13-K	EN.933164	EN 615-1/2-13-K/LE	1/2-13	0.28	0.75	0.07	6	12	0.03
EN.933173	EN 615-5/8-11-K	EN.933174	EN 615-5/8-11-K/LE	5/8-11	0.98	0.98	0.09	9	18	0.06

## EN 615-KS

## EN 615-KS/LE

INCH

Code	Description	Code	Description	d	d1	l	l1	Spring preload [lbf]	Spring max load [lbf]	⚖️
EN.933115	EN 615-10-32-KS	EN.933116	EN 615-10-32-KS/LE	10-32	0.09	0.52	0.02	3	5	0
EN.933125	EN 615-1/4-20-KS	EN.933126	EN 615-1/4-20-KS/LE	1/4-20	0.13	0.53	0.04	6	9	0
EN.933145	EN 615-5/16-18-KS	EN.933146	EN 615-5/16-18-KS/LE	5/16-18	0.16	0.58	0.04	6	11	0.01
EN.933155	EN 615-3/8-16-KS	EN.933156	EN 615-3/8-16-KS/LE	3/8-16	0.19	0.63	0.05	8	15	0.01
EN.933165	EN 615-1/2-13-KS	EN.933166	EN 615-1/2-13-KS/LE	1/2-13	0.28	0.75	0.07	6	24	0.03
EN.933175	EN 615-5/8-11-KS	EN.933176	EN 615-5/8-11-KS/LE	5/8-11	0.98	0.98	0.09	7	40	0.06

Indexing and positioning elements