

MATERIAL

Glass-fibre reinforced polyamide based (PA) technopolymer, white colour similar to RAL 9002, matte finish.

SCREW-COVERS

Glass-fibre reinforced polyamide based (PA) technopolymer, white colour similar to RAL 9002, matte finish.

Supplied, press-fit assembly, removable by a screwdriver.

STANDARD EXECUTION

Pass-through holes for front or rear mounting by means of cylindrical-head screws with hexagon socket, hexagonal-head screws or nuts.

Suggested tightening torque:

- back mounting with plain holes: 10 [Nm]
- front mounting with plain or tapped holes: 10 [Nm].

FEATURES AND APPLICATIONS

Particularly suitable for applications on medical and hospital equipment and on food processing machines whose parts, for hygienic reasons, must be frequently cleaned.

TECHNICAL DATA

The values F1, F2, L1 and L2 indicated in the table were obtained carried out with the appropriate dynamometric equipment under the test conditions shown in the figure with ambient temperature.



ERGOSTYLE® ELESA Original design

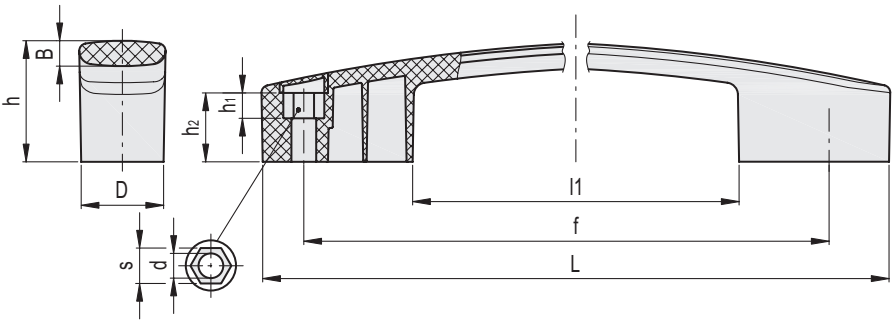
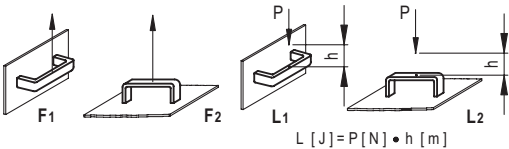

Conversion Table 1 mm = 0,039 inch					
L		d		s	
mm	inch	mm	inch	mm	inch
335	13.07	8.5	0.33	13	0.51
		10.5	0.41	17	0.66

												METRIC						
Code	Description	L	f	d	s	D	h	h1	h2	B	l1	F1* [N]	F1# [N]	F2* [N]	F2# [N]	L1# [J]	L2# [J]	⚖
150451	EBP-L.335-8-CLEAN	335	300±1	8.5	13	35.5	51	10.5	28.5	10.5	210	1000	2500	1000	5000	44	14	205
150452	EBP-L.335-10-CLEAN	335	300±1	10.5	17	35.5	51	10.5	28.5	10.5	210	1000	2500	1000	5000	44	14	201

* Maximum working load

Load at breakage.