

STANDARD EXECUTIONS

- **DVM.5**: bushing with threaded blind hole and base plate in polished zinc-plated steel, vibration-damper body in natural rubber NR, black colour, hardness 40, 55, 70 Shore A ±5.
- **DVM.5-SST**: bushing with threaded blind hole and base plate in AISI 304 stainless steel, vibration-damper body in natural rubber NR, black colour, hardness 55 Shore A ±5.

FEATURES AND APPLICATIONS

The special concave shape of the support surface provides optimal adaptation to uneven surfaces.

The rubber buffers have been designed to damp vibrations, shocks and noises produced by moving bodies or non-balanced vibrating masses of equipment and machines which can cause:

- malfunctioning and reduction of the machine lifespan and/or of the adjacent ones;
- damage to health;
- noise.

Load diagrams for each single code are available on request. See Technical data and guidelines for the choice (on page 728).

SPECIAL EXECUTIONS ON REQUEST

Natural rubber NR, hardness 40, 70 tolerance ±5 Shore A for executions with AISI 304 stainless steel base.



Conversion Table	
1 mm = 0,039 inch	
D	
mm	inch
15	0.59
20	0.78
25	0.98
30	1.17
40	1.56
50	1.95
70	2.73
75	2.93
100	3.90

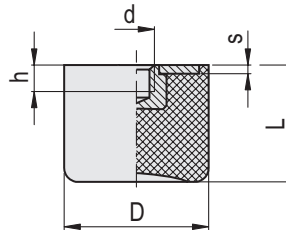

DVM.5

METRIC

Code	Description	D	L	d	h	s	⚖️
437036	DVM.5-15-14-M4-40	15	14	M4	4	1.4	4
437037	DVM.5-15-14-M4-55	15	14	M4	4	1.4	4
437038	DVM.5-15-14-M4-70	15	14	M4	4	1.4	4
437041	DVM.5-20-23,5-M6-40	20	23.5	M6	6	2	11
437042	DVM.5-20-23,5-M6-55	20	23.5	M6	6	2	11
437043	DVM.5-20-23,5-M6-70	20	23.5	M6	6	2	11
437046	DVM.5-25-18,5-M6-40	25	18.5	M6	6	2	15
437047	DVM.5-25-18,5-M6-55	25	18.5	M6	6	2	15
437048	DVM.5-25-18,5-M6-70	25	18.5	M6	6	2	15
437051	DVM.5-30-28,5-M8-40	30	28.5	M8	8	2	31
437052	DVM.5-30-28,5-M8-55	30	28.5	M8	8	2	31
437053	DVM.5-30-28,5-M8-70	30	28.5	M8	8	2	31
437056	DVM.5-40-28-M8-40	40	28	M8	8	2	54
437057	DVM.5-40-28-M8-55	40	28	M8	8	2	54
437058	DVM.5-40-28-M8-70	40	28	M8	8	2	54
437061	DVM.5-50-28-M10-40	50	28	M10	10	2	83
437062	DVM.5-50-28-M10-55	50	28	M10	10	2	83
437063	DVM.5-50-28-M10-70	50	28	M10	10	2	83
437066	DVM.5-70-43-M10-40	70	43	M10	10	3	223
437067	DVM.5-70-43-M10-55	70	43	M10	10	3	223
437068	DVM.5-70-43-M10-70	70	43	M10	10	3	223
437071	DVM.5-75-37-M12-40	75	37	M12	12	3	230
437072	DVM.5-75-37-M12-55	75	37	M12	12	3	230
437073	DVM.5-75-37-M12-70	75	37	M12	12	3	230
437076	DVM.5-100-50-M16-40	100	50	M16	16	3	590
437077	DVM.5-100-50-M16-55	100	50	M16	16	3	590
437078	DVM.5-100-50-M16-70	100	50	M16	16	3	590

DVM.5-SST

INOX STAINLESS STEEL

METRIC

Code	Description	D	L	d	h	s	⚖️
437090	DVM.5-15-14-SST-M4-55	15	14	M4	4	1.4	4
437091	DVM.5-20-23,5-SST-M6-55	20	23.5	M6	6	2	14
437092	DVM.5-25-18,5-SST-M6-55	25	18.5	M6	6	2	15
437093	DVM.5-30-28,5-SST-M8-55	30	28.5	M8	8	2	28
437094	DVM.5-40-28-SST-M8-55	40	28	M8	8	2	54
437095	DVM.5-50-28-SST-M10-55	50	28	M10	10	2	85
437096	DVM.5-70-43-SST-M10-55	70	43	M10	10	3	224
437097	DVM.5-75-37-SST-M12-55	75	37	M12	12	3	232
437098	DVM.5-100-50-SST-M16-55	100	50	M16	16	3	590