



STANDARD EXECUTIONS

- **DVM.4:** threaded stud and base plate in polished zinc-plated steel, vibration-damper body in natural rubber NR, black colour, hardness 40, 55, 70 Shore A ± 5 .
- **DVM.4-SST:** threaded stud and base plate in INOX AISI 304 stainless steel, vibration-damper body in natural rubber NR, black colour, hardness 55 Shore A ± 5 .

FEATURES AND APPLICATIONS

The special concave shape of the support surface provides optimal adaptation to uneven surfaces.

The rubber buffers have been designed to damp vibrations, shocks and noises produced by moving bodies or non-balanced vibrating masses of equipment and machines which can cause:

- malfunctioning and reduction of the machine lifespan and/or of the adjacent ones;
- damage to health;
- noise.

Load diagrams for each single code are available on request. See Technical data and guidelines for the choice (on page 728).

SPECIAL EXECUTIONS ON REQUEST

Natural rubber NR, hardness 40, 70 tolerance ± 5 Shore A for executions with AISI 304 stainless steel base.



Conversion Table	
1 mm = 0.039 inch	
D	
mm	inch
15	0.59
20	0.78
25	0.98
30	1.17
40	1.56
50	1.95
70	2.73
75	2.93
100	3.90

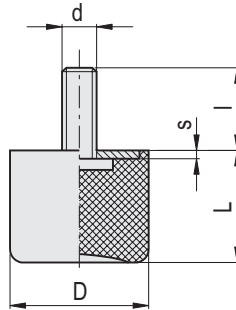

DVM.4

Code	Description	D	L	d	l	s	⚖️
436991	DVM.4-15-14-M4-10-40	15	14	M4	10	1.4	5
436992	DVM.4-15-14-M4-10-55	15	14	M4	10	1.4	5
436993	DVM.4-15-14-M4-10-70	15	14	M4	10	1.4	5
436996	DVM.4-20-23,5-M6-18-40	20	23.5	M6	18	2	14
436997	DVM.4-20-23,5-M6-18-55	20	23.5	M6	18	2	14
436998	DVM.4-20-23,5-M6-18-70	20	23.5	M6	18	2	14
437001	DVM.4-25-18,5-M6-18-40	25	18.5	M6	18	2	18
437002	DVM.4-25-18,5-M6-18-55	25	18.5	M6	18	2	18
437003	DVM.4-25-18,5-M6-18-70	25	18.5	M6	18	2	18
437006	DVM.4-30-28,5-M8-20-40	30	28.5	M8	20	2	36
437007	DVM.4-30-28,5-M8-20-55	30	28.5	M8	20	2	36
437008	DVM.4-30-28,5-M8-20-70	30	28.5	M8	20	2	36
437011	DVM.4-40-28-M8-23-40	40	28	M8	23	2	57
437012	DVM.4-40-28-M8-23-55	40	28	M8	23	2	57
437013	DVM.4-40-28-M8-23-70	40	28	M8	23	2	57
437016	DVM.4-50-28-M10-28-40	50	28	M10	28	2	97
437017	DVM.4-50-28-M10-28-55	50	28	M10	28	2	97
437018	DVM.4-50-28-M10-28-70	50	28	M10	28	2	97
437021	DVM.4-70-43-M10-27-40	70	43	M10	27	3	260
437022	DVM.4-70-43-M10-27-55	70	43	M10	27	3	260
437023	DVM.4-70-43-M10-27-70	70	43	M10	27	3	260
437026	DVM.4-75-37-M12-37-40	75	37	M12	37	3	259
437027	DVM.4-75-37-M12-37-55	75	37	M12	37	3	259
437028	DVM.4-75-37-M12-37-70	75	37	M12	37	3	259
437031	DVM.4-100-50-M16-41-40	100	50	M16	41	3	609
437032	DVM.4-100-50-M16-41-55	100	50	M16	41	3	609
437033	DVM.4-100-50-M16-41-70	100	50	M16	41	3	609



DVM.4-SST

Code	Description	D	L	d	l	s	⚖️
437081	DVM.4-15-14-SST-M4-10-55	15	14	M4	10	1.4	5
437082	DVM.4-20-23,5-SST-M6-18-55	20	23.5	M6	18	2	14
437083	DVM.4-25-18,5-SST-M6-18-55	25	18.5	M6	18	2	19
437084	DVM.4-30-28,5-SST-M8-20-55	30	28.5	M8	20	2	36
437085	DVM.4-40-28-SST-M8-23-55	40	28	M8	23	2	60
437086	DVM.4-50-28-SST-M10-28-55	50	28	M10	28	2	95
437087	DVM.4-70-43-SST-M10-28-55	70	43	M10	28	3	260
437088	DVM.4-75-37-SST-M12-37-55	75	37	M12	37	3	271
437089	DVM.4-100-50-SST-M16-41-55	100	50	M16	41	3	609

