

- 1
- 2
- 3
- 4
- 5
- 6
- 7
- 8
- 9
- 10
- 11
- 12
- 13
- 14
- 15
- 16
- 17
- 18
- 19

MATERIAL

Polypropylene-based (PP) technopolymer, high UV resistance, RAL 9005 black colour.

STANDARD EXECUTION

One fastening hole for hexagon head screw

WORKING TEMPERATURE

from -30 °C to +90 °C.

FEATURES AND APPLICATIONS

The double series tube clamp, in compliance with standard DIN 3015-3, allows rigid tubes or flexible cables to be securely fastened in parallel, reducing vibrations and noise.

The special internal knurling of the two half clamps enables a high level of grip between the clamp and the tube, thus ensuring high stability.

They are used in industrial hydraulics as a fastening system for the construction of rigid pipes (liquids or gases).

In mobile hydraulics (earth-moving machinery, agricultural vehicles) for the construction of hydraulic or pneumatic systems with flexible tubes or cables. They are also used in the rail and naval sectors.

Tube clamps technical data.

EXECUTIONS ON REQUEST

- Clamps for tubes with different diameters.
- Various materials and colours.

ACCESSORIES

For the assembly kit DCK-D.

- DCE-PU: top plate.
- DCE-PL: lower plate to be welded.
- DCE-SRE: hexagonal-head screw.
- DCE-GU: mounting guide.
- DCE-NTG: nut for mounting guide.

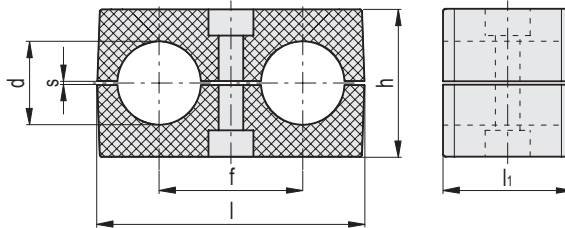

Code	Description	Group	d	d Tube [GAS]	f	l	l1	h	s	Fastening with screws		△
										Metric	UNC	
570381-C9	DCE-D-1-6-6-PP-C9	1	6	-	20	36	30	27	0.6	M 6	1/4-20	9
570383-C9	DCE-D-1-6.4-6.4-PP-C9	1	6.4	1/4	20	36	30	27	0.6	M 6	1/4-20	9
570385-C9	DCE-D-1-8-8-PP-C9	1	8	5/16	20	36	30	27	0.6	M 6	1/4-20	9
570387-C9	DCE-D-1-9.5-9.5-PP-C9	1	9.5	3/8	20	36	30	27	0.6	M 6	1/4-20	8
570389-C9	DCE-D-1-10-10-PP-C9	1	10	-	20	36	30	27	0.6	M 6	1/4-20	16
570391-C9	DCE-D-1-12-12-PP-C9	1	12	-	20	36	30	27	0.6	M 6	1/4-20	7
570393-C9	DCE-D-1-12.7-12.7-PP-C9	1	12.7	1/2	20	36	30	27	0.8	M 6	1/4-20	7
570401-C9	DCE-D-2-12-12-PP-C9	2	12	-	29	53	30	27	0.8	M 8	5/16-18	11
570403-C9	DCE-D-2-12.7-12.7-PP-C9	2	12.7	1/2	29	53	30	27	0.8	M 8	5/16-18	11
570405-C9	DCE-D-2-13.5-13.5-PP-C9	2	13.5	-	29	53	30	27	0.8	M 8	5/16-18	12
570407-C9	DCE-D-2-14-14-PP-C9	2	14	-	29	53	30	27	0.8	M 8	5/16-18	11
570409-C9	DCE-D-2-15-15-PP-C9	2	15	-	29	53	30	27	0.8	M 8	5/16-18	10
570411-C9	DCE-D-2-16-16-PP-C9	2	16	5/8	29	53	30	27	0.8	M 8	5/16-18	9
570413-C9	DCE-D-2-17.2-17.2-PP-C9	2	17.2	-	29	53	30	27	0.8	M 8	5/16-18	9
570415-C9	DCE-D-2-18-18-PP-C9	2	18	-	29	53	30	27	0.8	M 8	5/16-18	8
570421-C9	DCE-D-3-19-19-PP-C9	3	19	3/4	36	67	30	37	1	M 8	5/16-18	17
570423-C9	DCE-D-3-20-20-PP-C9	3	20	-	36	67	30	37	1	M 8	5/16-18	16
570425-C9	DCE-D-3-21.3-21.3-PP-C9	3	21.3	-	36	67	30	37	1	M 8	5/16-18	15
570427-C9	DCE-D-3-22-22-PP-C9	3	22	7/8	36	67	30	37	1	M 8	5/16-18	15
570429-C9	DCE-D-3-23-23-PP-C9	3	23	-	36	67	30	37	1	M 8	5/16-18	14
570431-C9	DCE-D-3-24-24-PP-C9	3	24	-	36	67	30	37	1	M 8	5/16-18	15
570433-C9	DCE-D-3-25-25-PP-C9	3	25	-	36	67	30	37	1	M 8	5/16-18	12
570435-C9	DCE-D-3-25.4-25.4-PP-C9	3	25.4	1	36	67	30	37	1	M 8	5/16-18	12
570441-C9	DCE-D-4-26.9-26.9-PP-C9	4	26.9	-	45	81	30	42	1	M 8	5/16-18	22
570443-C9	DCE-D-4-28-28-PP-C9	4	28	-	45	81	30	42	1	M 8	5/16-18	21
570445-C9	DCE-D-4-30-30-PP-C9	4	30	-	45	81	30	42	1	M 8	5/16-18	18
570451-C9	DCE-D-5-32-32-PP-C9	5	32	1 1/4	56	106	30	53	1.2	M 8	5/16-18	38
570453-C9	DCE-D-5-33.7-33.7-PP-C9	5	33.7	-	56	106	30	53	1.2	M 8	5/16-18	36
570455-C9	DCE-D-5-35-35-PP-C9	5	35	-	56	106	30	53	1.2	M 8	5/16-18	35
570457-C9	DCE-D-5-38-38-PP-C9	5	38	1 1/2	56	106	30	53	1.2	M 8	5/16-18	31
570459-C9	DCE-D-5-42.4-42.4-PP-C9	5	42.4	-	56	106	30	53	1.2	M 8	5/16-18	25