



**BODY WITH HANDLE AND COUPLING ELEMENT**  
Glass-fibre reinforced polyamide based (PA) technopolymer, white colour similar to RAL 9002, matte finish.

**BODY WITH LATCH**  
Acetal resin based technopolymer (POM), white colour similar to RAL 9002, matte finish.

**FEATURES AND APPLICATIONS**  
CMS-CLEAN integrates both functions of handle and snap lock into a single product.  
The door can be opened by pulling the handle towards the outside at the indicated triangular index point.  
The coupling element can be applied on a frame (Fig.1) or on a profile (Fig.2).  
Particularly suitable for use with medical and hospital equipment and machines for the food industry subject, for hygiene reasons, to frequent deep cleaning interventions.

- ASSEMBLY INSTRUCTIONS**
1. Drill the door following the supplied template.
  2. Fit the body with handle into the drilled door.
  3. Assemble the body with latch on the body with handle by the back of the door up to the stop and fit with self-tapping AISI 316 stainless steel screws (included in the supply).
  4. If you have a frame, drill two holes according to the template. For the correct positioning of the coupling element with respect to the latch, the reference notches on the coupling element and on the body with handle must be aligned.
  5. Fit the coupling element to the frame or to the profile by means of M5 cylindrical-head screws with hexagon socket (not supplied).

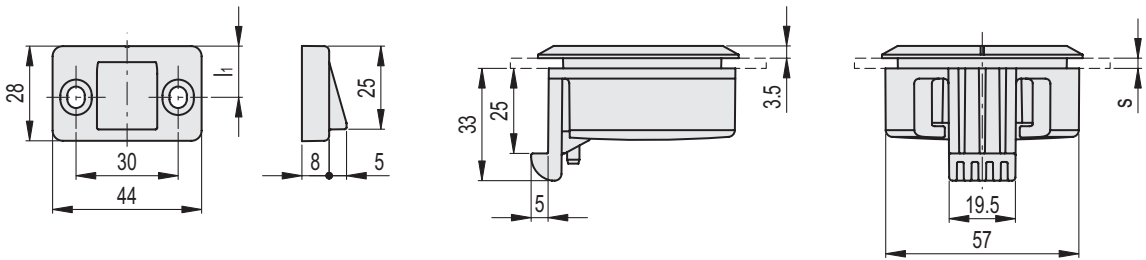
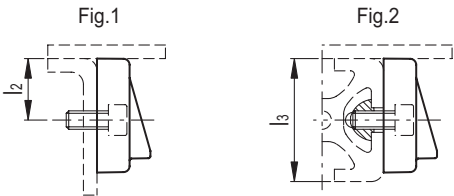
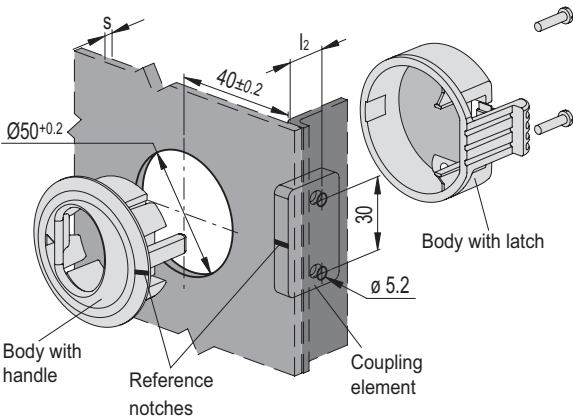

Conversion Table	
1 mm = 0,039 inch	
d	
mm	inch
15	0.59
20	0.78

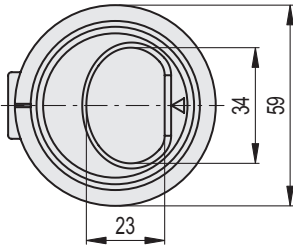
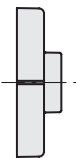

METRIC

Code	Description	l1	l2	l3	s	△△
151371	CMS.60-10-30-CLEAN	15	15	30	1 + 10	55
151376	CMS.60-10-40-CLEAN	20	20	40	1 + 10	55