



**SENSITIVITY**

- **6**: movement of the bubble by 2 mm for an inclination of the body of 6 angle minutes with respect to the horizontal surface.
- **50**: movement of the bubble by 2 mm for an inclination of the body of 50 angle minutes with respect to the horizontal surface.

**TYPES**

- Type **AV**: aligned, mounting from the front side (not adjustable)
- Type **JV**: adjustable, mounting from the front side

**Housing**

- Aluminium anodized, natural colour **AN**
- anodized, black **ANB**

- Spirit level element Glass body

- Contrast fluid green-transparent **G**

- Casting compound mineral-based

See Bull's eye levels and screw-on levels technical data (on page 780).

**FEATURES AND APPLICATIONS**

BEL-MB bull's eye levels are used to control the horizontal positioning of jigs, machines, devices, equipment and instruments.

The spirit levels of type AV are aligned in relation to the reference surface so that the bubble is centred in the middle of the marking lines once the horizontal position of the contact surface is reached.

The spirit levels of type JV are aligned during installation using the fastening holes.

The adjustment pin in the lower part allows the adjustment of the bubbles acting as a fulcrum point.

With careful tightening, it is possible to achieve an alignment that places the bubble between the middle marking lines.

**ON REQUEST**

- Filling, colourless-transparent
- Other sensitivities



**Application example**

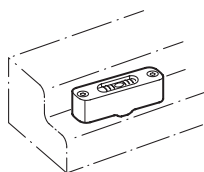

Conversion Table	
1 mm = 0.039 inch	
mm	inch
54	2.11

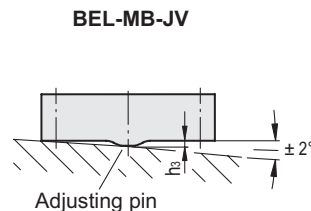
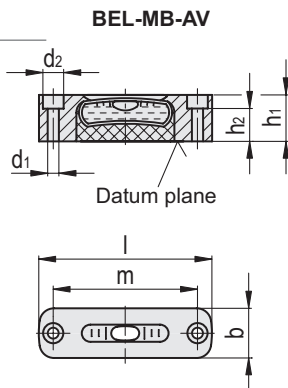

**BEL-MB-AV**

Code	Description	d1	d2	b	l	h1	h2	m	⚖
156611	BEL-MB-AN-54-G-6-AV	3.4	6.3	15.5	54	14.5	11.3	45	13
156601	BEL-MB-ANB-54-G-6-AV	3.4	6.3	15.5	54	14.5	11.3	45	13
156615	BEL-MB-AN-54-G-50-AV	3.4	6.3	15.5	54	14.5	11.3	45	13
156605	BEL-MB-ANB-54-G-50-AV	3.4	6.3	15.5	54	14.5	11.3	45	13

**BEL-MB-JV**

Code	Description	d1	d2	b	l	h1	h2	h3	m	⚖
156613	BEL-MB-AN-54-G-6-JV	3.4	6.3	15.5	54	14.5	11.3	1	45	13
156603	BEL-MB-ANB-54-G-6-JV	3.4	6.3	15.5	54	14.5	11.3	1	45	13
156617	BEL-MB-AN-54-G-50-JV	3.4	6.3	15.5	54	14.5	11.3	1	45	13
156607	BEL-MB-ANB-54-G-50-JV	3.4	6.3	15.5	54	14.5	11.3	1	45	13