



MATERIAL

Phenolic based (PF) Duroplast. White similar to RAL 9002, glossy finish.

STANDARD EXECUTION

AISI 303 stainless steel boss, threaded blind hole.

FEATURES AND APPLICATIONS (B.259-CLEAN)

B.259-CLEAN knob, thanks to its white colour and glossy finish, is particularly suitable for applications on medical and hospital equipment and on food processing machines whose parts, for hygienic reasons, must be frequently cleaned. Its solid shape without cavities prevents unhealthy residues from depositing.



ELESA Original design

| Conversion Table | |
|-------------------|------|
| 1 mm = 0.039 inch | |
| D | |
| mm | inch |
| 21 | 0.83 |
| 26 | 1.02 |
| 31 | 1.22 |

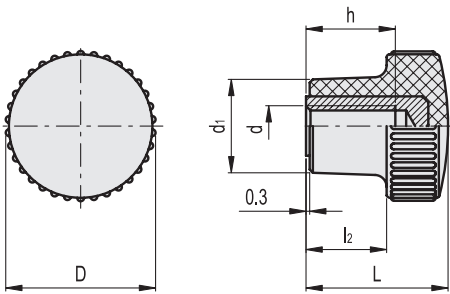

| Code | Description | D | d6H | L | d1 | l2 | h | ⌀ |
|--------|------------------------|----|-----|----|----|----|----|----|
| 151102 | B.259/20-SST-M6 CLEAN | 21 | M6 | 25 | 13 | 12 | 12 | 11 |
| 151112 | B.259/25-SST-M8 CLEAN | 26 | M8 | 28 | 16 | 15 | 13 | 19 |
| 151123 | B.259/30-SST-M10 CLEAN | 31 | M10 | 32 | 19 | 17 | 17 | 29 |