

- 1
- 2
- 3
- 4
- 5
- 6
- 7
- 8
- 9
- 10
- 11
- 12
- 13
- 14
- 15
- 16
- 17
- 18
- 19

MATERIAL

Polyamide based (PA) technopolymer, natural colour.

FEATURES AND APPLICATIONS

The flexible internal flanges on the washer ensure that the screw is securely tightened, preventing it from falling out.

It is made entirely from insulating material that is resistant to corrosion and chemicals. It is suitable for use in automotive applications, as well as in industry, aeronautics, electronics and in all cases where weight reduction is required.

The product is tested for mechanical and dimensional performance. Slight colour variations are perfectly normal and do not affect the quality of the product.

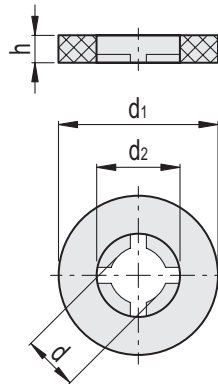

Code	Description	d	d1	d2	h	⚖️
505201	WAA-3.4-TP-N	3.5	9	5	1	1
505211	WAA-4.5-TP-N	4.5	10	7	1	1
505221	WAA-5.5-TP-N	5.5	12.5	9	1.5	1
505231	WAA-7.0-TP-N	7	16	11	1.5	1