

- 1
- 2
- 3
- 4
- 5
- 6
- 7
- 8
- 9
- 10
- 11
- 12
- 13
- 14
- 15
- 16
- 17
- 18

MATERIAL

Zinc-plated or lacquered steel housing.

STANDARD EXECUTIONS

Magnet in aluminium, nickel, cobalt (AlNiCo)

- **RMP-AN-RT**: red coloured lacquered steel housing, for temperatures up to 180°C.

- **RMP-AN-ZB**: zinc-plated steel housing, for temperatures up to 350°C. Retaining magnets technical data (on page 1052).

FEATURES AND APPLICATIONS

RMP cylindric retaining magnets are shielded magnetic systems with high performances and moderate overall dimensions.

For easier handling and for avoiding demagnetisation, these magnets have an iron plate on their adhesive surface.

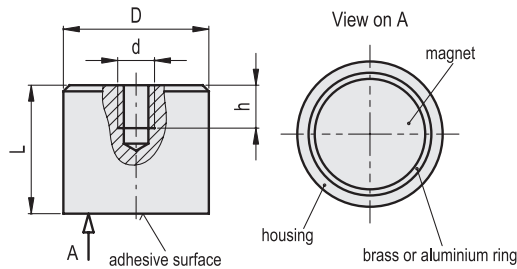

RMP-AN-RT

Code	Description	D	d	L	h	Nominal adhesive forces* [N]	⚖️
502701	RMP-AN-RT-12,5	12.5 ±0.2	M4	16 ±0.2	7	20	15
502711	RMP-AN-RT-17	17 ±0.2	M6	16 ±0.2	5	26	29
502721	RMP-AN-RT-21	21 ±0.2	M6	19 ±0.2	7	40	42
502731	RMP-AN-RT-27	27 ±0.2	M6	25 ±0.2	9	65	89
502741	RMP-AN-RT-35	35 ±0.2	M6	30 ±0.2	9	150	190

RMP-AN-ZB

Code	Description	D	d	L	h	Nominal adhesive forces* [N]	⚖️
502751	RMP-AN-ZB-12,5	12.5 ±0.1	M4	16 ±0.2	6	20	15
502753	RMP-AN-ZB-17	17 ±0.1	M6	16 ±0.2	5	26	29
502755	RMP-AN-ZB-21	21 ±0.1	M6	19 ±0.2	7	40	50
502757	RMP-AN-ZB-27	27 ±0.1	M6	25 ±0.2	8	65	98
502759	RMP-AN-ZB-35	35 ±0.1	M6	30 ±0.2	9	150	205

Industrial magnets

* The values of the nominal adhesive forces are approximate and refer to magnetic properties observed on laboratory samples.