

- 1
- 2
- 3
- 4
- 5
- 6
- 7
- 8
- 9
- 10
- 11
- 12
- 13
- 14
- 15
- 16
- 17
- 18
- 19

MATERIAL

Thermoplastic elastomer (TPE).

FEATURES AND APPLICATIONS

They are used as an alternative to the sealing inserts present in cable glands when more than one cable needs to be routed through the same cable gland; they can be used interchangeably with both CGT technopolymer cable glands and CGM metal cable glands.

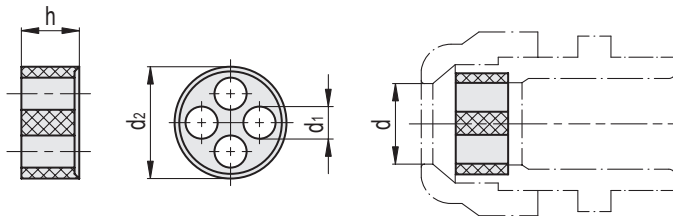
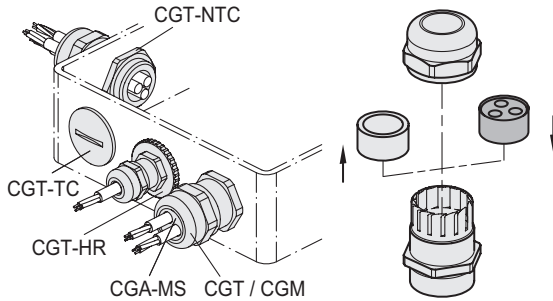

CGA-MS

Code	Description	d	d ₁	d ₂	h	Number of holes	For cable glands	⚖️
561101	CGA-MS-11-3-2-TPE	8	3	10.6	7.5	2	CGT-8 / CGM-8	1
561103	CGA-MS-11-2-3-TPE	8	2	10.6	7.5	3	CGT-8 / CGM-8	1
561105	CGA-MS-11-2-4-TPE	8	2	10.6	7.5	4	CGT-8 / CGM-8	1
561107	CGA-MS-11-3-4-TPE	8	3	10.6	7.5	4	CGT-8 / CGM-8	1
561109	CGA-MS-13-4-2-TPE	10	4	13.3	8.5	2	CGT-10 / CGM-10	1
561111	CGA-MS-13-5-2-TPE	10	5	13.3	8.5	2	CGT-10 / CGM-10	1
561113	CGA-MS-13-4-3-TPE	10	4	13.3	8.5	3	CGT-10 / CGM-10	1
561115	CGA-MS-13-5-3-TPE	10	5	13.3	8.5	3	CGT-10 / CGM-10	1
561117	CGA-MS-15-5-2-TPE	12	5	15.3	8.5	2	CGT-12 / CGM-12	5
561119	CGA-MS-15-6-2-TPE	12	6	15.3	8.5	2	CGT-12 / CGM-12	2
561121	CGA-MS-15-4-3-TPE	12	4	15.3	8.5	3	CGT-12 / CGM-12	1
561123	CGA-MS-15-5-3-TPE	12	5	15.3	8.5	3	CGT-12 / CGM-12	1
561125	CGA-MS-17-4-2-TPE	14	4	17.4	9	2	CGT-14 / CGM-14	5
561127	CGA-MS-17-6-2-TPE	14	6	17.4	9	2	CGT-14 / CGM-14	2
561129	CGA-MS-17-4-3-TPE	14	4	17.4	9	3	CGT-14 / CGM-14	2
561131	CGA-MS-17-6-3-TPE	14	6	17.4	9	3	CGT-14 / CGM-14	5
561133	CGA-MS-17-5-4-TPE	14	5	17.4	9	4	CGT-14 / CGM-14	5
561135	CGA-MS-17-6-4-TPE	14	6	17.4	9	4	CGT-14 / CGM-14	1
561137	CGA-MS-17-4-5-TPE	14	4	17.4	9	5	CGT-14 / CGM-14	2
561157	CGA-MS-20-6-2-TPE	17	6	19.8	9.3	2	CGT-17 / CGM-17	3
561159	CGA-MS-20-8-2-TPE	17	8	19.8	9.3	2	CGT-17 / CGM-17	2
561161	CGA-MS-20-6-3-TPE	17	6	19.8	9.3	3	CGT-17 / CGM-17	2
561139	CGA-MS-22-7-2-TPE	18	7	22.2	11	2	CGT-18 / CGM-18	5
561141	CGA-MS-22-8-2-TPE	18	8	22.2	11	2	CGT-18 / CGM-18	5
561143	CGA-MS-22-9-2-TPE	18	9	22.2	11	2	CGT-18 / CGM-18	3
561145	CGA-MS-22-7-3-TPE	18	7	22.2	11	3	CGT-18 / CGM-18	3
561147	CGA-MS-22-8-3-TPE	18	8	22.2	11	3	CGT-18 / CGM-18	3
561149	CGA-MS-22-5-4-TPE	18	5	22.2	11	4	CGT-18 / CGM-18	5
561151	CGA-MS-22-7-4-TPE	18	7	22.2	11	4	CGT-18 / CGM-18	5
561163	CGA-MS-25-7-4-TPE	21	7	25.1	13	4	CGT-21 / CGM-21	5
561165	CGA-MS-25-8-4-TPE	21	8	25.1	13	4	CGT-21 / CGM-21	3
561167	CGA-MS-25-6-6-TPE	21	6	25.1	13	6	CGT-21 / CGM-21	4
561153	CGA-MS-30-8,5-5-TPE	25	8,5	29.8	13	5	CGT-25 / CGM-25	6
561155	CGA-MS-30-5-8-TPE	25	5	29.8	13	8	CGT-25 / CGM-25	8

Standard machine parts