



**STANDARD EXECUTIONS**

- **BEL-PM-AN-A**: anodised aluminium body natural colour, with smooth reference surface.
- **BEL-PM-ANB-A**: anodised aluminium body black colour, with smooth reference surface.
- **BEL-PM-AN-B**: anodised aluminium body natural colour, with threaded pin.
- **BEL-PM-ANB-B**: anodised aluminium body black colour, with threaded pin.

See Bull's eye levels and screw-on levels technical data (on page 780).

**FLUID HOUSING**

Transparent polyamide based technopolymer.

**CONTRAST FLUID**

**K**: colourless.

**SENSITIVITY OF THE BULL'S EYE LEVEL**

# 30: movement of the bubble by 2 mm for an inclination of the body of 30 angle minutes with respect to the horizontal surface.

**REAR INSULATION**

Hemihydrate gypsum.

**FEATURES AND APPLICATIONS**

BEL-PM bull's eye levels are used to control the horizontal positioning of jigs, machines, devices, equipment and instruments.

BEL-PM-A executions are generally used as a tool, for example at different measurement points.

BEL-PM-B executions are directly fitted with the threaded pin on the machine body.

The alignment with respect to the reference surface or to the contact surface is reached when the bubble is in the center of the circular marking.



**BEL-PM-AN-A**  
**BEL-PM-ANB-A**

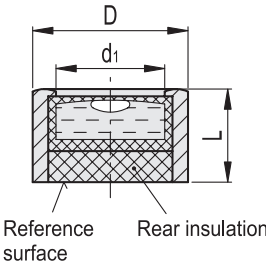

**BEL-PM-AN-B**  
**BEL-PM-ANB-B**

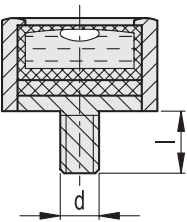

Circular marking

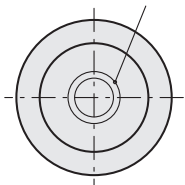

**BEL-PM-AN-A**  
**BEL-PM-ANB-A**

Code	Description	D	d1	L	⚖
156451	BEL-PM-AN-14-K-30-A	14	10	7.7	2
156454	BEL-PM-AN-20-K-30-A	20	14	13	4
156457	BEL-PM-AN-30-K-30-A	30	21	15	7
156471	BEL-PM-ANB-14-K-30-A	14	10	9.5	2
156474	BEL-PM-ANB-20-K-30-A	20	14	13	4
156477	BEL-PM-ANB-30-K-30-A	30	21	15	7

**BEL-PM-AN-B**  
**BEL-PM-ANB-B**

Code	Description	D	d	d1	L	l	⚖
156452	BEL-PM-AN-14-K-30-B	14	M 4	10	7.7	5	2
156455	BEL-PM-AN-20-K-30-B	20	M 5	14	13	6	4
156468	BEL-PM-AN-30-K-30-B	30	M 6	21	15	7.5	7
156472	BEL-PM-ANB-14-K-30-B	14	M 4	10	9.5	5	2
156475	BEL-PM-ANB-20-K-30-B	20	M 5	14	13	6	4
156478	BEL-PM-ANB-30-K-30-B	30	M 6	21	15	7.5	7