



1

BRACKET

Glass-fibre reinforced polyamide based (PA) technopolymer, RAL 5005 blue colour, matte finish.



2

BUSHINGS AND WASHERS

AISI 304 stainless steel.



3

BEARING

High quality with traceability codes. Chrome steel.



4

LUBRICATOR

Straight type, in AISI 303 stainless steel with 1/8 gas thread.



5

PACKING RINGS

NBR rubber.



6

COVER

Glass-fibre reinforced polypropylene based (PP) technopolymer, RAL 5015 blue colour, matte finish.

Closed cap for head bracket or for pass-through shafts.



7

STANDARD EXECUTIONS

- **UCFL-S-T**: head bracket with closed cover.
- **UCFL-S-P**: bracket for pass-through shaft with drilled cover and NBR rubber packing ring for rotating shafts.



8

FEATURES AND APPLICATIONS

Overall dimensions are in compliance with ISO 3228.

A system of completely sealed packing rings assures the protection of the bearing from dirt ingress. The reduced contact surface of the support base allows for maximum sanitisation.

Max shaft misalignment = 2,5°.



9

INSTRUCTIONS OF USE

Assembly with shafts without end stops. For optimum operation, we recommend periodic lubrication with a common grease resistant to high temperatures and oxidation.



10

SPECIAL EXECUTIONS ON REQUEST

- AISI 440C stainless steel bearing.
- Bearing in inch sizes.
- Brackets for shafts with diameters in different sizes.
- Brackets in polyamide-based (PA) technopolymer, RAL 5005 blue colour, compliant with FDA standards.
- Brackets in polypropylene based (PP) technopolymer, packing rings and oil seal in VITON®*.

* Registered trademark by DuPont Dow Elastomers.



11



12



13



14



15



16



17



18



19



20

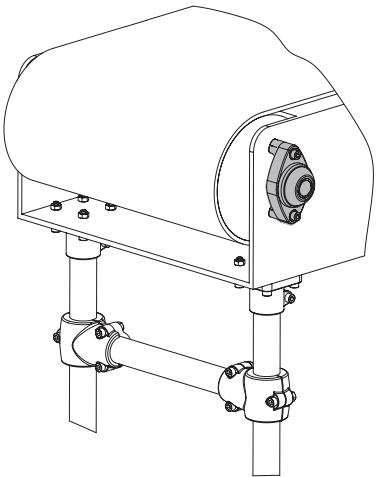

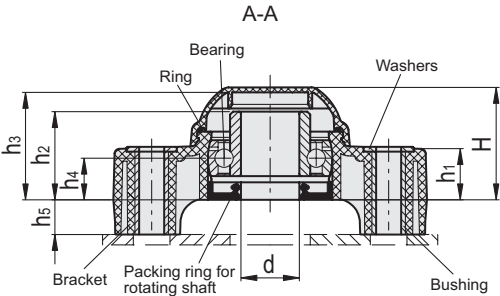
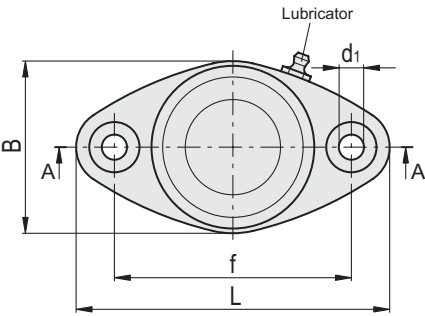

UCFL-S-T

Code	Description	d	d1	H	L	B	f	h1	h2	h3	h4	h5	Bearing static load [N]	Bearing dynamic load [N]	Bracket load [N]	⚖
419453	UCFL.205-S-B-25-T-C55	25	10.5	49.5	131	72	99	22	36.9	47	17.4	15	7800	14000	10000	380
419463	UCFL.206-S-B-30-T-C55	30	10.5	55	149	86	117	26	41	52.5	20	15	11300	19500	13000	468

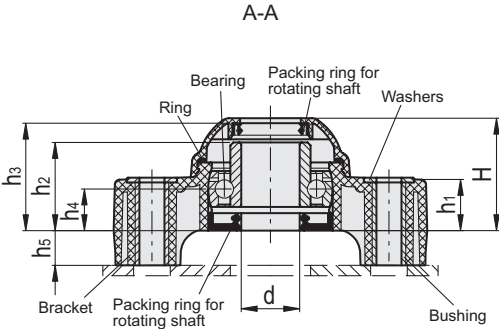
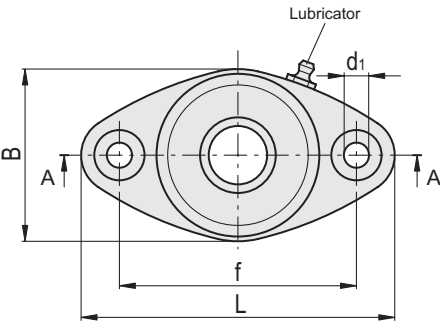

UCFL-S-P

Code	Description	d	d1	H	L	B	f	h1	h2	h3	h4	h5	Bearing static load [N]	Bearing dynamic load [N]	Bracket load [N]	⚖
419403	UCFL.205-S-B-25-P-C55	25	10.5	49.5	131	72	99	22	36.9	47	17.4	15	7800	14000	10000	380
419413	UCFL.206-S-B-30-P-C55	30	10.5	55	149	86	117	26	41	52.5	20	15	11300	19500	13000	468