



BRACKET

Glass-fibre reinforced polyamide based (PA) technopolymer, RAL 5005 blue colour, matte finish.

BUSHINGS AND WASHERS

AISI 304 stainless steel.

BEARING

High quality with traceability codes. Chrome steel.

LUBRICATOR

Straight type, in stainless steel with 1/8 gas thread.

PACKING RINGS

NBR rubber.

COVER

Glass-fibre reinforced polypropylene based (PP) technopolymer, RAL 5015 blue colour, matte finish.

Closed cap for head bracket or for pass-through shafts.

STANDARD EXECUTIONS

- **UCF-S-T**: head bracket with closed cover.
- **UCF-S-P**: bracket for pass-through shaft with drilled cover and NBR rubber packing ring for rotating shafts.

FEATURES AND APPLICATIONS

Overall dimensions are in compliance with ISO 3228.

A system of completely sealed packing rings assures the protection of the bearing from dirt ingress. The reduced contact surface of the support base allows for maximum sanitisation.

Max shaft misalignment = 2,5°.

INSTRUCTIONS OF USE

Assembly with shafts without end stops. For optimum operation, we recommend periodic lubrication with a common grease resistant to high temperatures and oxidation.

SPECIAL EXECUTIONS ON REQUEST

- AISI 440C stainless steel bearing.
- Bearing in inch sizes.
- Brackets for shafts with diameters in different sizes.
- Brackets in polyamide-based (PA) technopolymer, RAL 5005 blue colour, compliant with FDA standards.
- Brackets in polypropylene based (PP) technopolymer, packing rings and oil seal in VITON®*.

* Registered trademark by DuPont Dow Elastomers.

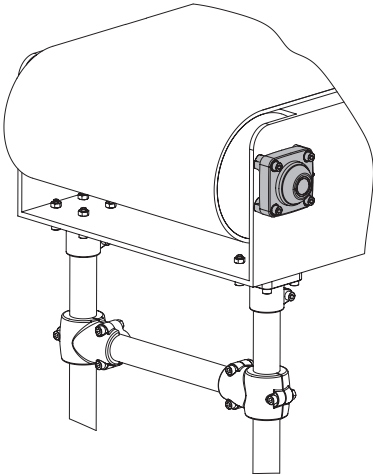

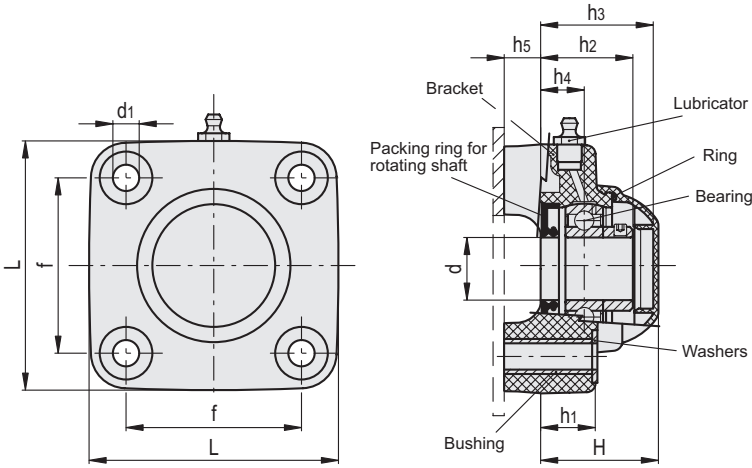

UCF-S-T

Code	Description	d	d1	H	L	f	h1	h2	h3	h4	h5	Bearing static load [N]	Bearing dynamic load [N]	Bracket load [N]	⚖
419451	UCF.205-S-A-25-T-C55	25	10.5	49.5	99.5	70	22	36.9	47	17.4	15	7800	14000	17000	517
419461	UCF.206-S-A-30-T-C55	30	10.5	55.7	113	83	26	41	53.2	20	15	11300	19500	17500	720

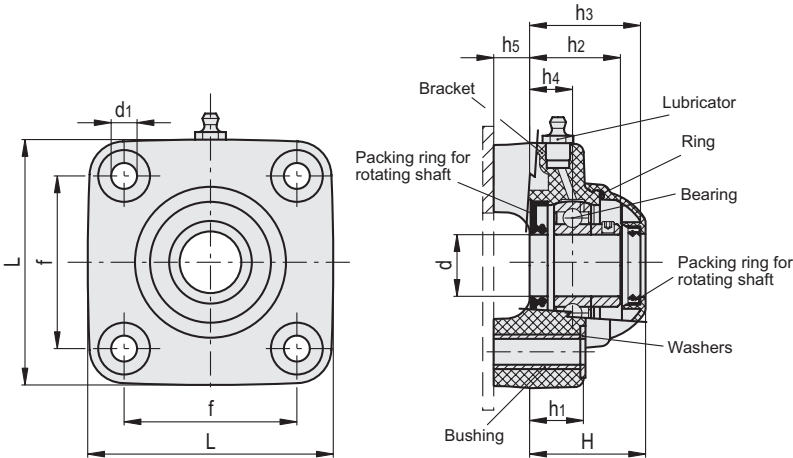

UCF-S-P

Code	Description	d	d1	H	L	f	h1	h2	h3	h4	h5	Bearing static load [N]	Bearing dynamic load [N]	Bracket load [N]	⚖
419401	UCF.205-S-A-25-P-C55	25	10.5	49.5	99.5	70	22	36.9	47	17.4	15	7800	14000	17000	530
419411	UCF.206-S-A-30-P-C55	30	10.5	55.7	113	83	26	41	53.2	20	15	11300	19500	17500	733