

MATERIAL

Polyamide based (PA) technopolymer, natural colour.

FEATURES AND APPLICATIONS

The wing nut screw is similar in shape and size to that specified in DIN 316 and requires no tools for tightening.

It is made entirely from insulating material that is resistant to corrosion and chemicals. It is suitable for applications in industry, aeronautics and electronics, and in all cases where weight reduction is required.

The product is tested for mechanical and dimensional performance. Slight colour variations are perfectly normal and do not affect the quality of the product.

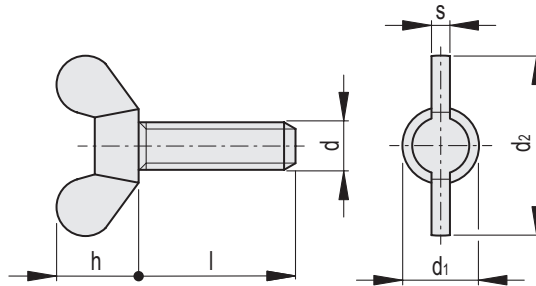
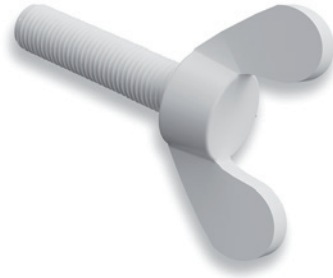

Code	Description	d	d1	d2	l	s	h	Maximum tightening torque [Nm]	⚖️
504301	SRD.316-M4X10-TP-N	M4	8	17.5	10	1.5	8.5	0.15	1
504302	SRD.316-M4X16-TP-N	M4	8	17.5	16	1.5	8.5	0.15	1
504303	SRD.316-M4X20-TP-N	M4	8	17.5	20	1.5	8.5	0.15	1
504304	SRD.316-M4X25-TP-N	M4	8	17.5	25	1.5	8.5	0.15	1
504311	SRD.316-M5X16-TP-N	M5	10.5	22.5	16	2	11	0.25	1
504312	SRD.316-M5X20-TP-N	M5	10.5	22.5	20	2	11	0.25	1
504313	SRD.316-M5X25-TP-N	M5	10.5	22.5	25	2	11	0.25	1.5
504314	SRD.316-M5X30-TP-N	M5	10.5	22.5	30	2	11	0.25	1.5
504315	SRD.316-M5X40-TP-N	M5	10.5	22.5	40	2	11	0.25	2
504316	SRD.316-M5X50-TP-N	M5	10.5	22.5	50	2	11	0.25	2.5
504321	SRD.316-M6X16-TP-N	M6	12.5	28	16	2.5	13.5	0.5	1.5
504322	SRD.316-M6X20-TP-N	M6	12.5	28	20	2.5	13.5	0.5	1.5
504323	SRD.316-M6X25-TP-N	M6	12.5	28	25	2.5	13.5	0.5	2
504324	SRD.316-M6X30-TP-N	M6	12.5	28	30	2.5	13.5	0.5	2
504325	SRD.316-M6X40-TP-N	M6	12.5	28	40	2.5	13.5	0.5	2.5
504326	SRD.316-M6X50-TP-N	M6	12.5	28	50	2.5	13.5	0.5	3
504331	SRD.316-M8X20-TP-N	M8	14	30.5	20	3	15	1.9	2
504332	SRD.316-M8X25-TP-N	M8	14	30.5	25	3	15	1.9	2.5
504333	SRD.316-M8X30-TP-N	M8	14	30.5	30	3	15	1.9	3
504334	SRD.316-M8X40-TP-N	M8	14	30.5	40	3	15	1.9	3.5
504335	SRD.316-M8X50-TP-N	M8	14	30.5	50	3	15	1.9	4.5
504341	SRD.316-M10X20-TP-N	M10	16.5	36	20	3.5	17.5	3	3.5
504342	SRD.316-M10X25-TP-N	M10	16.5	36	25	3.5	17.5	3	4
504343	SRD.316-M10X30-TP-N	M10	16.5	36	30	3.5	17.5	3	4.5
504344	SRD.316-M10X40-TP-N	M10	16.5	36	40	3.5	17.5	3	5.5
504345	SRD.316-M10X50-TP-N	M10	16.5	36	50	3.5	17.5	3	6.5
504346	SRD.316-M10X60-TP-N	M10	16.5	36	60	3.5	17.5	3	8
504351	SRD.316-M12X20-TP-N	M12	16.5	36	20	3.5	17.5	3	5.5
504352	SRD.316-M12X30-TP-N	M12	16.5	36	25	3.5	17.5	3	6.5
504353	SRD.316-M12X40-TP-N	M12	16.5	36	30	3.5	17.5	3	8
504354	SRD.316-M12X50-TP-N	M12	16.5	36	40	3.5	17.5	3	9.5
504355	SRD.316-M12X60-TP-N	M12	16.5	36	50	3.5	17.5	3	11
504356	SRD.316-M12X80-TP-N	M12	16.5	36	60	3.5	17.5	3	13