

- 1
- 2
- 3
- 4
- 5
- 6
- 7
- 8
- 9
- 10
- 11
- 12
- 13
- 14
- 15
- 16
- 17
- 18
- 19

WHEEL BODY

Phenolic based (PF) Duroplast, resistant to temperatures up to 300°C.  
Hub with pass-through hole.

APPLICATIONS

Being resistant to high temperatures, RE.F7-HT castor is particularly suitable for use in food industries and cooking ovens, especially in the baking sector.

ACCESSORIES ON REQUEST

For mounting, we recommend using axles AXL.F7 (see page -).



Traction force or thrust for wheel movement [N]			
		Load [N]	
		1000	2000
D [mm]	80	40	-
	100	37	82

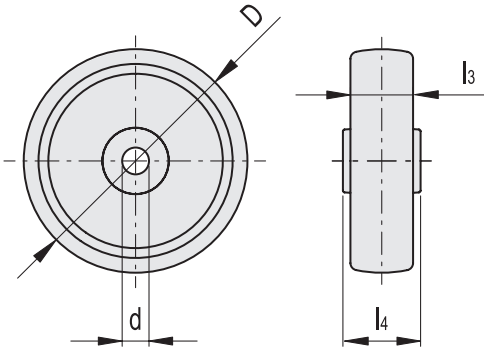

Code	Description	D	d	l3	l4	Static load# [N]	Rolling resistance# [N]	Dynamic carrying capacity# [N]	⚖
448531	RE.F7-080-RBL-HT	80	12	35	39	2500	1250	1500	180
448533	RE.F7-100-RBL-HT	100	12	35	44	3000	1300	2000	300

# For static load, rolling resistance and dynamic carrying capacity see Technical data (on page 1296).