



**STANDARD EXECUTIONS**

- **DVB.7:** bushing with threaded blind hole and base plate in polished zinc-plated steel, vibration-damper body in natural rubber NR, black colour, hardness 40, 55, 70 Shore A  $\pm 5$ .
- **DVB.7-SST:** bushing with threaded blind hole and base plate in AISI 304 stainless steel, vibration-damper body in natural rubber NR, black colour, hardness 55 Shore A  $\pm 5$ .

**FEATURES AND APPLICATIONS**

DVB. rubber buffers have been designed to damp vibrations, shocks and noises produced by moving bodies or non-balanced vibrating masses of equipment and machines.

DVB elements are generally used as a bumper or as a limit stop for the absorption of vibrations.

Vibrations can cause:

- malfunctioning and reduction of the machine lifespan and/or of the adjacent ones;
- damage to operator's health;
- noise.

Load diagrams for each single code are available on request. See Technical data and guidelines for the choice(on page ).

**SPECIAL EXECUTIONS ON REQUEST**

Natural rubber NR, hardness 40, 70 Shore A  $\pm 5$  for the executions with AISI 304 stainless steel base.



DVB.7

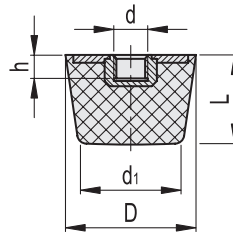

DVB.7 -20-17-M5-55  
 D L d Shore A

Description	D	L	d	d <sub>1</sub>	h	⚖	Hardness 40 Shore A			Hardness 55 Shore A			Hardness 70 Shore A					
							Code	Max load [N]	Max. deflection [mm]	Stiffness [N/mm]	Code	Max load [N]	Max. deflection [mm]	Stiffness [N/mm]	Code	Max load [N]	Max. deflection [mm]	Stiffness [N/mm]
DVB.7-20-17-M5*	20	17	M5	10	5	12	432301	207	4.25	49	432101	253	4.25	60	432501	311	4.25	73
DVB.7-20-17-M6*	20	17	M6	10	6	18	432302	207	4.25	49	432102	253	4.25	60	432502	311	4.25	73
DVB.7-25-17-M6*	25	17	M6	19	6	22	432303	289	4.25	68	432103	358	4.25	84	432503	454	4.25	107
DVB.7-25-20-M6*	25	20	M6	16	7	14	432304	286	5	57	432104	617	5	123	432504	802	5	160
DVB.7-32-22-M8*	32	22	M8	24	8	33	432311	411	5.5	75	432111	506	5.5	92	432511	673	5.5	122
DVB.7-32-26-M8*	32	26	M8	21	9	23	432313	538	6.5	82	432113	770	6.5	118	432513	1470	6.5	226
DVB.7-38-32-M8*	38	32	M8	24	10	23	432315	613	8	76	432115	990	8	123	432515	1738	8	217
DVB.7-38-32-M10*	38	32	M10	24	10	23	432317	613	8	76	432117	990	8	123	432517	1738	8	217
DVB.7-38-35-M8*	38	35	M8	30	8	46	432321	604	8.75	69	432121	893	8.75	102	432521	1104	8.75	126
DVB.7-38-35-M10*	38	35	M10	30	10	56	432331	604	8.75	69	432131	893	8.75	102	432531	1104	8.75	126
DVB.7-43-50-M10*	43	50	M10	30	10	72	432341	1327	12.5	106	432141	2011	12.5	161	432541	3027	12.5	242
DVB.7-50-20-M10*	50	20	M10	40	10	61	432351	2763	5	553	432151	3570	5	714	432551	4875	5	975
DVB.7-50-43-M10*	50	43	M10	32	11	88	432356	930	10.75	86	432156	1530	10.75	142	432556	2359	10.75	219
DVB.7-60-40-M10*	60	40	M10	40	10	93	432361	1685	10	169	432161	2101	10	210	432561	3231	10	323

DVB.7-SST

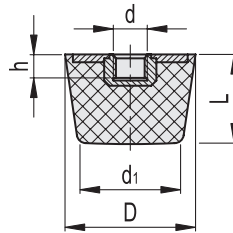

DVB.7 -20-17-SST-M5-55  
 D L Stainless steel d Shore A

INOX STAINLESS STEEL

Description	D	L	d	d <sub>1</sub>	h	⚖	Hardness 40 Shore A			Hardness 55 Shore A			Hardness 70 Shore A					
							Code	Max load [N]	Max. deflection [mm]	Stiffness [N/mm]	Code	Max load [N]	Max. deflection [mm]	Stiffness [N/mm]	Code	Max load [N]	Max. deflection [mm]	Stiffness [N/mm]
DVB.7-20-17-SST-M5-55	20	17	M5	10	5	12		207	4.25	49	432701	253	4.25	60		311	4.25	73
DVB.7-20-17-SST-M6-55	20	17	M6	10	6	18		207	4.25	49	432702	253	4.25	60		311	4.25	73
DVB.7-25-17-SST-M6-55	25	17	M6	19	6	22		289	4.25	68	432703	358	4.25	84		454	4.25	107
DVB.7-25-20-SST-M6-55	25	20	M6	16	7	14		286	5	57	432704	617	5	123		802	5	160
DVB.7-32-22-SST-M8-55	32	22	M8	24	8	33		411	5.5	75	432711	506	5.5	92		673	5.5	122
DVB.7-32-26-SST-M8-55	32	26	M8	21	9	25		538	6.5	82	432713	770	6.5	118		1470	6.5	226
DVB.7-38-32-SST-M8-55	38	32	M8	24	10	42		613	8	76	432715	990	8	123		1738	8	217
DVB.7-38-32-SST-M10-55	38	32	M10	24	10	42		613	8	76	432735	990	8	123		1738	8	217
DVB.7-38-35-SST-M8-55	38	35	M8	30	8	46		604	8.75	69	432721	893	8.75	102		1104	8.75	126
DVB.7-38-35-SST-M10-55	38	35	M10	30	10	56		604	8.75	69	432731	893	8.75	102		1104	8.75	126
DVB.7-43-50-SST-M10-55	43	50	M10	30	10	72		1327	12.5	106	432741	2011	12.5	161		3027	12.5	242
DVB.7-50-20-SST-M10-55	50	20	M10	40	10	61		2763	5	553	432751	3570	5	714		4875	5	975
DVB.7-50-43-SST-M10-55	50	43	M10	32	11	83		930	10.75	86	432756	1530	10.75	142		2359	10.75	219
DVB.7-60-40-SST-M10-55	60	40	M10	40	10	93		1685	10	169	432761	2101	10	210		3231	10	323



Vibration damping elements