

- 1
 - 2
 - 3
 - 4
 - 5
 - 6
 - 7
 - 8
 - 9
 - 10
 - 11
 - 12
 - 13
 - 14
 - 15
 - 16
 - 17
 - 18
 - 19
- Accessories for hydraulic systems

MATERIAL

Polypropylene-based (PP) technopolymer, high UV resistance, RAL 9005 black colour.

STANDARD EXECUTION

Two fastening holes for cylindrical-head or hexagon-head screws.

WORKING TEMPERATURE

From -30 °C to +90 °C.

FEATURES AND APPLICATIONS

The heavy-duty series tube clamp, in accordance with DIN 3015-2, allows rigid pipes tubes to be secured and a tube system (for liquids or gases) to be created.

In particular, the DIN regulation defines specific reference groups based on the overall dimensions of the collar bodies.

The table shows the correspondence between the DIN 3015-2 group and the corresponding DCE-H group.

They are used in heavy industrial hydraulics for the construction of hydraulic and oil-hydraulic systems where high mechanical strength and effective vibration and noise reduction are required.

They are used in the rail and navel sectors, on offshore and onshore platforms. Tube clamps technical data.

EXECUTIONS ON REQUEST

- Clamps for tubes with different diameters.
- Various materials and colours.

ACCESSORIES

For the assembly kit DCK-H.

- DCE-PU: cover plates.
- DCE-PL: welded lower plates.
- DCE-SRC: cylinder head screws.
- DCE-SRE: hexagon head screws.
- DCE-GU: mounting guides.
- DCE-NTG: nuts for mounting guides.



Correspondence between the DIN 3015-2 group and the DCE-H group

DIN 3015-2 group	1	2	3	4	5
DCE-H group	1	2	3	4	5

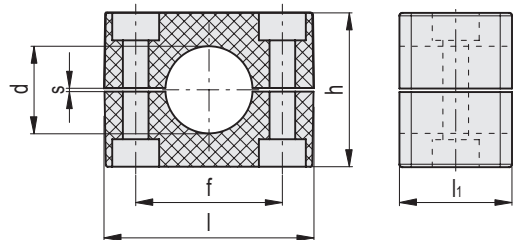

Code	Description	Group	d	d Tube [GAS]	f	l	l1	h	s	Fastening with screws Metric	Fastening with screws UNC	⚖
570221-C9	DCE-H-1-8-PP-C9	1	8	-	33	56	30	33	1	M 10	3/8-16	15
570223-C9	DCE-H-1-9,5-PP-C9	1	9.5	3/8	33	56	30	33	1	M 10	3/8-16	16
570225-C9	DCE-H-1-10-PP-C9	1	10	-	33	56	30	33	1	M 10	3/8-16	15
570227-C9	DCE-H-1-12-PP-C9	1	12	-	33	56	30	33	1	M 10	3/8-16	13
570229-C9	DCE-H-1-12.7-PP-C9	1	12.7	1/2	33	56	30	33	1	M 10	3/8-16	15
570231-C9	DCE-H-1-15-PP-C9	1	15	-	33	56	30	33	1	M 10	3/8-16	14
570233-C9	DCE-H-1-16-PP-C9	1	16	5/8	33	56	30	33	1	M 10	3/8-16	13
570235-C9	DCE-H-1-18-PP-C9	1	18	-	33	56	30	33	1	M 10	3/8-16	12
570237-C9	DCE-H-1-19-PP-C9	1	19	3/4	33	56	30	33	1	M 10	3/8-16	14
570239-C9	DCE-H-1-20-PP-C9	1	20	-	33	56	30	33	1	M 10	3/8-16	13
570251-C9	DCE-H-2-19-PP-C9	2	19	3/4	45	70	30	49	1	M 10	3/8-16	29
570253-C9	DCE-H-2-20-PP-C9	2	20	-	45	70	30	49	1	M 10	3/8-16	23
570255-C9	DCE-H-2-21.3-PP-C9	2	21.3	-	45	70	30	49	1	M 10	3/8-16	22
570257-C9	DCE-H-2-22-PP-C9	2	22	7/8	45	70	30	49	1	M 10	3/8-16	22
570259-C9	DCE-H-2-25-PP-C9	2	25	-	45	70	30	49	1	M 10	3/8-16	21
570261-C9	DCE-H-2-25.4-PP-C9	2	25.4	1	45	70	30	49	1	M 10	3/8-16	27
570263-C9	DCE-H-2-26.9-PP-C9	2	26.9	-	45	70	30	49	1	M 10	3/8-16	21
570265-C9	DCE-H-2-28-PP-C9	2	28	-	45	70	30	49	1	M 10	3/8-16	20
570267-C9	DCE-H-2-30-PP-C9	2	30	-	45	70	30	49	1	M 10	3/8-16	25
570281-C9	DCE-H-3-30-PP-C9	3	30	-	60	85	30	60	1.2	M 10	3/8-16	33
570283-C9	DCE-H-3-32-PP-C9	3	32	1 1/4	60	85	30	60	1.2	M 10	3/8-16	32
570285-C9	DCE-H-3-33.7-PP-C9	3	33.7	-	60	85	30	60	1.2	M 10	3/8-16	31
570287-C9	DCE-H-3-35-PP-C9	3	35	-	60	85	30	60	1.2	M 10	3/8-16	31
570289-C9	DCE-H-3-36-PP-C9	3	36	-	60	85	30	60	1.2	M 10	3/8-16	37
570291-C9	DCE-H-3-38-PP-C9	3	38	1 1/2	60	85	30	60	1.2	M 10	3/8-16	29
570293-C9	DCE-H-3-40-PP-C9	3	40	-	60	85	30	60	1.2	M 10	3/8-16	29
570295-C9	DCE-H-3-42.4-PP-C9	3	42.4	-	60	85	30	60	1.2	M 10	3/8-16	28
570297-C9	DCE-H-3-45-PP-C9	3	45	-	60	85	30	60	1.2	M 10	3/8-16	26
570311-C9	DCE-H-4-38-PP-C9	4	38	1 1/2	90	116	45	88	2	M 12	1/2-13	106
570313-C9	DCE-H-4-48.3-PP-C9	4	48.3	-	90	116	45	88	2	M 12	1/2-13	96
570315-C9	DCE-H-4-50-PP-C9	4	50	-	90	116	45	88	2	M 12	1/2-13	95
570317-C9	DCE-H-4-50.8-PP-C9	4	50.8	2	90	116	45	88	2	M 12	1/2-13	95
570319-C9	DCE-H-4-54-PP-C9	4	54	-	90	116	45	88	2	M 12	1/2-13	93
570321-C9	DCE-H-4-60.3-PP-C9	4	60.3	-	90	116	45	88	2	M 12	1/2-13	87
570331-C9	DCE-H-5-76.1-PP-C9	5	76.1	-	122	155	60	118	2	M 16	5/8-11	193
570333-C9	DCE-H-5-88.9-PP-C9	5	88.9	-	122	155	60	118	2	M 16	5/8-11	171