

MATERIAL

Glass-fibre reinforced polyamide based (PA) SUPER-technopolymer, black colour, matte finish.

ROTATING PIN

Self-lubricating glass-fibre reinforced polyamide based (PA) technopolymer, black colour, matte finish.

STANDARD EXECUTIONS

- **CFM-PCN-SH**: pass-through holes for countersunk head screws.
- **CFM-PCN-B**: brass bushings with threaded blind hole.

ROTATION ANGLE (APPROXIMATE VALUE)

Max 245° (-65° and +180° being 0° the condition where the two inter-connected surfaces are on the same plane), see Fig.1.

Do not exceed the rotation angle limit so as not to prejudice the hinge mechanical performance.

To choose the convenient type and the right number of hinges for your application, see the Guidelines (see page 952).

FEATURES AND APPLICATIONS

The compact size makes the product easy to install.

The CFM-PCN hinge can be combined with the hinge with integrated electric cable CFM-PC.



Fig.1

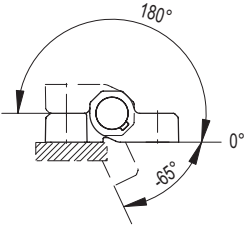

| Axial Stress | | | Radial Stress | | 90° Angled Stress | |
|------------------|-----------------------------|-------------------------|-----------------------------|-------------------------|------------------------------|--------------------------|
| Resistance tests | | | | | | |
| Description | Maximum working load Ea [N] | Load at breakage Ra [N] | Maximum working load Er [N] | Load at breakage Rr [N] | Maximum working load E90 [N] | Load at breakage R90 [N] |
| CFM.PCN-SH | 900 | 2300 | 1100 | 3700 | 1200 | 3500 |
| CFM.PCN-B | 1500 | 2700 | 1000 | 3400 | 1000 | 2600 |

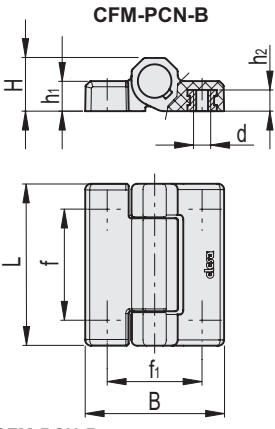
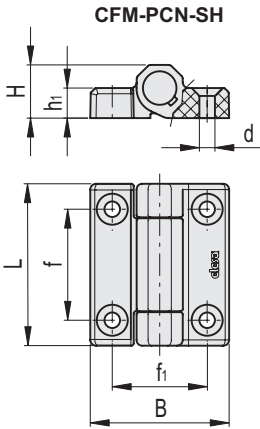

CFM-PCN-SH

| Code | Description | L | B | f±0.25 | f1±0.25 | H | h1 | d | C# [Nm] | △ |
|--------|-----------------|----|----|--------|---------|----|----|-----|---------|----|
| 424681 | CFM-PCN.70 SH-6 | 70 | 60 | 48 | 41 | 23 | 13 | 6.3 | 7 | 67 |

CFM-PCN-B

| Code | Description | L | B | f±0.25 | f1±0.25 | H | h1 | h2 | d | C# [Nm] | △ |
|--------|-----------------|----|----|--------|---------|----|----|----|----|---------|----|
| 424691 | CFM-PCN.70 B-M6 | 70 | 60 | 48 | 41 | 23 | 13 | 5 | M6 | 8 | 82 |

Suggested tightening torque for assembly screws.